

OREGON CORNER RESTORATION FORM

COUNTY: Umatilla. DATE: 03/06/20.

CORNER DESIGNATION: L-5, The East One-Quarter corner of Section 18, Township 1 North, Range 31 East, W.M.

PREVIOUS RENEWALS/SURVEYS ETC: Corner was originally established by Josiah A. Burnett under Contract No. 92 dated September 12, 1860. Notes state: Set a post for 1/4 Sec. Cor., drove charred stake and raised mound with trench as per instructions.

MONUMENT AND ACCESSORIES FOUND: None. Reestablished corner position by single proportion measurement between the Northeast and Southeast corners of Section 18. Corner falls in previously farmed area, presently in old CRP field.

MONUMENT MARKING DETAIL:

T1N R31E
1/4
S18|S17
2020
54657PLS

MONUMENT SET: At reestablished corner point, set a 5/8 by 24" pointed rebar 24" in the ground and capped with a 2" aluminum cap marked as shown in Monument Marking Detail.
Sect a steel fence post 1 1/2' South of corner with Witness sign attached.

New accessories:

- A silver Deep-1 magnet bears N 10° E, 30.1'.
- A purple Deep-1 magnet bears S 74° E, 24.2'.
- A silver Deep-1 magnet bears S 20° W, 27.8'.
- A silver Deep-1 magnet bears N 71° W, 23.7'.

Buried bearing object signs with the Deep-1 magnets which are buried 18" below ground line. Measured to accessories with a steel tape and Brunton pocket transit with 14° East declination.

LOCATION AND COMMENTS: Corner is located on a East facing hillside about 150' feet North of a range fence on the North side of CRP field. The corner area has been previously farmed and is in old CRP.

OREGON STATE PLANE COORDINATE, North Zone NAD 83(91), International Feet Units:

N: 696283.86
E: 8592897.76

FIRM: Wells Surveying
P.O. Box 1696
Pendleton, OR 97801

Surveyor's Seal

\1N31L-5

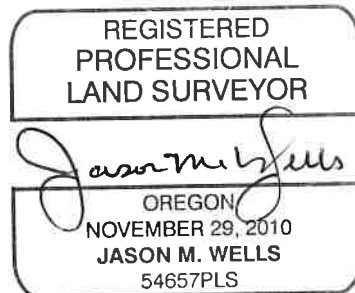

RENEWS: 6/30/20