

OREGON CORNER RESTORATION FORM

COUNTY: Umatilla. DATE: 02/27/20.

CORNER DESIGNATION: L-21, The East One-Quarter corner of Section 14, Township 1 North, Range 31 East, W.M.

PREVIOUS RENEWALS/SURVEYS ETC: Corner was originally established by Josiah A. Burnett under contract No. 92 dated September 12, 1860. Notes state: Set post for 1/4 sec.cor. , drove charred stake and raised mound with trench as per instructions.

MONUMENT AND ACCESSORIES FOUND: None. Reestablished this corner at midway latitude between the Northeast and Southeast corners of Section 14 holding existing North-South fence line for departure.

MONUMENT MARKING DETAIL:

T1N R31E
1/4
S14|S13
2020
54657PLS

MONUMENT SET: At reestablished corner position, set a 2 1/2" brass cap on 1/1/4 by 30" galvanized iron pipe 28" in the ground. Cap is marked as shown in Monument Marking Detail.

New accessories:

A 5/8 by 24" rebar with blue plastic cap marked "Wells Surveying 54657PLS" bears N 01°13' W, 31.0'.
A 5/8 by 24" rebar with blue plastic cap marked "Wells Surveying 54657PLS" bears N 01°27' W, 16.4'.
A 5/8 by 24" rebar with blue plastic cap marked "Wells Surveying 54657PLS" bears S 01°14' E, 18.7'.
A 5/8 by 24" rebar with blue plastic cap marked "Wells Surveying 54657PLS" bears S 01°01' E, 32.3'.
Wired bearing object signs to rebar accessories. Wired Witness sign to existing steel fence post in North-South fence line 3' North of corner monument.
Bearings to corner accessories are State Plane Grid bearings.

LOCATION AND COMMENTS: Corner is located in a North-South fence line.

OREGON STATE PLANE COORDINATE, North Zone NAD 83(91), International Feet Units:

N: 696587.74
E: 8613906.75

FIRM: Wells Surveying
P.O. Box 1696
Pendleton, OR 97801

Surveyor's Seal

\1N31L-21

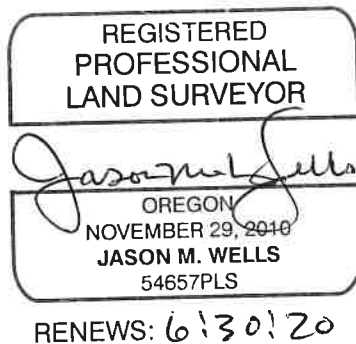

20-043-C