

**OREGON CORNER RESTORATION FORM**

COUNTY: Umatilla. DATE: 03/06/20.

CORNER DESIGNATION: J-7, The South One-Quarter corner of Section 8, Township 1 North, Range 31 East, W.M.

PREVIOUS RENEWALS/SURVEYS ETC: Corner was originally established by Josiah A. Burnett under contract No. 92 dated September 12, 1860. Notes state: Set a post for 1/4 Sec. Cor., drove charred stake and raised mound with trench as per instructions. We find a loose 16 by 10 by 4" stone of unknown origin lying 20 feet downhill (North) of corner point, marked "1/4".

MONUMENT AND ACCESSORIES FOUND: Found a loose 16 by 10 by 4" stone of unknown origin, marked "1/4" lying loose North of the corner point but it's original position could not be determined. Reestablished corner point on the parallel of latitude by single proportion measure between the Southeast and Southwest corners of Section 8, holding the old existing fence line along the West line of the East Half of the East Half of Section 17 for departure.

MONUMENT MARKING DETAIL:

T1N R31E  
S8  
1/4 -----  
S17  
2020  
54657PLS

MONUMENT SET: At the reestablished corner point, set a 2 1/2" brass cap on 1 1/4 by 30" galvanized iron pipe 30" in the ground and surrounded with a few stones. Placed the found marked stone on South side of corner monument. Cap is marked as shown in the Monument Marking Detail.

New accessories:

- A silver Deep-1 magnet bears N 56°40' E, 27.2'.
- A purple Deep-1 magnet bears S 32°22' E, 31.8'.
- A blue Deep-1 magnet bears S 43°53' W, 26.5'.
- A orange Deep-1 magnet bears N 28°53' W, 24.9'.

Buried bearing object signs with the Deep-1 magnets, which are buried 18" below ground line. Set a steel fence post 2' South of corner monument with Witness sign attached. Bearings to accessories are State Plane Grid bearings.

LOCATION AND COMMENTS: Corner is located in pasture land, on a North facing steep slope. The corner area may have been farmed in past years.

OREGON STATE PLANE COORDINATE, North Zone NAD 83(91), International Feet Units:

N: 698915.10  
E: 8595474.96

FIRM: Wells Surveying  
P.O. Box 1696  
Pendleton, OR 97801

Surveyor's Seal

\1N31J-7

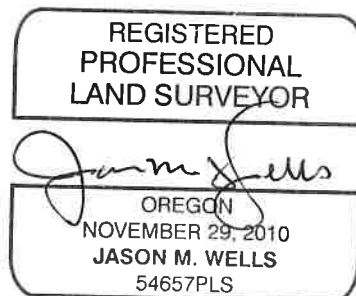

RENEWS: 6!30!20

20-043-C