

OREGON CORNER RESTORATION FORM

COUNTY: Umatilla. DATE: 04/10/20.

CORNER DESIGNATION: J-5, The Southeast corner of Section 7, Township 1 North, Range 31 East, W.M.

PREVIOUS RENEWALS/SURVEYS ETC: Corner was originally established by Josiah A. Burnett under Contract No. 92 dated September 12, 1860. Notes state: Set a post for corner to Secs. 7, 8, 17 and 18, drove charred stake and raised mound with trench as per instructions.

MONUMENT AND ACCESSORIES FOUND: None. The corner falls in an area that may have been farmed in the past but is currently a pasture. There is evidence of buildings, now torn down, North of the corner.

MONUMENT MARKING DETAIL:

T1N R31E
S7|S8

S18|S17
2020
54657PLS

MONUMENT SET: I reestablished this corner position by double proportion measure holding the Southeast corner of Section 19 and Northeast corner of Section 7 for latitude and the North One-Quarter corner of Section 17 and Northwest corner of Section 18 for departure. At the reestablished corner position, set a 2 1/2" brass cap on 1 1/4" galvanized iron pipe 28" in the ground. Set a steel fence post 2' South of corner and attached Witness sign.

Bearings to corner accessories are State Plane Grid bearings.

New accessories:

A silver Deep-1 magnet bears Grid Azimuth 44°34', 29.5'.

A purple Deep-1 magnet bears Grid Azimuth 140°42', 31.6'.

A blue Deep-1 magnet bears Grid Azimuth 239°15', 26.6'.

A orange Deep-1 magnet bears Grid Azimuth 325°04', 24.3'.

Buried bearing object signs with the Deep-1 magnets which are buried 18" below ground line.

Azimuths to corner accessories are State Plane Grid azimuths.

LOCATION AND COMMENTS: Corner is located in a pasture area about 100' West of a private farm road.

OREGON STATE PLANE COORDINATE, North Zone NAD 83(91), International Feet Units:

N: 698922.65

E: 8592851.72

FIRM: Wells Surveying
P.O. Box 1696
Pendleton, OR 97801

Surveyor's Seal

\1N31J-5

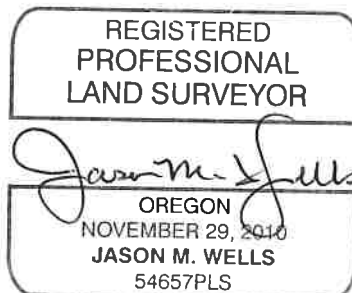

RENEWS: 6/30/20

20-043-C