

OREGON CORNER RESTORATION FORM

Section 7 Township 1N Range 32E
 County Umatilla Date: December 24, 2009

Corner Designation: 1N32J1

Corner to sections 12 and 13, T1N, R31E, and sections 7 and 18, T1N, R32E, W.M., Umatilla County, Oregon.

Condition Report Only
 Not found
 Remonumented
 Unrecorded
 Surveyed in
 Referenced out

Previous Renewals / Surveys, etc.

Corner originally set by Josiah A. Burnett under contract No. 92 dated September 12, 1860. His record reads: Set post cor. for secs. 12, 13, 7, and 18. Drove charred stake and raised mound with trench as per instructions. In the Record of Private Surveys Book 2, Page 95, Geary Kimbrell states: Set stone 25x15x14 ins.

Monument and accessories found. (condition and source)

None. There are several old rock jacks in the area indicating different fence locations.

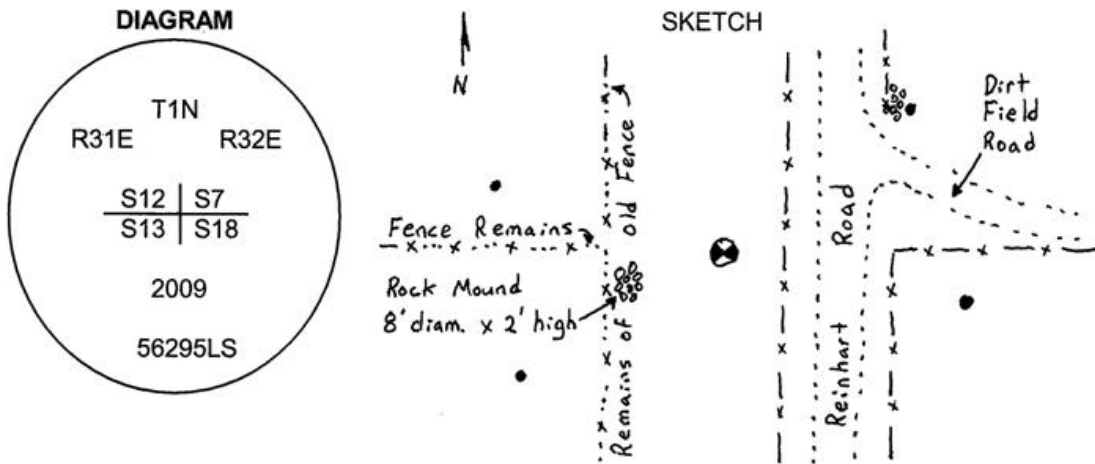

MONUMENT (S) AND ACCESSORIES SET (Procedures and Description)

Set a 2" aluminum cap on a 1" x 24" iron rebar driven into the bedrock, stamped as shown in the diagram above at the intersection of an east - west fence and the township line. I built a 2 foot diameter mound of stone around the monument.

For references, I set four, 5/8" by 24" iron rebars with 1 1/4" orange plastic caps stamped WTS and 56295LS as described below:

- an iron rebar bears N77°36'16"W, 65.58 feet;
- an iron rebar bears N28°12'20"E, 125.09 feet;
- an iron rebar bears S82°33'31"E, 105.06 feet;
- an iron rebar bears S32°19'34"W, 68.47 feet;

The monument was set and references tied using a Trimble R7/R8 RTK GPS system.

Location and comments
 NAD 83/1991 State Plane Coordinate
 Oregon North Zone
 N = 699,314.71 ift
 E = 8,619,147.94 ift

Compass Declination
 Firm / Agency
 Witness Tree Surveying
 Address
 P.O. Box G
 Pilot Rock, Or. 97868
 Party Chief
 Stephen K, Haddock

Surveyors Seal

REGISTERED
 PROFESSIONAL
 LAND SURVEYOR

Stephen K. Haddock

OREGON
 JULY 9, 2001
 STEPHEN K. HADDOCK
 56295LS

RENEWAL DATE 6-30-11

RECEIVED BY:
 Umatilla County Surveyor
 Date: 6-10
 Rec'd By: KK
 No. 10-93-C