

**OREGON CORNER RESTORATION FORM**

COUNTY: Umatilla. DATE: 04/10/20.

CORNER DESIGNATION: G-5, The East One-Quarter corner of Section 7, Township 1 North, Range 31 East, W.M.

PREVIOUS RENEWALS/SURVEYS ETC: Corner was originally established by Josiah A. Burnett under Contract No. 92 dated September 12, 1860. Notes state: Set a post for 1/4 Sec. Cor., drove charred stake and raised mound with trench as per instructions.

MONUMENT AND ACCESSORIES FOUND: None. Reestablished the corner position by single proportion measure between the Southeast and Northeast corners of Section 7.

MONUMENT MARKING DETAIL:

T1N R31E  
1/4  
S7|S8  
2020  
54657PLS

MONUMENT SET: At the reestablished corner position, set a 2 1/2" brass cap on 1 1/4 by 30" galvanized iron pipe 31" in the ground in a pastured area North of a farm road and South of a ravine. Set a steel fence post 2' North of the corner with Witness sign.

New accessories:

A 5/8 by 24" rebar with blue plastic cap marked "Wells Surveying, 54657PLS" bears Grid Azimuth 08°54', 36.5'.

A 5/8 by 24" rebar with blue plastic cap marked Wells Surveying, 54657PLS bears Grid Azimuth 84°09', 29.4'.

A 5/8 by 24" rebar with blue plastic cap marked Wells Surveying, 54657PLS bears Grid Azimuth 146°35', 40.1'.

A 5/8 by 24" rebar with blue plastic cap marked Wells Surveying, 54657PLS bears Grid Azimuth 296°01', 24.9'.

Wired bearing object signs to each of the rebar accessories.  
Azimuths to corner accessories are State Plane Grid azimuths.

LOCATION AND COMMENTS: Corner is located in a pastured area about 30' North of a farm road to an old farmstead, and South of a ravine running NW and SE.

OREGON STATE PLANE COORDINATE, North Zone NAD 83(91), International Feet Units:

N: 701561.82  
E: 8592825.22

FIRM: Wells Surveying  
P.O. Box 1696  
Pendleton, OR 97801

Surveyor's Seal

\IN31G-5

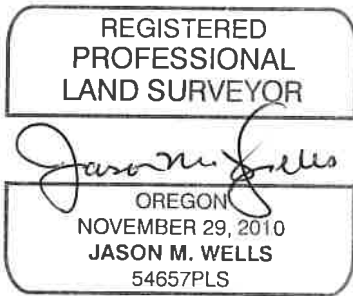

RENEWS: 6/30/20

20-043-C