

OREGON CORNER RESTORATION FORM

COUNTY: Umatilla. DATE: 03/20/20.

CORNER DESIGNATION: E-17, The South East Section corner of Section 3, Township 1 North, Range 31 East, W.M.

PREVIOUS RENEWALS/SURVEYS ETC: Corner was originally established by Josiah A. Burnett under Contract No. 92 dated September 12, 1860. Notes state: Set post for corner to Secs. 2, 3, 10, and 11, drove charred stake and raised mound with trench as per instructions. In January, 1909, John Kimbrell, County Surveyor, recovered this corner in his Survey No. 274, found in the Record of Private Survey Books. Kimbrell does not state what was recovered for the corner monument.

MONUMENT AND ACCESSORIES FOUND: None. Corner falls in farmed field which now in old CRP.

MONUMENT MARKING DETAIL:

T1N R31E
S2|S3

S10|S11
2020
54657 PLS

MONUMENT SET: Per Survey No. 274, I extend the measured bearing and distance between the recovered East 1/4 corner of Section 10 and the plow piece recovered at the North 1/16 th corner on the East line of Section 10, Northerly to reestablish the Northeast corner of Section 10. At the reestablished corner point in previously farmed area, set a 2 1/2" brass cap on 1 1/4 by 30" galvanized iron pipe, 28" in the ground. Cap is marked as shown in Monument Marking Detail. Set a steel fence post 2' North of corner and attached Witness sign.

New accessories:

A silver Deep-1 magnet bears N 30°14' E, 32.6'.

A purple Deep-1 magnet bears S 59°00' E, 37.9'.

A blue Deep-1 magnet bears S 16°39' W, 26.9'.

A orange Deep-1 magnet bears N 56°37' W, 32.4'.

Buried bearing object signs with each of the Deep-1 magnets which are buried 18" below ground line.

Bearings to corner accessories are State Plane Grid Bearings.

LOCATION AND COMMENTS: Corner is located on a North facing slope about 1000' South of a ravine bearing Northeast.

OREGON STATE PLANE COORDINATE, North Zone NAD 83(91), International Feet Units:

N: 704409.08

E: 8608526.52

FIRM: Wells Surveying
P.O. Box 1696
Pendleton, OR 97801

Surveyor's Seal

\1N31E-17

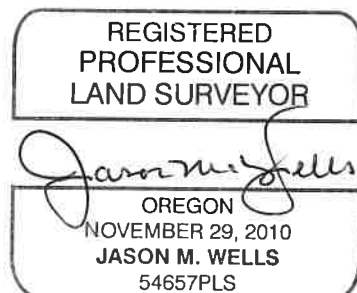

RENEWS: 6:30:20

20-043-C