

**OREGON CORNER RESTORATION FORM**

T1N R30E A1

Section 6, Township 1N, Range 30E,  
County Umatilla, Date December 7, 2004.

- Condition Report
- Not Found
- Remonumented
- Unrecorded
- Surveyed in
- Referenced out

Township corner common to Townships 1 and 2 North  
Ranges 29 and 30 East, W.M., Umatilla County, Oregon.

Previous Renewals / Surveys, etc.

The corner was originally set by David P. Thompson under Contract No. 83 dated July 22, 1859. His record Reads: Set post for corner to Townships 1 and 2 North of Ranges 29 and 30 East in mound of stone &c as per instructions.

Monument and accessories found: (Condition and source)

I found a 48" diameter mound of stones with the decayed woody remains of the post.

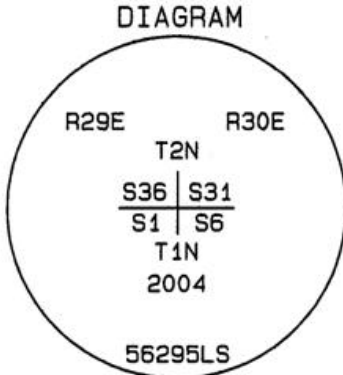

- ⊙ - Brass Cap
- - Iron Rebar Reference

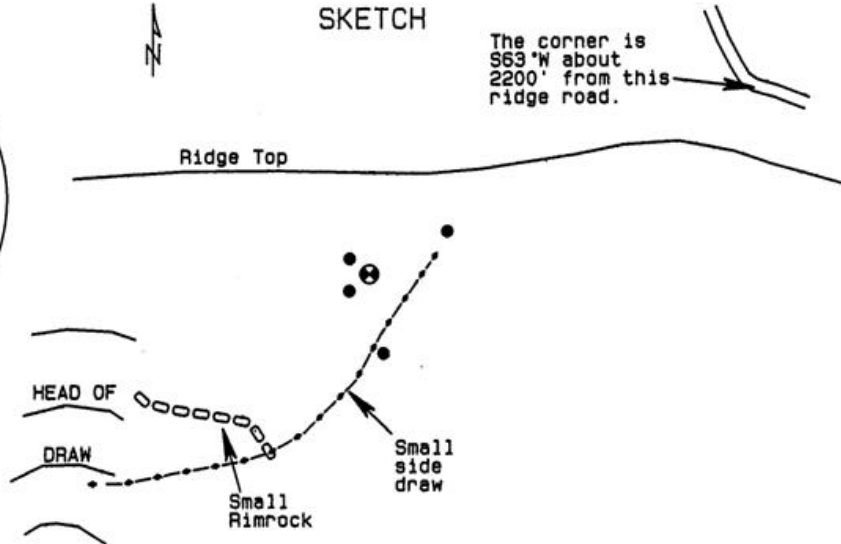

Monument and accessories set: (Procedures and description)

I set a 2 3/8" brass cap on a 30" x 1 3/8" O.D. galvanized iron pipe 30" in the ground in the mound in the decayed wood. The cap was stamped as shown in the diagram above.

For references I set four 5/8" x 24" green coated iron rebars with 1.25" orange plastic caps stamped WTS and 56295LS:

- an iron rebar bears N61°09'04"E 88.57 feet;
- an iron rebar bears N52°02'23"W 24.87 feet;
- an iron rebar bears S49°58'40"W 25.90 feet;
- an iron rebar bears S10°19'24"E 79.79 feet;

Stone mounds which appear to be sheep herder marks bear N66°27'17"W 493 feet and S5°15'53"W, 588 feet. The monument and references were tied with a Trimble R7/R8 GPS system using static surveying procedures. Bearings and distances are grid.

Location and Comments  
SPC Oregon North, NAD 83-91  
Northing = 708,950.43 ift  
Easting = 8,554,636.39 ift

Compass Declination

Surveyor's Seal

Witnessed By:  
RECEIVED BY:  
Umatilla County Surveyor  
Date: 5-05  
Rec'd By: KK  
No. 05-111-C

Firm / Agency  
Witness Tree Surveying  
P.O. Box G  
Pilot Rock, OR 97868  
Party Chief  
Stephen K. Haddock, PLS

REGISTERED  
PROFESSIONAL  
LAND SURVEYOR

*Stephen K. Haddock*

OREGON  
JULY 9, 2001  
STEPHEN K. HADDOCK  
56295LS

RENEWAL DATE 6-30-05