

T6N, R31-35

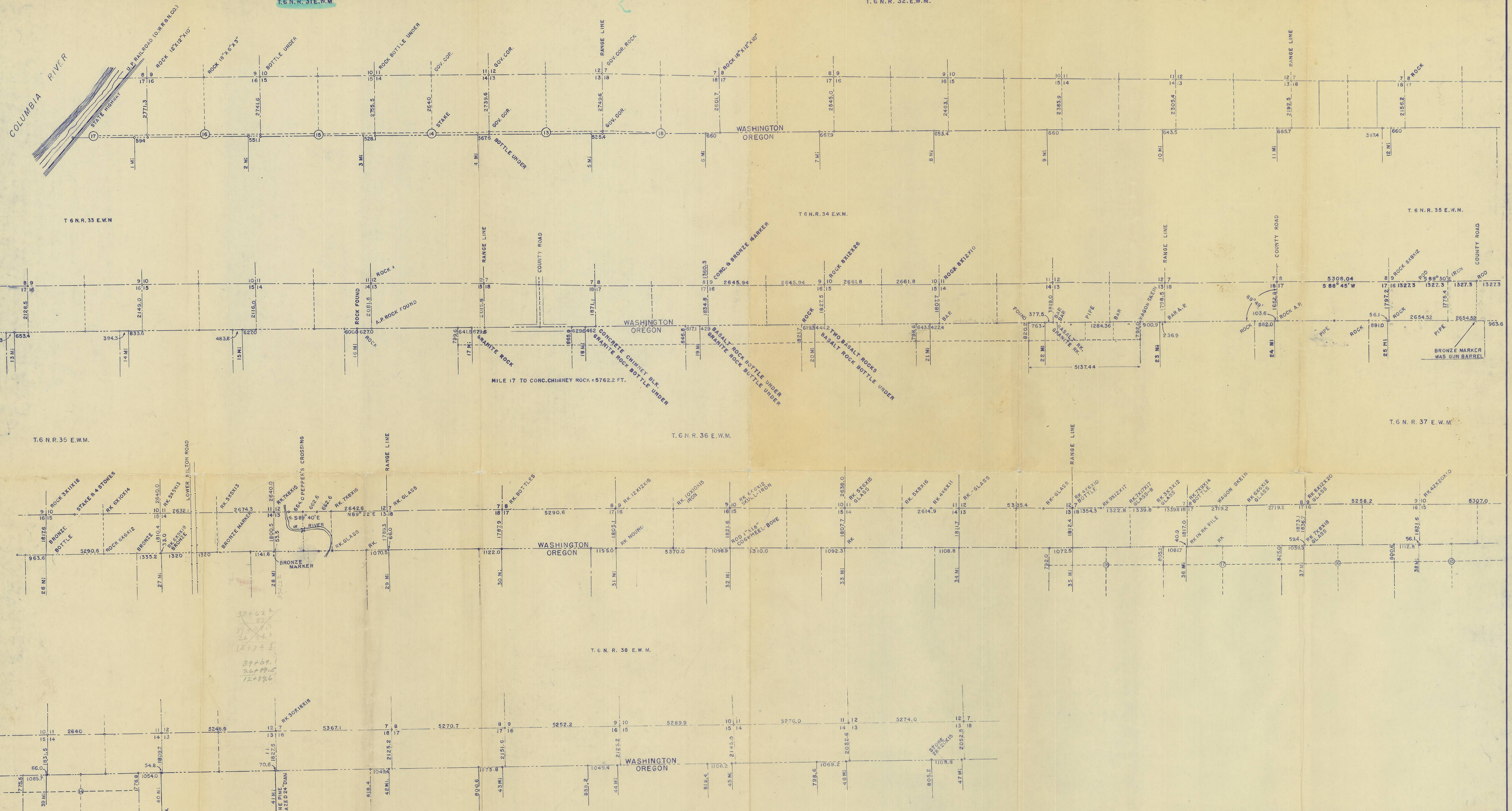

39+62
 37+74.3
 26+74.3
 12+34.8
 39+69.1
 26+79.5
 12+34.8

WASHINGTON-OREGON STATE LINE
 1955
 WALLA WALLA COUNTY
 OFFICE COUNTY ENGINEER
 WALLA WALLA, WASHINGTON
 SCALE 1 MILE = 2.6 INCHES
 APPROVED
 COUNTY ROAD ENGINEER

12-031-C