

NARRATIVE OF SURVEY

THE PURPOSE OF THIS SURVEY WAS TO MONUMENT THE SOUTHWESTERLY RIGHT-OF-WAY LINE OF THE NORTHWEST PIPELINE THROUGH PORTIONS OF SECTION 4, T1S, R35E, AND SECTIONS 29, 32 AND 33, T1N, R35E, W.M. ALSO MONUMENTED WAS THE BEGINNING AND TERMINUS POINT OF THE CATHODIC PROTECTION STATION IN THE N 1/2 NE 1/4 OF SECTION 4, T1S, R35E, W.M.

THE EXISTING 22" O.D. PIPELINE AND THE CATHODIC PROTECTION BED WERE LOCATED AND STAKED BY NORTHWEST PIPELINE CREWS IN SEPTEMBER, 1987. THE ANGLE POINTS FOR THE 22" O.D. PIPELINE WERE LOCATED ON THIS SURVEY AND THE RIGHT-OF-WAY LOCATION WAS DETERMINED BASED ON THESE ANGLE POINTS. 5/8" x 30" IRON ROD MONUMENTS WERE ESTABLISHED AS SHOWN ON THIS PLAT TO MONUMENT THE SOUTHWESTERLY PIPELINE RIGHT-OF-WAY. UNLESS OTHERWISE SHOWN, RIGHT-OF-WAY MONUMENTS ARE SET AT THE ANGLE POINTS OF THE SOUTHWESTERLY PIPELINE RIGHT-OF-WAY, OPPOSITE THE PIPELINE ANGLE POINTS. THE CENTERLINE OF THE CATHODIC PROTECTION STATION IS MONUMENTED AT THE BEGINNING AND TERMINUS POINTS AS SHOWN ON THIS MAP. THE PIPELINE AND CATHODIC PROTECTION STATION RIGHT-OF-WAYS WERE TIED TO PREVIOUSLY MONUMENTED SECTION AND QUARTER CORNERS AS SHOWN ON THIS MAP.

WHERE SECTIONS WERE NOT SUBDIVIDED BY THIS SURVEYOR, MORE OR LESS DISTANCES ARE SHOWN ALONG THE PIPELINE RIGHT-OF-WAY TO VARIOUS 1/16 TH SECTION LINES. THESE MORE OR LESS DISTANCES WERE COMPUTED BASED ON RECORD MEASUREMENTS BY OTHER SURVEYORS AND SHOULD BE REASONABLY ACCURATE. THE USE OF THESE MORE OR LESS DISTANCES HAS NO EFFECT ON THE LOCATION OF THE MONUMENTED PIPELINE RIGHT-OF-WAY.

MEASUREMENTS FOR THIS SURVEY WERE MADE WITH A 20" THEODOLITE AND INFRA-RED DISTANCE MEASURING EQUIPMENT.

LEGEND

- - SET 5/8" x 30" IRON ROD WITH 1 1/2" YELLOW PLASTIC CAP MARKED "W.R. WELLS PLS 1106". SET 6 FOOT STEEL FENCE POST NEAR IRON ROD.
- - FOUND MONUMENTS AS NOTED.

NOTES

THE PERMANENT RIGHT-OF-WAY THROUGH THE N 1/2 NE 1/4 OF SECTION 4, T1S, R35E, W.M., AND THROUGH THE NE 1/4 SW 1/4 OF SECTION 33, T1N, R35E, W.M., IS 75 FEET IN WIDTH.

THE PERMANENT RIGHT-OF-WAY THROUGH THE SW 1/4 SE 1/4, SE 1/4 SW 1/4 AND S 1/2 NW 1/4 OF SECTION 33, T1N, R35E, W.M., THROUGH THE NE 1/4 NE 1/4 OF SECTION 32, T1N, R35E, W.M., AND THROUGH THE SE 1/4 SE 1/4 OF SECTION 29, T1N, R35E, W.M., IS 60 FEET IN WIDTH.

DETAIL OF 60' AND 75' PERMANENT RIGHT-OF-WAYS.
SCALE: 1" = 50'

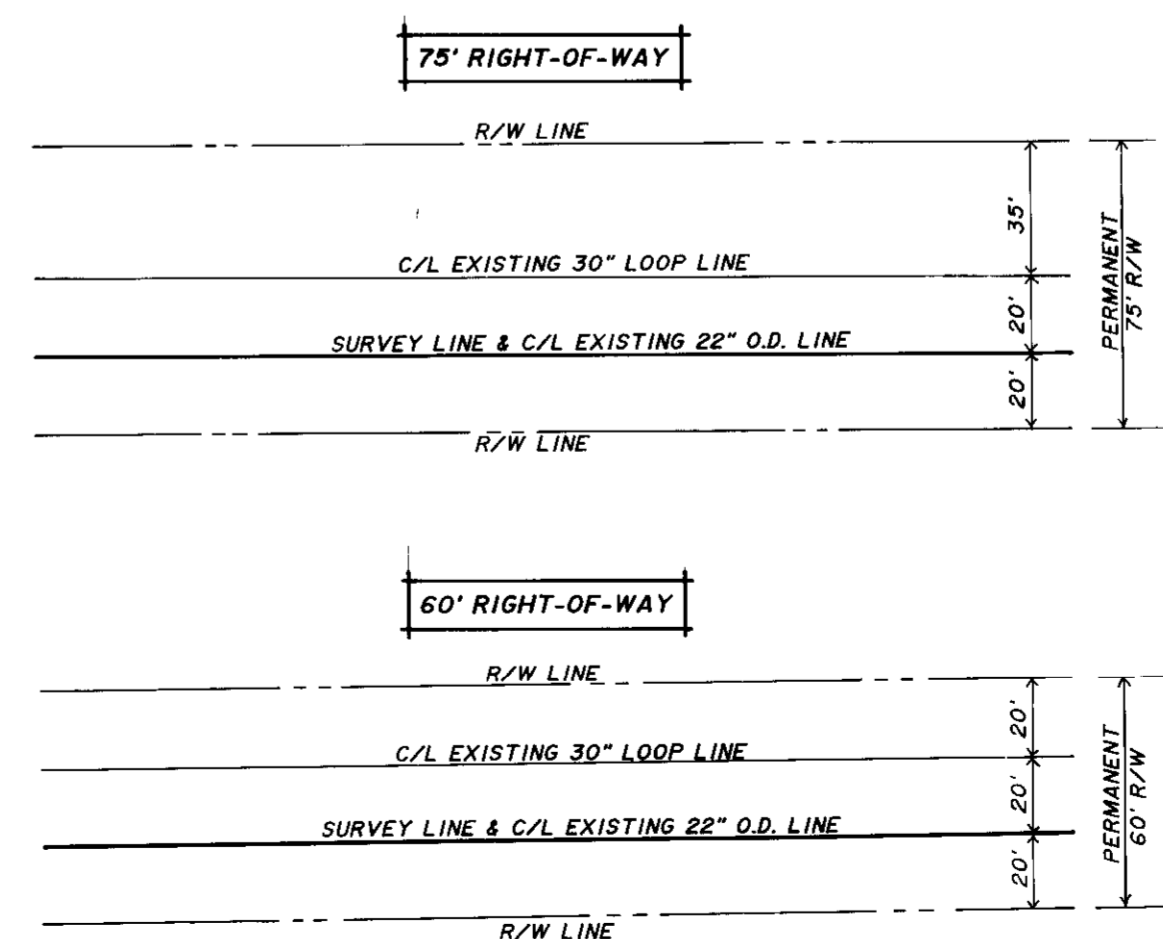

WILLIAM R. WELLS
LAND SURVEYING SERVICES
PO BOX 1696
PENDLETON, OREGON 97801
PHONE 503 276 6362

Date: 1-8-88 Dr. By: WRW
Ck. By: WRW No: 7-28

PROJECT SURVEY FOR
NORTHWEST PIPELINE CORPORATION
OF PIPELINE RIGHT-OF-WAY IN
SECTION 4, T1S, R35E, W.M., &
SECTIONS 29, 32 & 33, T1N, R35E,
W.M., UMATILLA COUNTY, OREGON.
CONTRACT NO. 258-7008.