

| TANK | CAP. GALS. |
|------|------------|
| 5 | 92493 |
| 6 | 92232 |
| 7 | 105727 |
| 8 | 448456 |
| 9 | 385945 |
| 10 | 489983 |
| 11 | 428883 |
| 12 | 432498 |
| 13 | 470904 |
| 14 | 450744 |
| 2201 | 92000 |
| 2202 | 92000 |
| 2203 | 105000 |
| 7401 | 311000 |
| 7402 | 311000 |

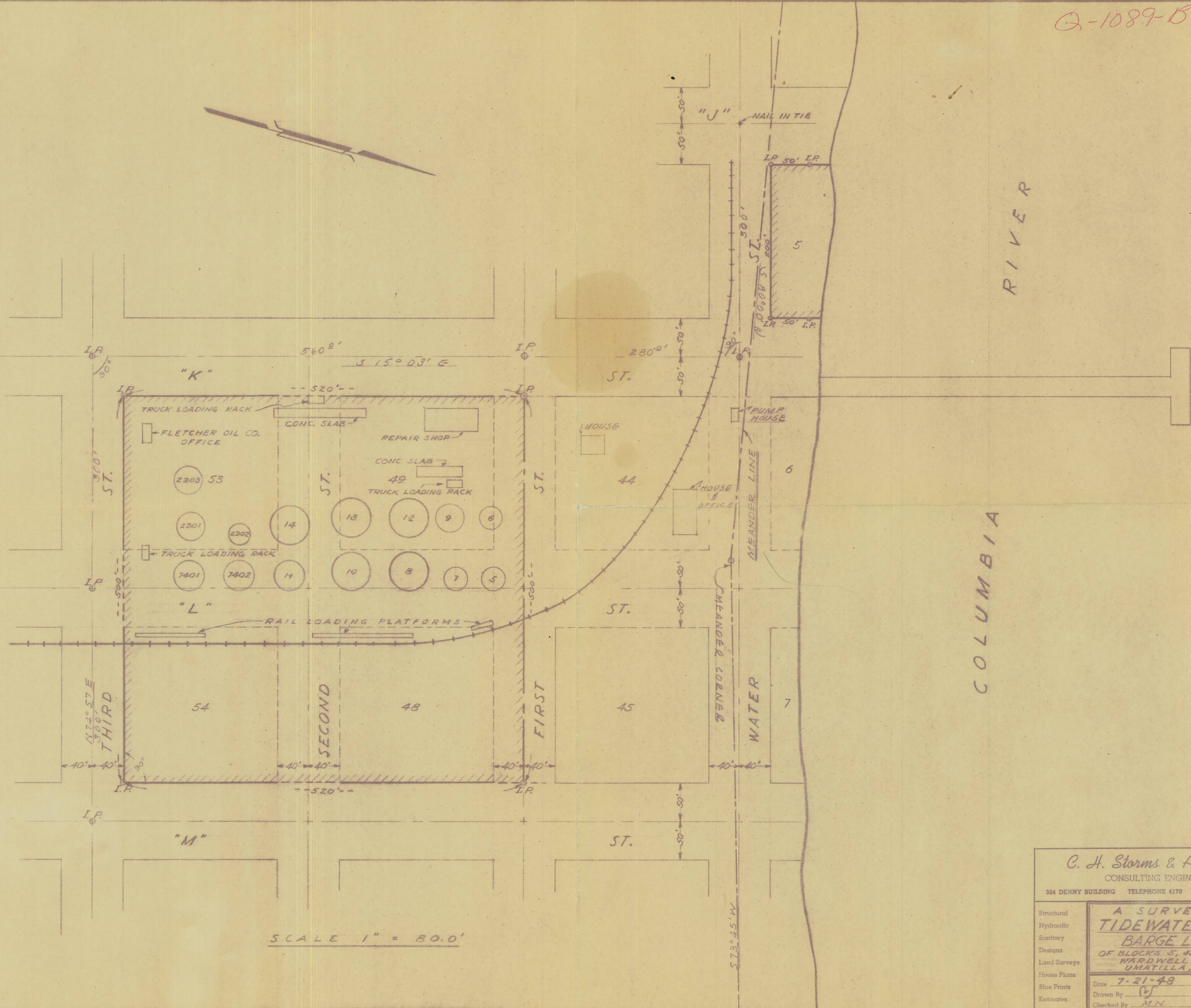

SCALE 1" = 80.0'

C. H. Storms & Associates
CONSULTING ENGINEERS
304 DENNY BUILDING TELEPHONE 4170 WALLA WALLA, WASH.

A SURVEY FOR
TIDEWATER-SHAVER
BARGE LINES
OF BLOCKS 5, 48, 49, 53, 54
WARDWELL ADDITION
UMATILLA, OREGON

Structural
Hydraulic
Sanitary
Designs
Land Surveys
House Plans
Blue Prints
Estimates

Date 7-21-48
Drawn By [Signature]
Checked By M.N.

620
SHEET 1 OF 1

Files

C. H. Storms & Associates

CIVIL ENGINEERS - DESIGNERS

TELEPHONE 4170
304 Denny Building
WALLA WALLA, WASH.

Land Surveys

Blue Prints

Estimates

Plans

Mechanical

Structural

Hydraulic

Sanitary

Designs

Land Survey Report on Blocks 48, 49, 53, 54, and Fractional Block 5 of Wardwell's Addition to the City of Umatilla, Oregon.

The following report shows the procedure used in locating the property corners of Blocks 48, 49, 53, 54, and Fractional Block 5 of Wardwell's Addition to the City of Umatilla, Oregon and that portion of adjoining streets which will be vacated at a future date; along with a plat showing the location of the Meander Line of the Columbia River as established by U.S. Government Survey, and the location of the improvements of the Tide Water Tank Farm.

Having found the established street monuments marking the point of intersection of the center-line of Third Street and the center-line of "E" Street and "J" Street respectively, I extended the center-line of Third Street, N. 74*-57'E. a distance of 300.0 feet at which point I set a 5/8 inch iron pin marking the point of intersection of the center-line of Third Street with the center-line of "K" Street. Then continuing N. 74*-57'E. a distance of 600.0 feet at which point I set a 5/8 inch iron pin marking the point of intersection of the center-line of Third Street with the center-line of "M" Street. From the iron pin marking the point of intersection of the center-line of Third Street and the center-line of "K" Street, I ran N. 15*-03'W., at right angles to the center-line of Third Street, a distance of 560.0 feet at which point I set a 5/8 inch iron pin marking the point of intersection of the center-line of "K" Street and the center-line of First Street. Continuing N. 15*-03'W. a distance of 280.0 feet at which point I set a 5/8 inch iron pin marking the point of intersection of the center-line of "K" Street and the center-line of Front or Water Street. From this iron pin I ran S. 74*-57'W., parallel to the center-line of Third Street, a distance of 300.0 feet at which point I set a nail in a railroad tie marking the point of intersection of the center-line of Front or Water Street with the centerline of "J" Street. From these established street intersections I then set the iron pins marking the property corners of the Tide Water lands as shown on the accompanying plat

C. H. Storms

C. H. Storms

Professional Engineer Res. # 2512

Q-1089-B

552

5N 28 17BA