

T. 2 N. Sec. 12
R. 31 E. Sec. 13

N. 1/4 CORNER OF
SEC. 13, T. 2 N. R. 31 E. W. M.
FD. 2" I. PIN

N. 88° 41' 25" E. - 1519.24'

10.45 x 10.5 (P.C.)

114.77'
C = N 68° 22' 45" E. - 114.56'
R = 543.12'

N. 62° 19' 31" E.
142.38'

C/L COUNTY RD. No. 799

10.40 x 10.5 (P.T.)

EXISTING FENCE

2.00 ACRES

N. 15° 39' 15" W.
288.18'

S. 15° 39' 15" E.
394.16'

C/L ABANDONED O.W.R. & N. CO.
RAILROAD GRADE

S. 88° 39' 07" W.

261.27'
S. 88° 39' 07" W.

N. 65° 30' 42" W.
251.94'

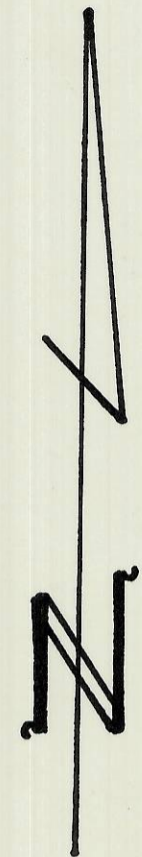

SCALE: 1" = 50'

● --- SET 1/2" DIA. OR LARGER I. PIN.

NOTE: BEARINGS BASED ON U.P.R.R. TRACK
BEING N. 60° 34' 00" E.

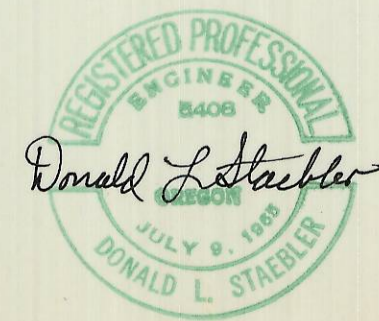
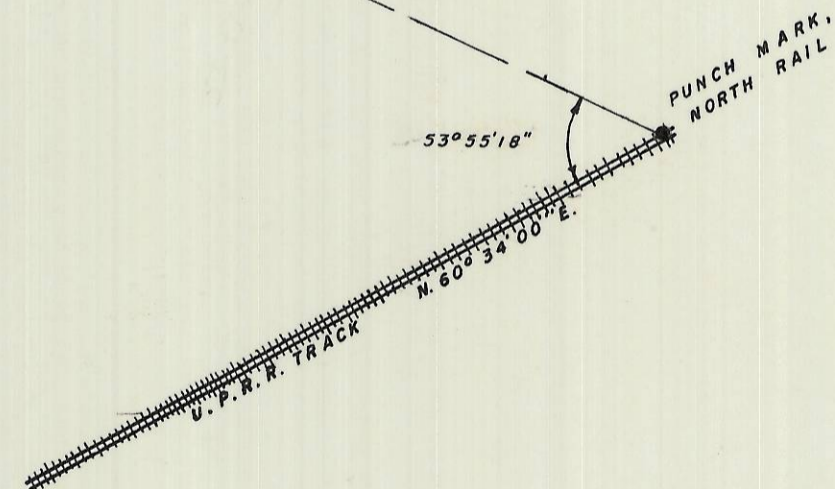

| | |
|---|-----------------|
| SURVEY FOR JACK RICHTER IN SECTIONS 12 & 13 T. 2 N. R. 31 E. W. M. | |
| DATE: 4-30-75 | SCALE: 1" = 50' |
| DONALD L. STAEBLER CONSULTING ENGINEER P. O. BOX 91 PENDLETON OREGON 97801 | |