

# RECORD OF SURVEY

LOCATED IN THE N.E. 1/4 OF THE N.E. 1/4 OF SECTION 23,  
TWP. 4 N., RNG. 28 E.W.M., UMATILLA COUNTY, OREGON.

T4N R28E  
S14 13S  
S23 S24  
2021  
49593 PLS

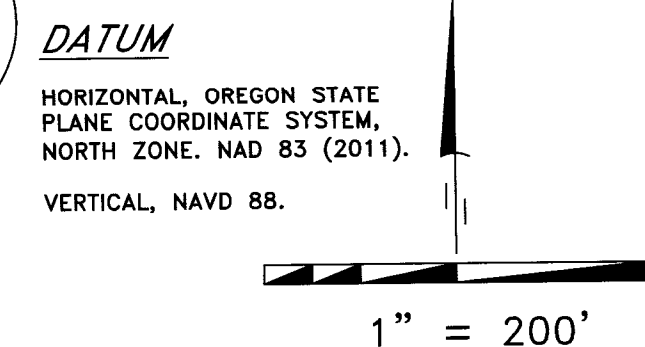

- LEGEND**
- FND: MONUMENT AS NOTED
  - SET: 5/8" X 30" IRON ROD WITH YELLOW PLASTIC CAP STAMPED "PLS LS 48490"
  - FND: 5/8" IRON ROD
  - × COMPUTED POINT (NOT SET)
  - (C) CALCULATED
  - (D) DEED
  - TRACT BOUNDARIES
  - FENCE AS NOTED

- SURVEYS**
- (R1) STEIN SURVEY NO. 22-015-B
  - (R2) HANLEY SURVEY NO. 08-141-B
  - (R3) CUMMINGS SURVEY NO. 13-120-B
  - (R4) KING SURVEY NO. 19-080-C
  - (R5) WAGNER PARTITION PLAT 1999-58
  - (R6) EDWARDS PARTITION PLAT 2008-25
  - (R7) STRATTON PARTITION PLAT 2009-58
  - (R8) EDWARDS PARTITION PLAT 2010-05
  - (R9) POSADA PARTITION PLAT 2018-20

- DEEDS**
- INST. NO. 2022-7410105
  - INST. NO. 2021-7170626
  - RL. 290 PG. 922
  - INST. NO. 2020-7090116
  - INST. NO. 2021-7280085
  - INST. NO. 2021-7280586
  - AMERITITLE TITLE REPORT FILE NO. 489967AM

## SURVEYOR'S CERTIFICATION

I, KEITH P. PRIMM, A PROFESSIONAL LAND SURVEYOR IN THE STATE OF OREGON HEREBY CERTIFY THAT I HAVE SURVEYED THE LANDS AS DESCRIBED IN LEGAL OF RECORD RECORDED AS INSTRUMENT NUMBER 2022-7410105 UMATILLA COUNTY DEED RECORDS AND THAT THIS PLAT CORRECTLY REPRESENTS A SURVEY CONDUCTED UNDER MY DIRECT SUPERVISION IN MAY 2022, AND HAVE SET THE PROPER MONUMENTS AS ESTABLISHED BY O.R.S. 209.

REGISTERED PROFESSIONAL LAND SURVEYOR  
*Keith P. Primm*  
OREGON  
JULY 12, 2005  
KEITH P. PRIMM  
48490  
EXPIRATION DATE: 12/31/22

DATE: 14 JUL 22

## SURVEYOR'S NARRATIVE

THIS SURVEY WAS UNDERTAKEN IN MAY OF 2022 AT THE REQUEST OF RICHARD L. HUNSAKER. THE PURPOSE OF THIS SURVEY IS TO MONUMENT THE EXTERIOR BOUNDARIES OF THAT LAND DESCRIBED AND RECORDED AS INSTRUMENT NUMBER 2022-7410105, THE PROPERTY CORNERS ALONG COOK PLACE WERE REQUESTED NOT TO BE SET.

THE N.E. SECTION CORNER, E. 1/4 CORNER, CENTER 1/4 CORNER, C-N 1/16 CORNER, N. 1/4 CORNER AND THE E. 1/16 CORNER WERE ALL FOUND AND RECOVERED.

THE REMAINING 1/16 CORNERS OF THE N.E. 1/4 WERE COMPUTED AS PER THE MANUAL OF SURVEYING INSTRUCTIONS UNITED STATES DEPARTMENT OF THE INTERIOR BUREAU OF LAND MANAGEMENT CADASTRAL SURVEY 2009.

A 1 1/2" ALUMINUM CAP STAMPED "APA 49593 PLS" IN A MONUMENT BOX WAS FOUND NEAR THE INTERSECTION POINT OF THE CENTERLINE OF COOK PLACE WITH THE WESTERLY RIGHT-OF-WAY OF S.E. TENTH STREET. THIS MONUMENT WAS FOUND TO NOT FALL ON THE WESTERLY RIGHT-OF-WAY OF S.E. TENTH STREET BY OVER 1/2 FOOT AND THEREFORE WAS NOT HELD.

THE INTERSECTION POINT OF THE CENTERLINE OF COOK PLACE WITH THE CENTERLINE OF S.E. TENTH STREET WAS COMPUTED BY BEARING-BEARING INTERSECTION, HOLDING THE BEARING OF THE EAST LINE OF THE N.E. 1/4 OF THE N.E. 1/4 AND HOLDING THE INTERIOR ANGLE OF THE CENTERLINE OF COOK PLACE WITH THE CENTERLINE OF S.E. TENTH STREET AS COMPUTED FROM SURVEY NUMBER 22-015-B, THIS ANGLE BEING 89°30'52".

THE INTERSECTION POINT OF THE CENTERLINE OF COOK PLACE WITH THE WESTERLY RIGHT-OF-WAY OF S.E. TENTH STREET WAS COMPUTED 33.00' FROM THE PREVIOUSLY DESCRIBED POINT AND ON LINE BETWEEN THE PREVIOUSLY DESCRIBED POINT AND THE FOUND 1 1/2" ALUMINUM CAP MARKED "APA 49593 PLS" IN A MONUMENT BOX AT THE CENTER OF THE CUL-DE-SAC OF COOK PLACE.

THE BASIS OF BEARING OF THIS SURVEY IS FROM PREVIOUSLY ESTABLISH SURVEY CONTROL AND IS BASED ON THE OREGON STATE PLANE COORDINATE SYSTEM, NORTH ZONE NAD 83(2011).

## CURVE TABLE

RECORD	CURVE	DELTA	RADIUS	LENGTH	CHORD	CHORD BEARING
	C1	89°30'52"	20.00'	31.25'	28.16'	N 45°25'18" W
(D)	C1	89°30'52"	20.00'	31.25'	28.16'	N 45°25'16" W
	C2	52°23'41"	25.00'	22.86'	22.07'	S 63°35'36" W
(D)	C2	52°23'41"	25.00'	22.86'	22.07'	S 63°37'28" W
	C3	284°43'09"	70.00'	347.85'	85.49'	N 00°10'40" W
(D)	C3	284°44'41"	70.00'	347.88'	85.47'	N 00°12'03" W
	C4	52°21'00"	25.00'	22.84'	22.06'	S 63°58'03" E
(D)	C4	52°21'00"	25.00'	22.84'	22.06'	S 64°00'12" E
	C5	90°29'08"	20.00'	31.59'	28.40'	N 44°34'42" E
(D)	C5	90°29'08"	20.00'	31.59'	28.40'	N 44°34'44" E

N 89°49'21" E, 1326.58'  
(R2) N 89°17'56" W, 1326.75'  
(R6) S 89°18'25" E, 1326.61'  
(R8) S 89°18'25" E, 1326.61'

## LINE TABLE

RECORD	LINE	BEARING	DIST.
	L1	(C) N 00°39'52" W	283.08'
	L2	(C) N 89°49'16" E	33.00'
(R1)	L2	S 89°49'18" W	33.00'
(D)	L3	(C) N 00°39'52" W	230.25'
(D)	L3	N 00°39'50" W	230.18'
(D)	L4	(C) S 89°49'16" W	655.22'
(D)	L4	S 89°49'18" W	655.19'
(D)	L5	(C) N 89°49'16" E	654.34'
(D)	L5	N 89°49'18" E	654.34'
(D)	L6	(C) S 00°39'52" E	106.00'
(D)	L6	S 00°39'50" E	106.00'
(D)	L7	(C) N 00°46'00" W	8.00'
(D)	L7	N 00°45'37" W	8.00'
(D)	L8	(C) N 45°46'00" W	56.56'
(D)	L8	N 45°45'37" W	56.56'
(D)	L9	(C) N 00°46'00" W	212.43'
(D)	L9	N 00°44'37" E	212.43'
(D)	L10	(C) N 89°49'16" E	467.85'
(D)	L10	N 89°49'18" E	467.62'

RECEIVED BY  
Umatilla County Surveyor  
Date: 7/14/22  
Rec'd By: CT  
No.: 22-075-B

N 89°46'21" E, 2648.65'  
(R2) S 89°21'10" E, 2648.98'  
(R6) S 89°21'28" E, 2648.75'  
(R8) S 89°21'28" E, 2648.75'  
(R9) S 89°21'28" E, 2648.75'

PRIMM LAND SURVEYING, INC.  
  
P.O. BOX 1322, 1340 N.E. 4TH  
HERMISTON, OR 97838  
BUI (541) 564-7887  
FAX (541) 567-8020  
keith@primmland surveying.com  
brit@primmlandsurveying.com

CLIENT: HUNSAKER  
N.E. 1/4 OF N.E. 1/4 SEC 23, TWP. 4 N. RNG. 28 E.W.M.  
PROJECT: BOUNDARY SURVEY OF THE N.E. 1/4 OF THE N.E. 1/4 SEC. 23, TWP. 4 N., RNG. 28 E.W.M. INST. NO. 2022-7410105.  
JOB #: 2110003  
DATE: 31MAY22  
FB/PG: 46/112  
SHEET: 1 OF 1  
DRAWN: KPP  
APPROVED: KPP