

605

S.E. 1/4 of S.E. 1

I.P. Point of Diversion  
S.W. 1/4 of S.W. 1/4 5

U.S. 30 R.W. Hwy 30-  
2399.3

N. 74° 24' W. 2497.2'

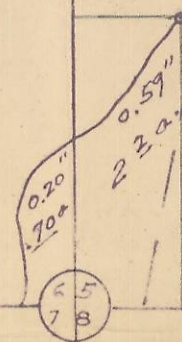

670.0

N. 1/4 cor. 8  
Sta. 0.0

9.63"  
35.4 a.  
N.E. 1/4 of N.E. 1/4 7

6.62"  
24.30 a.  
N.W. 1/4 of N.W. 1/4 8

3.93"  
14.4 a.  
S.E. 1/4 of N.E. 1/4 7

0.97"  
3.6 a.

S.W. 1/4 of N.W. 1/4 8

Gate.  
River Highway - To Rieth.

Map showing Portions of  
Sections 5, 6, 7, & 8 T.2N., R.32 E.W.M.  
Umatilla Co. Ore.  
surveyed, staked & Platted June 1952-  
By W.E.O. Criger.  
Scale: 1" = 400'

Total - 80.6 a.

O. Jay Brogotti.

RECEIVED BY

Umatilla County Surveyor

Date: 2/8/2013

Rec'd By: A. Aes

No.: 13-051-8

Elder T2N R 32 Sec 05  
06  
08



7

708

8

5