

NE COR. E 1/2
SW 1/4, NE 1/4, SEC. 32
FND. 1/2" I. REBAR
ME IN 1989 SURVEY
FOR REED

SE COR.
N 1/2, NW 1/4
SW 1/4, NE 1/4
SEC. 32

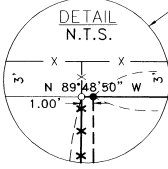

SURVEYOR'S NARRATIVE:

THE PURPOSE OF THIS SURVEY IS TO SURVEY THAT TRACT OF LAND DEEDED TO JAMES LEITCH AND JANICE REED ON INSTRUMENT 2009-5480601 UMATILLA COUNTY DEED RECORDS TO SEE HOW THE FENCES MATCH THE DEED LINES AND TO DO A BOUNDARY ADJUSTMENT ON THE WEST LINE.

I SURVEYED THE WEST LINE IN A 1989 SURVEY FOR JOHN WAGNER AND FOUND THE MONUMENTS FROM THAT SURVEY. IN THAT 1989 SURVEY I SUBDIVIDED THE NE 1/4 OF SECTION 32 BASED ON EXISTING MONUMENTS SOME OF WHICH WERE SET BY COUNTY SURVEYOR KIMBRELL IN 1910 AND 1913. THIS SURVEY WAS CONDUCTED WITH A TOPCON HIPER+ G.P.S. IN REAL TIME.

REGISTERED
PROFESSIONAL
LAND SURVEYOR

G. Dennis Edwards
OREGON
JULY 16, 1971
G. DENNIS EDWARDS
9 5 1
RENEWS 12/31/2009

C-7 LIMITED, LLC
2007-5160491

SEE DETAIL MAP

SHOP OVERLAPS
3.4' ±

DETAIL MAP
SCALE: 1"=30

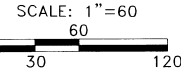

LEGEND:
● FOUND MONUMENTS AS NOTED
⊙ COMPUTED LOCATION
○ SET 5/8"X30" IRON REBAR WITH PLASTIC CAP #951
(000) OF RECORD, MY PARTITION PLAT 2001-56
{000} OF RECORD, MY 1998 SURVEYS FOR WAGNER & REED
[000] OF RECORD, DEEDS

SURVEY FOR JIM LEITCH
IN SW 1/4, NE 1/4, SEC. 32, T 5 N,
R 29 E, W.M., UMATILLA COUNTY, OREGON
05/06/2009 JOB #S0904029
EDWARDS SURVEYING P.O. BOX 763
541-587-3336 HERMISTON, OREGON 97838
DRAWN BY JMC

09-20-08
KJ
5-07

09-20-08