

# GEODETIC CONTROL SURVEY

## FOR THE BONNEVILLE POWER ADMINISTRATION

### PURPOSE OF SURVEY

THE PURPOSE OF THIS SURVEY IS GEODETIC CONTROL FOR THE BONNEVILLE POWER ADMINISTRATION ON THE McNARY-JOHN DAY PROJECT, LOCATED IN BENTON AND KICKITAT COUNTIES OF WASHINGTON, AND UMATILLA, MORROW, GILLIAM AND SHERMAN COUNTIES OF OREGON.

### NOTES

BACKGROUND MAPPING INFORMATION DERIVED FROM WSDOT MICROSTATION DRAWING FILES ARCHIVED AT THE WSDOT FTP SITE (address: ftp://ftp.wsdot.wa.gov/public/cor/Lography/). DRAWING FILES 2840t.dgn and 2848t.dgn WERE USED IN THIS COMPILATION, AND FROM ODOT MICROSTATION DRAWING FILES ARCHIVED AT THE ODOT FTP SITE. (address: ). DRAWING FILE sher1.dgn WAS USED IN THIS COMPILATION. GRAPHIC DATA HAS BEEN MODIFIED TO MATCH KNOWN CONTROL MONUMENT LOCATION AND IS SHOWN FOR ORIENTATION PURPOSE ONLY.

WASHINGTON		BENTON COUNTY	
TOWNSHIP	RANGE	SECTION	
5 N	28 E	3, 4 & 5	
5 N	27 E	1, 2, 3, 4, 5, 6, 8 & 12	
6 N	26 E	7, 18 & 31	
5 N	26 E	2, 3, 6, 7, 8 & 10	
5 N	25 E	6, 8, 9, 12, 15, 16, 17, 18, 19, 20, 22, 28 & 31	
5 N	24 E	2, 3, 6, 8, 10, 11, 15, 18, 19, 23, 26, 28, 29, 31	
		33, 34 & 35	
4 N	24 E	5, 6 & 23	

OREGON		UMATILLA COUNTY	
TOWNSHIP	RANGE	SECTION	
5 N	28 E	8, 9, 10, 11, 14, 16, 21 & 25	
4 N	28 E	13	

OREGON		MORROW COUNTY	
TOWNSHIP	RANGE	SECTION	
5 N	26 E	23	
4 N	24 E	21	
4 N	23 E	21	

WASHINGTON		KICKITAT COUNTY	
TOWNSHIP	RANGE	SECTION	
4 N	23 E	2, 10, 16, 18 & 21	
4 N	22 E	23, 25, 27, 28, 29, 31, 32 & 36	
4 N	21 E	35 & 36	
3 N	21 E	2, 3, 4, 7, 9, 17 & 18	
3 N	20 E	13, 14, 17, 19, 20, 21, 24 & 33	
3 N	19 E	25, 26, 27, 30, 31 & 32	
3 N	18 E	4, 7, 8, 15, 16, 22, 23 & 25	
3 N	17 E	1, 8, 10, 12, 13, 15, 16, 17, 19, 20, 21, 26	
		29, 30, 31, 32 & 33	
2 N	17 E	2, 5, 6, 7 & 8	

OREGON		GILLIAM COUNTY	
TOWNSHIP	RANGE	SECTION	
4 N	22 E	25	
3 N	22 E	5	
3 N	20 E	33	
2 N	19 E	5 & 6	

OREGON		SHERMAN COUNTY	
TOWNSHIP	RANGE	SECTION	
3 N	17 E	28, 31, 32 & 33	
2 N	17 E	3, 5, 6, 7 & 8	
2 N	16 E	1	

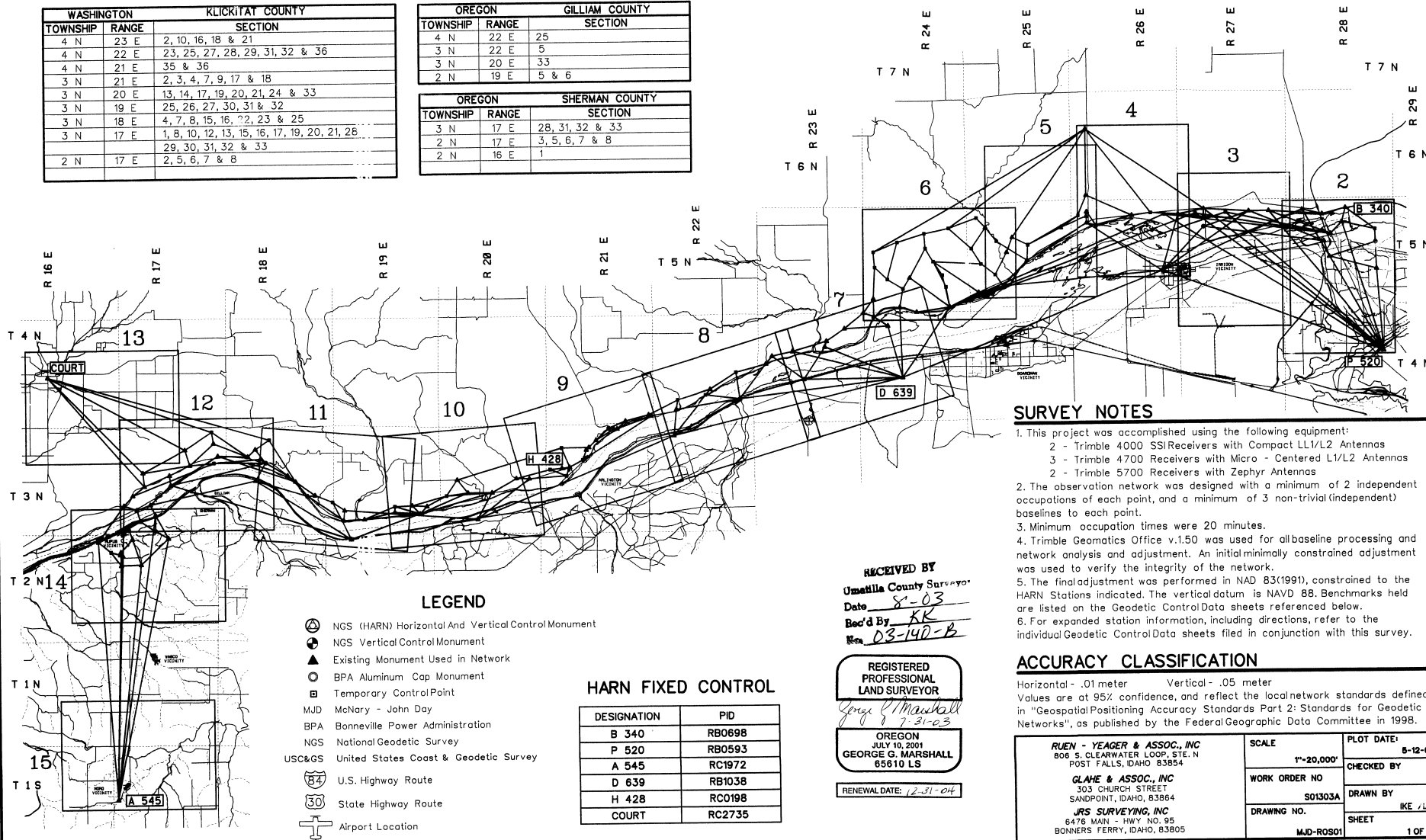
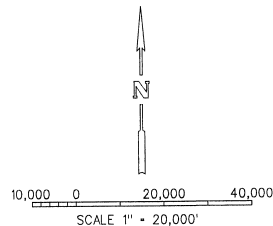

### SURVEY NOTES

- This project was accomplished using the following equipment:
  - Trimble 4000 SSI Receivers with Compact L1/L2 Antennas
  - Trimble 4700 Receivers with Micro - Centered L1/L2 Antennas
  - Trimble 5700 Receivers with Zephyr Antennas
- The observation network was designed with a minimum of 2 independent occupations of each point, and a minimum of 3 non-trivial (independent) baselines to each point.
- Minimum occupation times were 20 minutes.
- Trimble Geomatics Office v.1.50 was used for all baseline processing and network analysis and adjustment. An initial minimally constrained adjustment was used to verify the integrity of the network.
- The final adjustment was performed in NAD 83(1991), constrained to the HARN Stations indicated. The vertical datum is NAVD 88. Benchmarks held are listed on the Geodetic Control Data sheets referenced below.
- For expanded station information, including directions, refer to the individual Geodetic Control Data sheets filed in conjunction with this survey.

### ACCURACY CLASSIFICATION

Horizontal - .01 meter      Vertical - .05 meter  
 Values are at 95% confidence, and reflect the local network standards defined in "Geospatial Positioning Accuracy Standards Part 2: Standards for Geodetic Networks", as published by the Federal Geographic Data Committee in 1998.

<b>RUEN - YEAGER &amp; ASSOC., INC</b> 806 S. CLEARWATER LOOP, STE. N POST FALLS, IDAHO 83854  <b>GLAHE &amp; ASSOC., INC</b> 503 CHURCH STREET SANDPOINT, IDAHO, 83864  <b>JRS SURVEYING, INC</b> 6476 MAIN - HWY NO. 95 BONNERS FERRY, IDAHO, 83805	SCALE	1"=20,000"	PLOT DATE:	5-12-03
	WORK ORDER NO	S01303A	CHECKED BY	GM
DRAWING NO.	MJD-RSD01	DRAWN BY	KE LUFFE	
		SHEET		1 OF 15

### LEGEND

- ⊙ NGS (HARN) Horizontal And Vertical Control Monument
- NGS Vertical Control Monument
- ▲ Existing Monument Used in Network
- BPA Aluminum Cap Monument
- Temporary Control Point
- MJD McNary - John Day
- BPA Bonneville Power Administration
- NGS National Geodetic Survey
- USC&GS United States Coast & Geodetic Survey
- 84 U.S. Highway Route
- 30 State Highway Route
- ✈ Airport Location

### HARN FIXED CONTROL

DESIGNATION	PID
B 340	RB0698
P 520	RB0593
A 545	RC1972
D 639	RB1038
H 428	RC0198
COURT	RC2735

# GEODETIC CONTROL SURVEY

FOR THE  
BONNEVILLE POWER ADMINISTRATION

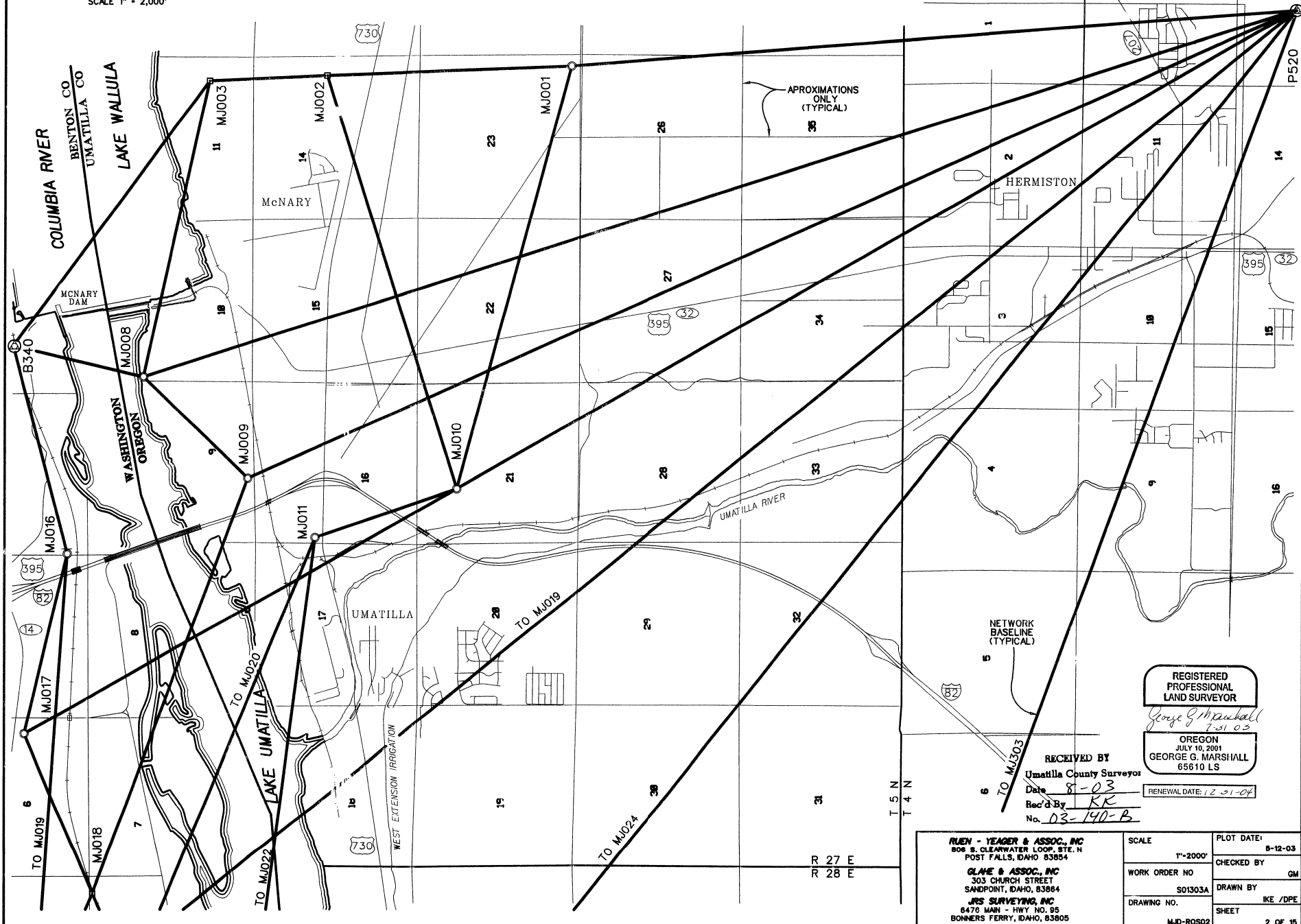
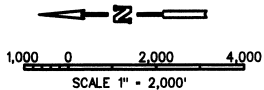

APPROXIMATIONS ONLY (TYPICAL)

NETWORK BASELINE (TYPICAL)

REGISTERED  
PROFESSIONAL  
LAND SURVEYOR

*George G. Marshall*  
7-31-03

OREGON  
JULY 10, 2001  
GEORGE G. MARSHALL  
65610 LS

RECEIVED BY  
Umatilla County Surveyor  
Date: 8-03  
Rec'd By: KK  
No. 03-140-B

RENEWAL DATE: 12-31-04

**RUEY - YEAGER & ASSOC., INC.**  
808 S. CLEARWATER LOOP, STE. N  
POST FALLS, IDAHO 83854

**GLAHE & ASSOC., INC.**  
303 CHURCH STREET  
SANDPOINT, IDAHO, 83864

**JRS SURVEYING, INC.**  
6476 MAIN - HWY NO. 95  
BONNERS FERRY, IDAHO, 83805

SCALE	1"=2000'	PLOT DATE:	8-12-03
WORK ORDER NO.		CHECKED BY	GM
DRAWING NO.	S01303A	DRAWN BY	KE /DPE
		SHEET	2 OF 15
MJD-ROS02			

R 27 E  
R 28 E

T 5 N  
T 4 N

**GEODETIC CONTROL SURVEY**  
FOR THE  
**BONNEVILLE POWER ADMINISTRATION**



1,000 0 2,000 4,000  
SCALE 1" = 2,000'

NETWORK  
BASELINE  
(TYPICAL)

APPROXIMATIONS  
ONLY  
(TYPICAL)

RECEIVED BY  
Umatilla County Surveyor  
Date 8-03  
Rec'd by KK  
No. 03-140-B

REGISTERED  
PROFESSIONAL  
LAND SURVEYOR  
*George G. Marshall*  
1-31-04  
OREGON  
JULY 10, 2001  
GEORGE G. MARSHALL  
65610 LS  
RENEWAL DATE: 12-31-04

RUEN - YEAGER & ASSOC., INC 606 S. CLEARWATER LOOP, STE. N POST FALLS, IDAHO 83884 GLAHE & ASSOC., INC 303 CHURCH STREET SANDPOINT, IDAHO, 83864 JRS SURVEYING, INC 6476 MAN - HWY NO. 85 BONNERS FERRY, IDAHO, 83805	SCALE 1"=2000'	PLOT DATE: 6-12-03
	WORK ORDER NO S01303A	CHECKED BY GM
DRAWING NO.	DRAWN BY IKE /DPE	SHEET
MJD-ROS03		3 OF 15

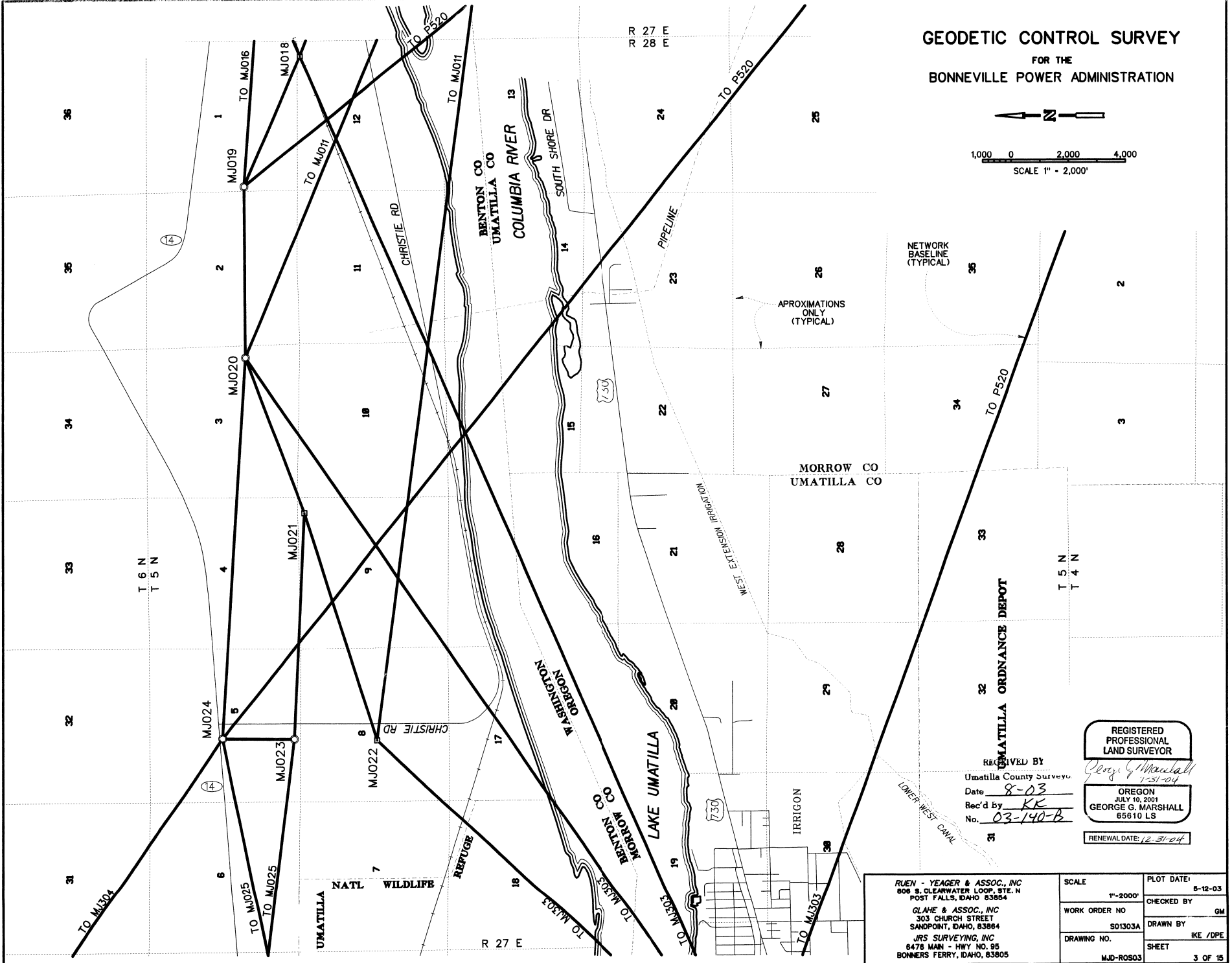

**GEODETC CONTROL SURVEY**  
**FOR THE**  
**BONNEVILLE POWER ADMINISTRATION**

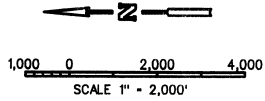

REGISTERED  
 PROFESSIONAL  
 LAND SURVEYOR

*George G. Marshall*  
 7-21-03

OREGON  
 JULY 10, 2001  
 GEORGE G. MARSHALL  
 65610 LS

RENEWAL DATE: 12-31-04

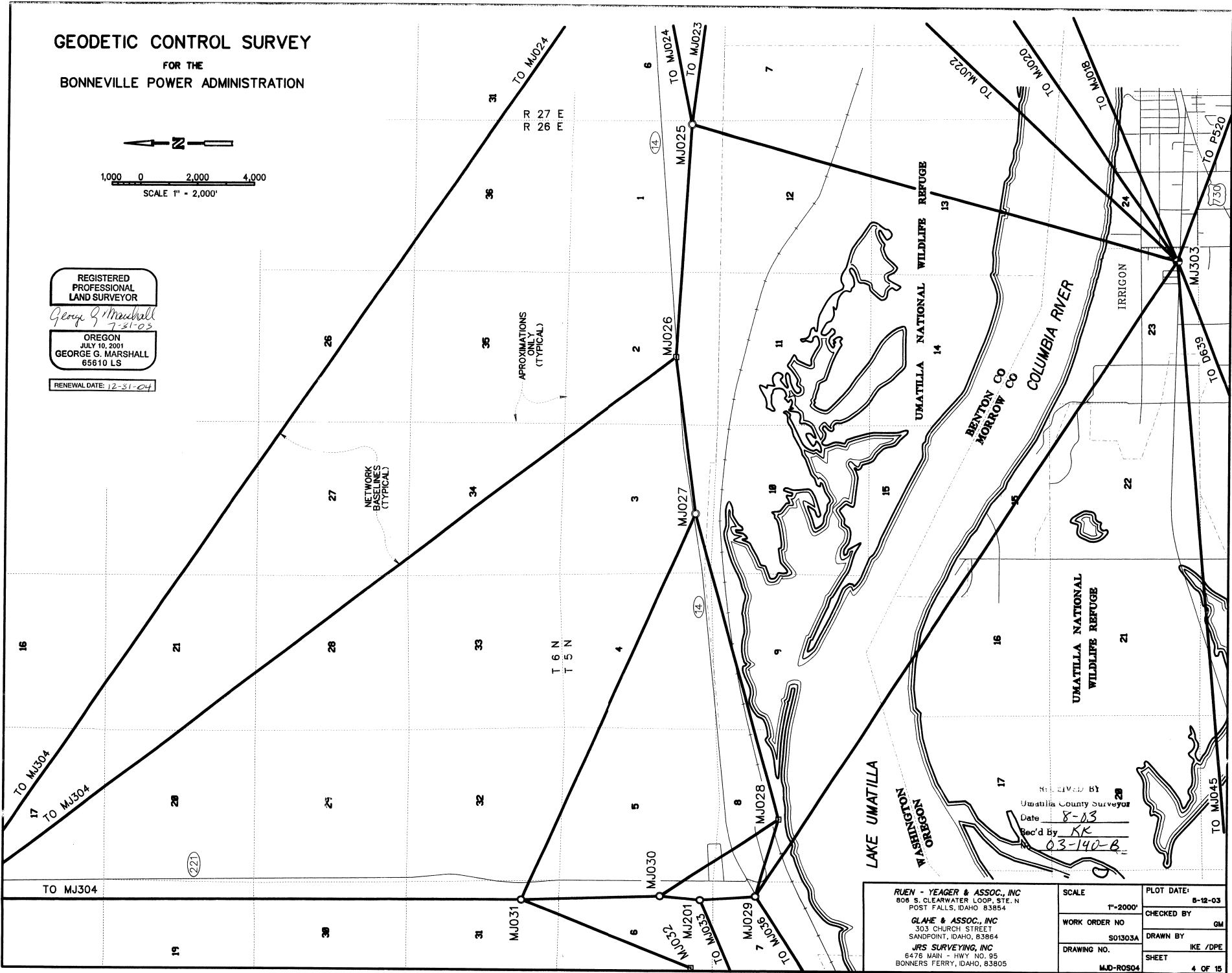

RECEIVED BY  
 Umatilla County Surveyor  
 Date 8-03  
 Rec'd By KK  
03-140-B

**RUEY - YEAGER & ASSOC., INC**  
 808 S. CLEARWATER LOOP, STE. N  
 POST FALLS, IDAHO 83854

**GLAHE & ASSOC., INC**  
 303 CHURCH STREET  
 SANDPOINT, IDAHO, 83864

**JRS SURVEYING, INC**  
 6478 MAIN - HWY NO. 95  
 BONNERS FERRY, IDAHO, 83805

SCALE	1"=2000'	PLOT DATE:	8-12-03
WORK ORDER NO.	S01303A	CHECKED BY	GM
DRAWING NO.		DRAWN BY	IKK /DPE
		SHEET	4 OF 15
MJD-R0504			

# GEODETIC CONTROL SURVEY

FOR THE  
BONNEVILLE POWER ADMINISTRATION

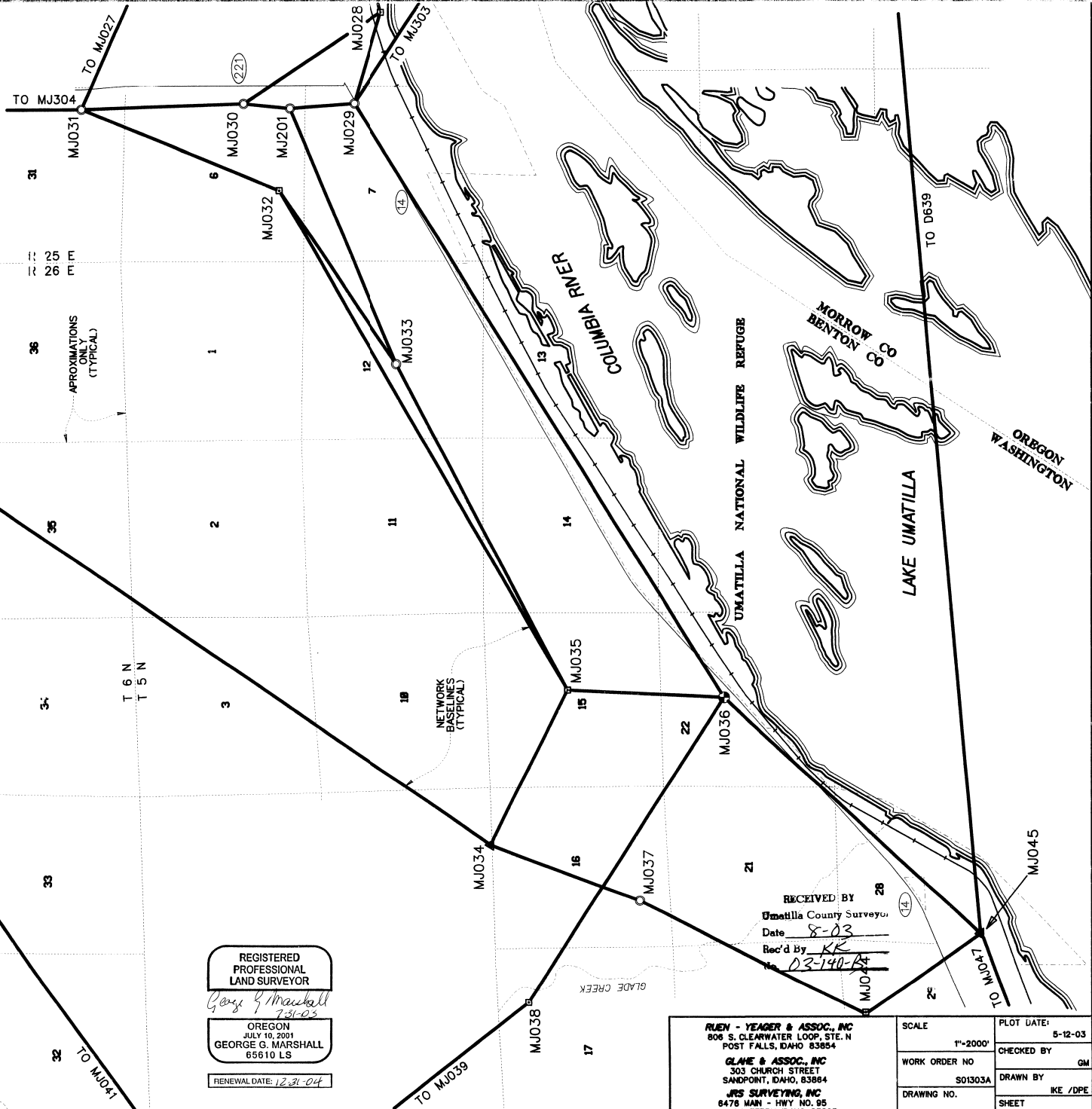
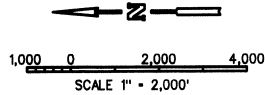

± 25 FT  
± 26 FT  
APPROXIMATIONS ONLY (TYPICAL)

T 6 N  
T 5 N

NETWORK BASELINES (TYPICAL)

REGISTERED PROFESSIONAL LAND SURVEYOR

*George G. Marshall*  
7-31-03  
OREGON  
JULY 10, 2001  
GEORGE G. MARSHALL  
65610 LS

RENEWAL DATE: 12-31-04

RECEIVED BY  
Umatilla County Surveyor  
Date 8-03  
Rec'd by KR  
No. 03-140-B

**RUEN - YEAGER & ASSOC., INC**  
806 S. CLEARWATER LOOP, STE. N  
POST FALLS, IDAHO 83854  
**GLAVE & ASSOC., INC**  
303 CHURCH STREET  
SANDPOINT, IDAHO, 83864  
**IRS SURVEYING, INC**  
8475 MAIN - HWY. NO. 95  
BONNERS FERRY, IDAHO, 83805

SCALE	1"=2000'	PLOT DATE:	5-12-03
WORK ORDER NO	S01303A	CHECKED BY	GM
DRAWING NO.		DRAWN BY	KE /DPE
		SHEET	5 OF 15

**GEODETIC CONTROL SURVEY**  
**FOR THE**  
**BONNEVILLE POWER ADMINISTRATION**



1,000 0 2,000 4,000  
 SCALE 1" = 2,000'

REGISTERED  
 PROFESSIONAL  
 LAND SURVEYOR

*George G. Marshall*  
 7-31-03

OREGON  
 JULY 10, 2001  
 GEORGE G. MARSHALL  
 65610 LS

RENEWAL DATE: 2-31-04

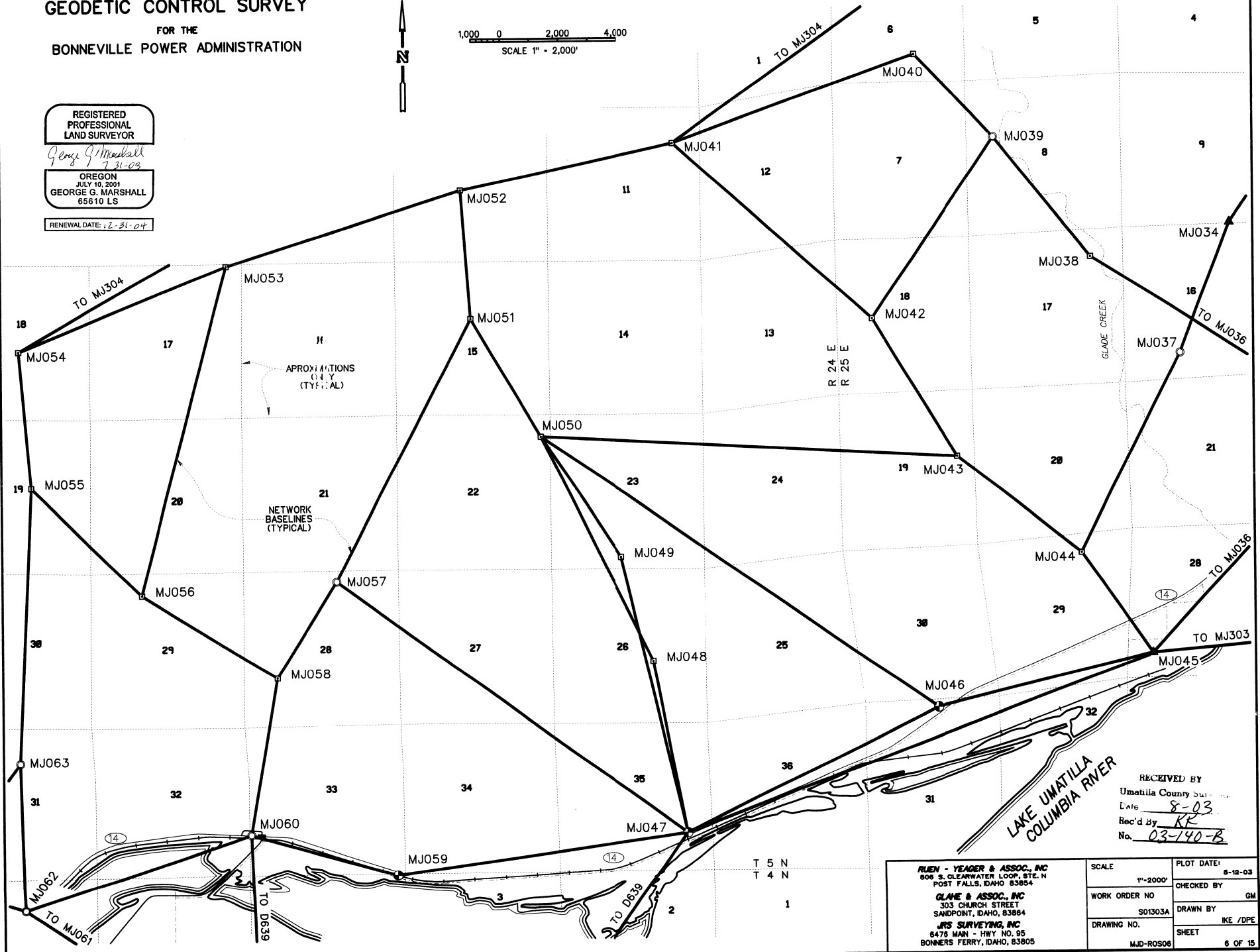

RECEIVED BY  
 Umatilla County Survey  
 Date 8-03  
 Rec'd by KK  
 No. 03-140-B

RUEN - YEAGER & ASSOC., INC 806 S. CLEARWATER LOOP, STE. N POST FALLS, IDAHO 83804 GLAHE & ASSOC., INC 303 CHURCH STREET SANDPOINT, IDAHO, 83864 JRS SURVEYING, INC 6475 MAN - HWY NO. 95 BONNERS FERRY, IDAHO, 83805	SCALE	1"=2000'	PLOT DATE:	8-12-03
	WORK ORDER NO	S01303A	CHECKED BY	GM
	DRAWING NO.		DRAWN BY	IKE /DPE
			SHEET	6 OF 15

**GEODETIC CONTROL SURVEY**  
FOR THE  
**BONNEVILLE POWER ADMINISTRATION**

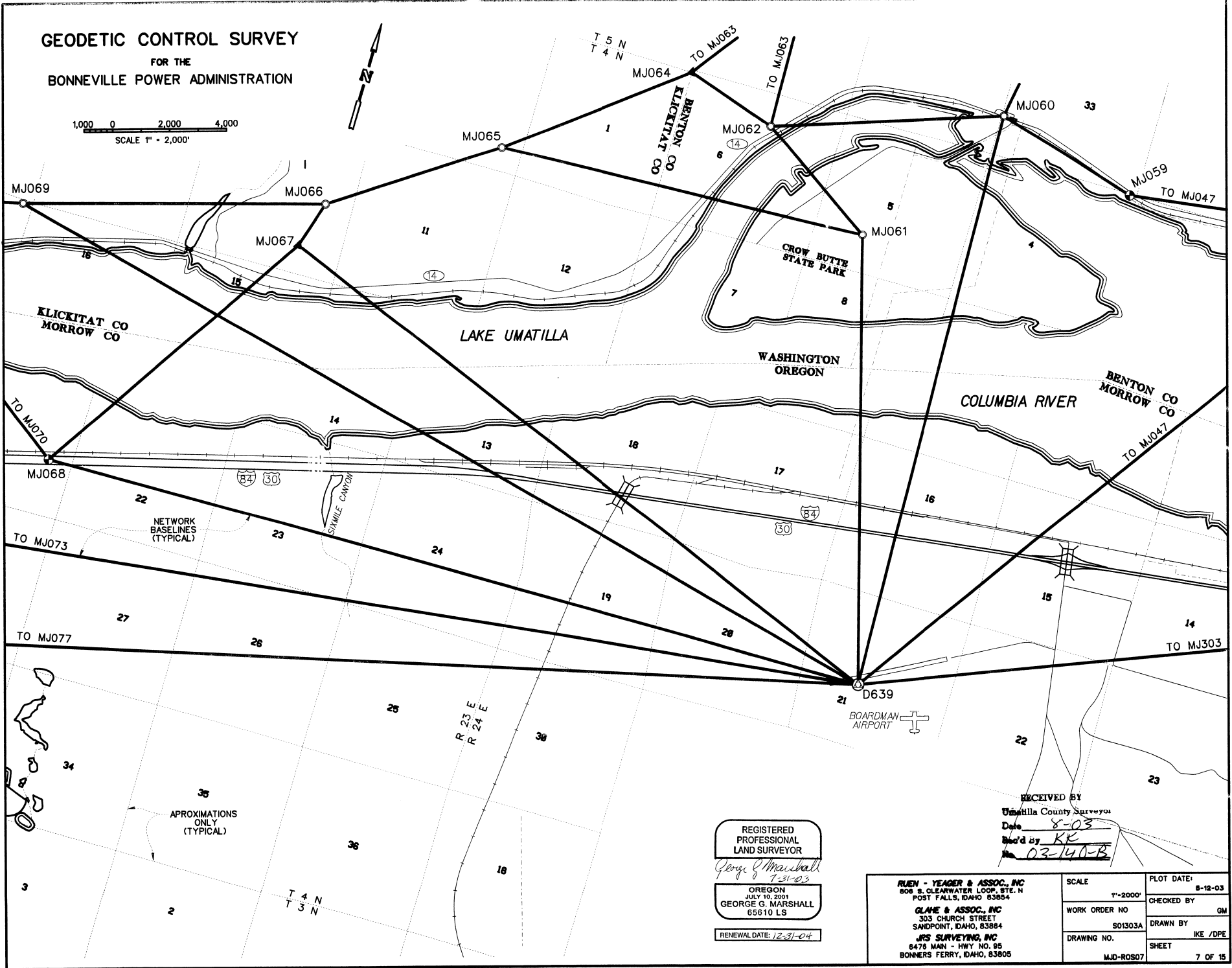
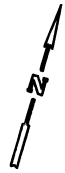
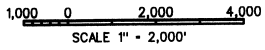

APPROXIMATIONS ONLY (TYPICAL)

REGISTERED PROFESSIONAL LAND SURVEYOR

*George G. Marshall*  
7-31-03  
OREGON  
JULY 10, 2001  
GEORGE G. MARSHALL  
65610 LS

RENEWAL DATE: 12-31-04

RECEIVED BY  
Umatilla County Surveyor  
Date 8-03  
Rec'd by KE  
03-140-B

<b>RUE - YEAGER &amp; ASSOC., INC</b> 806 S. CLEARWATER LOOP, STE. N POST FALLS, IDAHO 83854 <b>GLAHE &amp; ASSOC., INC</b> 303 CHURCH STREET SANDPOINT, IDAHO, 83864 <b>JRS SURVEYING, INC</b> 6478 MAIN - HWY NO. 95 BONNERS FERRY, IDAHO, 83805	SCALE	1"=2000'	PLOT DATE:	8-12-03
	WORK ORDER NO	S01303A	CHECKED BY	GM
	DRAWING NO.	MJD-R0507	DRAWN BY	IKE /DPE
			SHEET	7 OF 15

**GEODETTIC CONTROL SURVEY**  
 FOR THE  
 BONNEVILLE POWER ADMINISTRATION

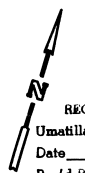
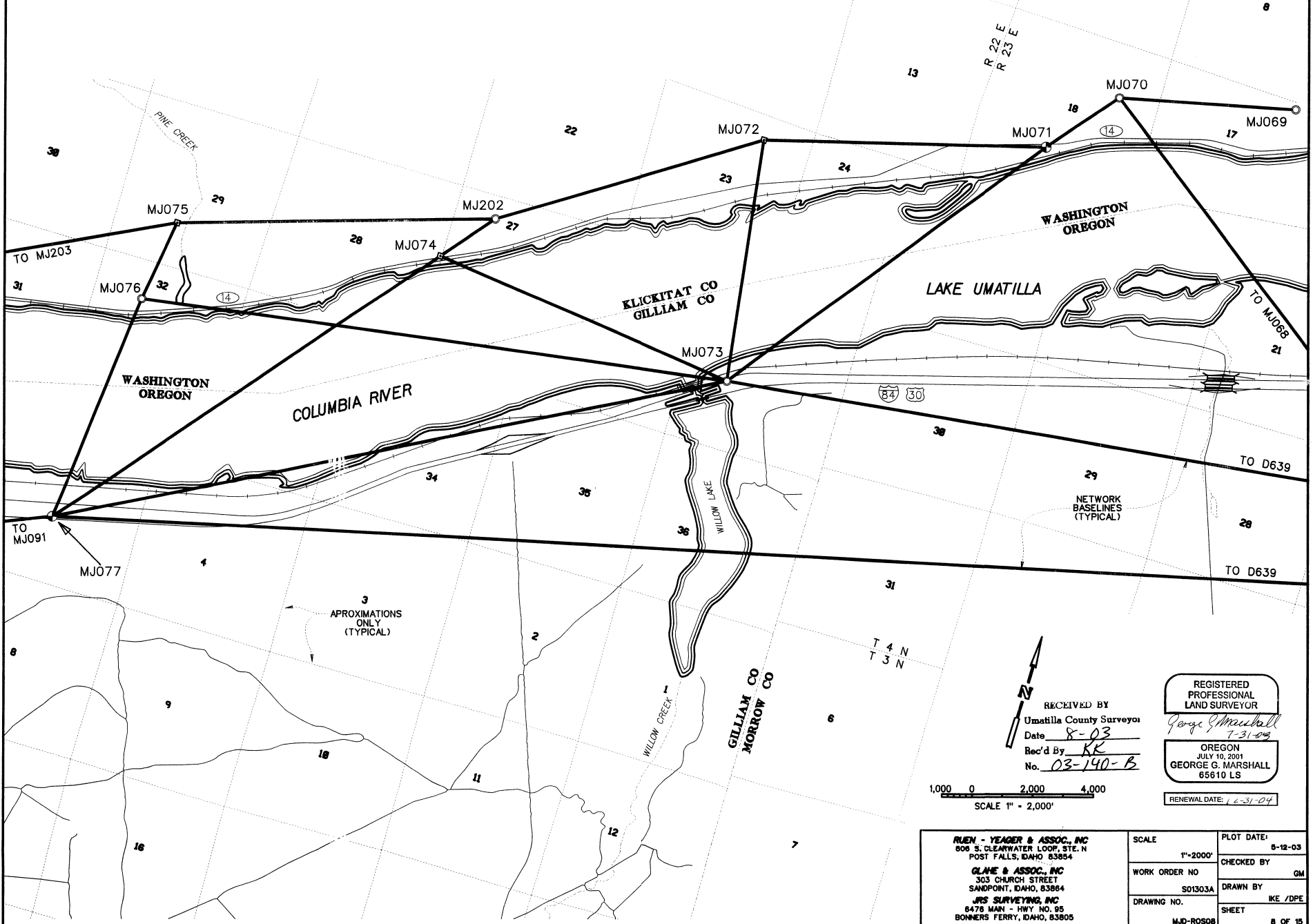

RECEIVED BY  
 Umatilla County Surveyor  
 Date 8-03  
 Rec'd By KK  
 No. 03-140-B

1,000 0 2,000 4,000  
 SCALE 1" = 2,000'

REGISTERED  
 PROFESSIONAL  
 LAND SURVEYOR

*George G. Marshall*  
 7-31-03

OREGON  
 JULY 10, 2001  
 GEORGE G. MARSHALL  
 65610 LS

RENEWAL DATE: 6-31-04

**RUEN - YEAGER & ASSOC., INC**  
 806 S. CLEARWATER LOOP, STE. N  
 POST FALLS, IDAHO 83854  
**GLAHE & ASSOC., INC**  
 303 CHURCH STREET  
 SANDPOINT, IDAHO, 83864  
**JRS SURVEYING, INC**  
 8478 MAIN - HWY NO. 95  
 BONNERS FERRY, IDAHO, 83805

SCALE	1"=2000'	PLOT DATE	6-12-03
WORK ORDER NO	S01303A	CHECKED BY	GM
DRAWING NO.		DRAWN BY	IKE /DPE
		SHEET	8 OF 15

MJD-RS008



**GEODETC CONTROL SURVEY**  
**FOR THE**  
**BONNEVILLE POWER ADMINISTRATION**

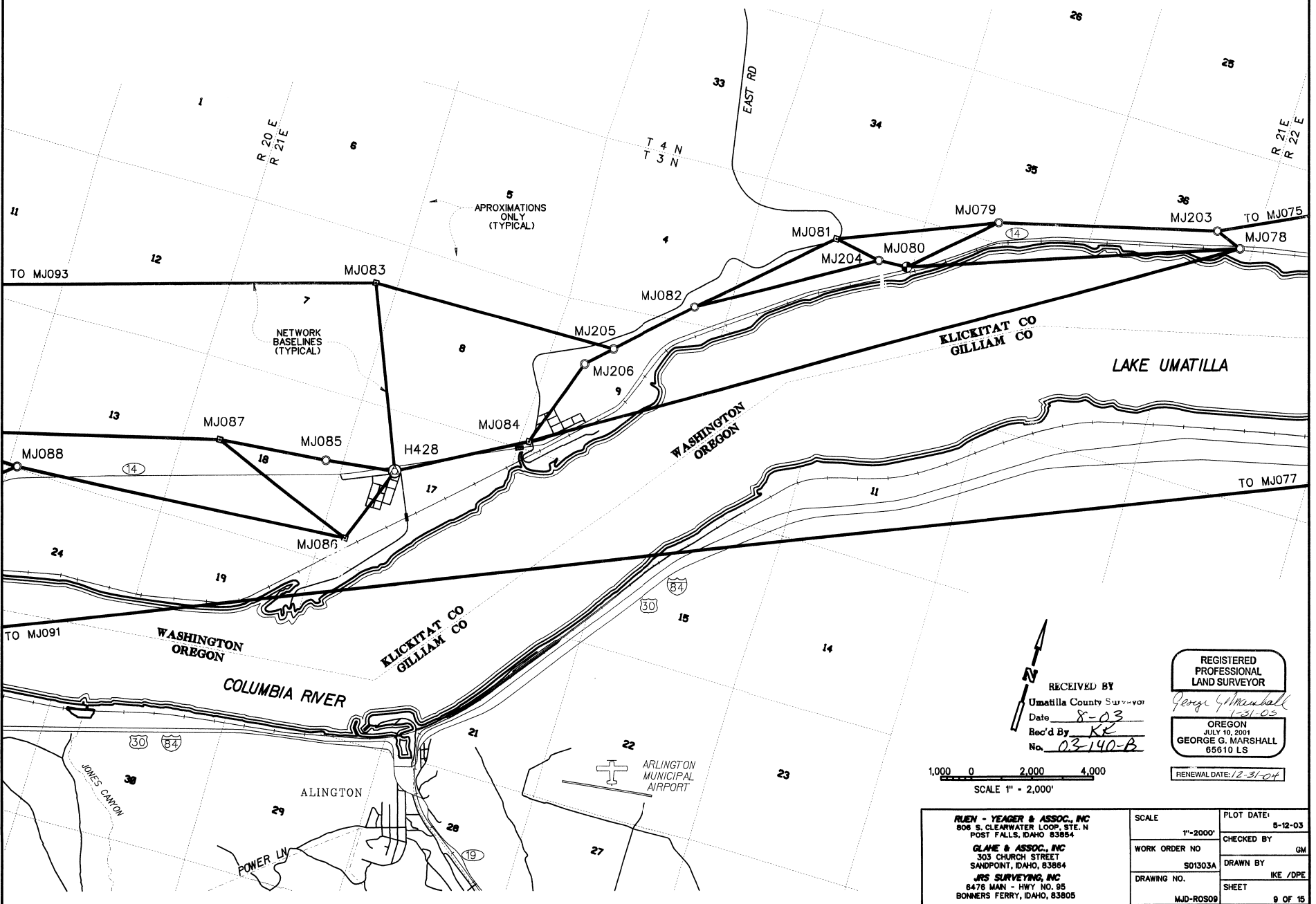

RECEIVED BY  
 Umatilla County Surveyor  
 Date 8-03  
 Rec'd By KE  
 No. 03-140-B

REGISTERED  
 PROFESSIONAL  
 LAND SURVEYOR

*George G. Marshall*  
 1-31-03  
 OREGON  
 JULY 10, 2001  
 GEORGE G. MARSHALL  
 65610 LS

RENEWAL DATE: 12-31-04

1,000 0 2,000 4,000  
 SCALE 1" = 2,000'

**RIEN - YEAGER & ASSOC., INC**  
 806 S. CLEARWATER LOOP, STE. N  
 POST FALLS, IDAHO 83854  
**GLANE & ASSOC., INC**  
 303 CHURCH STREET  
 SANDPOINT, IDAHO, 83864  
**IRS SURVEYING, INC**  
 8478 MAN - HWY NO. 95  
 BONNERS FERRY, IDAHO, 83805

SCALE	1"=2000'	PLOT DATE:	8-12-03
WORK ORDER NO	501303A	CHECKED BY	GM
DRAWING NO.		DRAWN BY	IKE /DPE
		SHEET	9 OF 15

**GEODETC CONTROL SURVEY**  
 FOR THE  
**BONNEVILLE POWER ADMINISTRATION**

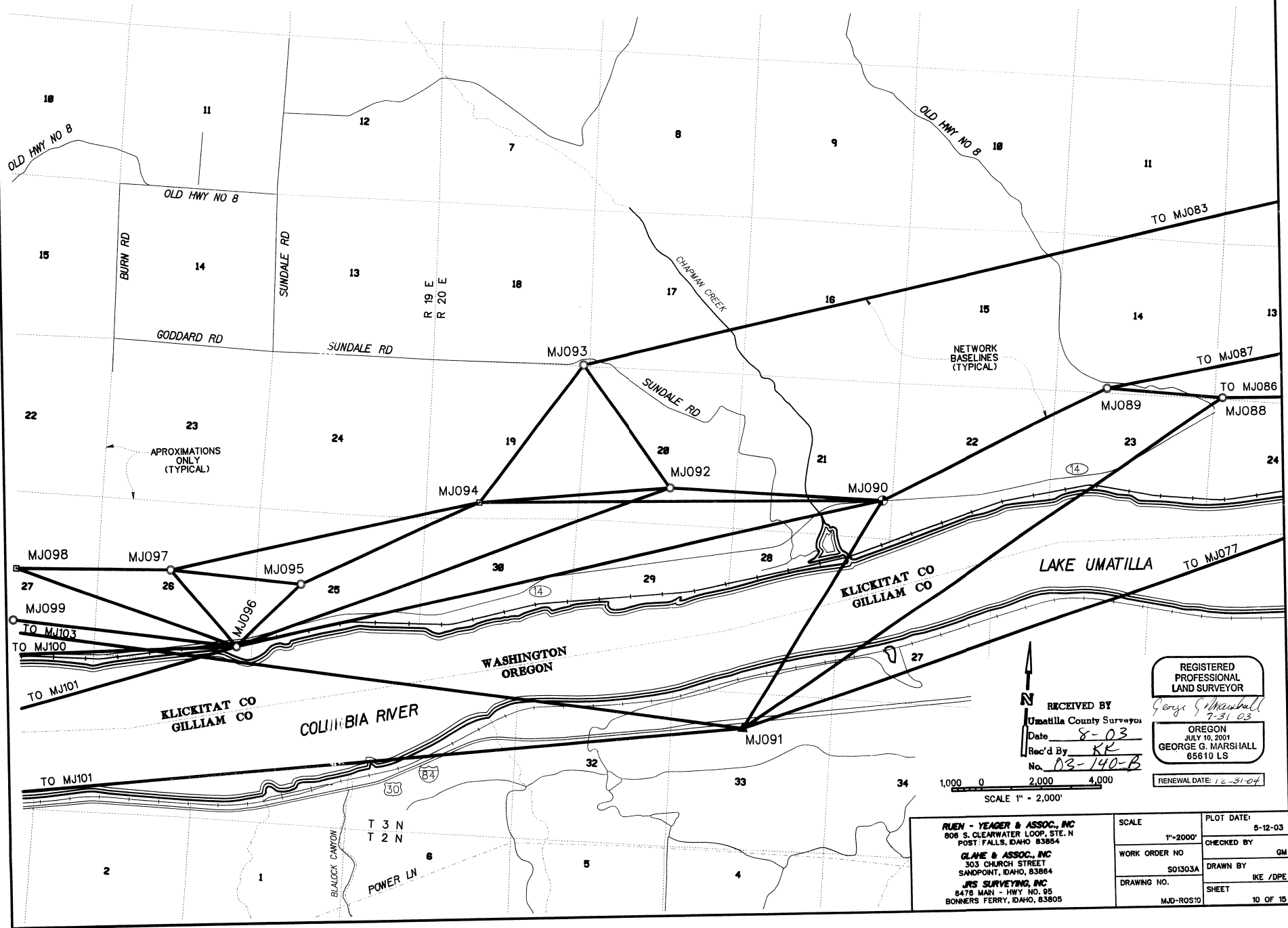

APROXIMATIONS ONLY (TYPICAL)

N

RECEIVED BY  
 Umatilla County Surveyor  
 Date 8-03  
 Rec'd By KR  
 No. 03-140-B

SCALE 1" = 2,000'

1,000 0 2,000 4,000

REGISTERED  
 PROFESSIONAL  
 LAND SURVEYOR

*George G. Marshall*  
 7-31-03

OREGON  
 JULY 10, 2001  
 GEORGE G. MARSHALL  
 65610 LS

RENEWAL DATE: 12-31-04

RUEN - YEAGER & ASSOC., INC 808 S. CLEARWATER LOOP, STE. N POST FALLS, IDAHO 83854  GLAHE & ASSOC., INC 303 CHURCH STREET SANDPOINT, IDAHO, 83884  JES SURVEYING, INC 8478 MAIN - HWY NO. 95 BONNERS FERRY, IDAHO, 83805	SCALE	PLOT DATE:
	1"=2000'	5-12-03
	WORK ORDER NO	CHECKED BY
	S01303A	GM
DRAWING NO.	DRAWN BY	
	KE /DPE	
	SHEET	
MJD-ROS10		10 OF 15

T 3 N  
 T 2 N

POWER LN

BLAOCK CANYON

WASHINGTON  
 OREGON

KLICKITAT CO  
 GILLIAM CO

KLICKITAT CO  
 GILLIAM CO

COLUMBIA RIVER

LAKE UMATILLA

OLD HWY NO 8

OLD HWY NO 8

OLD HWY NO 8

TO MJ083

TO MJ087

TO MJ086

MJ089

MJ088

TO MJ077

MJ098

MJ097

MJ095

MJ094

MJ093

MJ092

MJ090

MJ091

MJ096

MJ099

TO MJ103

TO MJ100

TO MJ101

TO MJ101

R 19 E  
 R 20 E

APROXIMATIONS ONLY (TYPICAL)

NETWORK  
 BASELINES  
 (TYPICAL)

CHAPMAN CREEK

BURN RD

SUNDALE RD

GODDARD RD

SUNDALE RD

SUNDALE RD

POWER LN

BLAOCK CANYON

WASHINGTON  
 OREGON

KLICKITAT CO  
 GILLIAM CO

KLICKITAT CO  
 GILLIAM CO

COLUMBIA RIVER

LAKE UMATILLA

OLD HWY NO 8

OLD HWY NO 8

OLD HWY NO 8

TO MJ083

TO MJ087

TO MJ086

MJ089

MJ088

TO MJ077

MJ098

MJ097

MJ095

MJ094

MJ093

MJ092

MJ090

MJ091

MJ096

MJ099

TO MJ103

TO MJ100

TO MJ101

TO MJ101

R 19 E  
 R 20 E

APROXIMATIONS ONLY (TYPICAL)

NETWORK  
 BASELINES  
 (TYPICAL)

CHAPMAN CREEK

BURN RD

SUNDALE RD

GODDARD RD

SUNDALE RD

SUNDALE RD

POWER LN

BLAOCK CANYON

WASHINGTON  
 OREGON

KLICKITAT CO  
 GILLIAM CO

KLICKITAT CO  
 GILLIAM CO

COLUMBIA RIVER

LAKE UMATILLA

OLD HWY NO 8

OLD HWY NO 8

OLD HWY NO 8

TO MJ083

TO MJ087

TO MJ086

MJ089

MJ088

TO MJ077

MJ098

MJ097

MJ095

MJ094

MJ093

MJ092

MJ090

MJ091

MJ096

MJ099

TO MJ103

TO MJ100

TO MJ101

TO MJ101

R 19 E  
 R 20 E

APROXIMATIONS ONLY (TYPICAL)

NETWORK  
 BASELINES  
 (TYPICAL)

CHAPMAN CREEK

BURN RD

SUNDALE RD

GODDARD RD

SUNDALE RD

SUNDALE RD

POWER LN

BLAOCK CANYON

WASHINGTON  
 OREGON

KLICKITAT CO  
 GILLIAM CO

KLICKITAT CO  
 GILLIAM CO

COLUMBIA RIVER

LAKE UMATILLA

OLD HWY NO 8

OLD HWY NO 8

OLD HWY NO 8

TO MJ083

TO MJ087

TO MJ086

MJ089

MJ088

TO MJ077

MJ098

MJ097

MJ095

MJ094

MJ093

MJ092

MJ090

MJ091

MJ096

MJ099

TO MJ103

TO MJ100

TO MJ101

TO MJ101

R 19 E  
 R 20 E

APROXIMATIONS ONLY (TYPICAL)

NETWORK  
 BASELINES  
 (TYPICAL)

CHAPMAN CREEK

BURN RD

SUNDALE RD

GODDARD RD

SUNDALE RD

SUNDALE RD

POWER LN

BLAOCK CANYON

WASHINGTON  
 OREGON

KLICKITAT CO  
 GILLIAM CO

KLICKITAT CO  
 GILLIAM CO

COLUMBIA RIVER

LAKE UMATILLA

OLD HWY NO 8

OLD HWY NO 8

OLD HWY NO 8

TO MJ083

TO MJ087

TO MJ086

MJ089

MJ088

TO MJ077

MJ098

MJ097

MJ095

MJ094

MJ093

MJ092

MJ090

MJ091

MJ096

MJ099

TO MJ103

TO MJ100

TO MJ101

TO MJ101

R 19 E  
 R 20 E

APROXIMATIONS ONLY (TYPICAL)

NETWORK  
 BASELINES  
 (TYPICAL)

CHAPMAN CREEK

BURN RD

SUNDALE RD

GODDARD RD

SUNDALE RD

SUNDALE RD

POWER LN

BLAOCK CANYON

WASHINGTON  
 OREGON

KLICKITAT CO  
 GILLIAM CO

KLICKITAT CO  
 GILLIAM CO

COLUMBIA RIVER

LAKE UMATILLA

OLD HWY NO 8

OLD HWY NO 8

OLD HWY NO 8

TO MJ083

TO MJ087

TO MJ086

MJ089

MJ088

TO MJ077

MJ098

MJ097

MJ095

MJ094

MJ093

MJ092

MJ090

MJ091

MJ096

MJ099

TO MJ103

TO MJ100

TO MJ101

TO MJ101

R 19 E  
 R 20 E

APROXIMATIONS ONLY (TYPICAL)

NETWORK  
 BASELINES  
 (TYPICAL)

CHAPMAN CREEK

BURN RD

SUNDALE RD

GODDARD RD

SUNDALE RD

SUNDALE RD

POWER LN

BLAOCK CANYON

WASHINGTON  
 OREGON

KLICKITAT CO  
 GILLIAM CO

KLICKITAT CO  
 GILLIAM CO

COLUMBIA RIVER

LAKE UMATILLA

OLD HWY NO 8

OLD HWY NO 8

OLD HWY NO 8

TO MJ083

TO MJ087

TO MJ086

MJ089

MJ088

TO MJ077

MJ098

MJ097

MJ095

MJ094

MJ093

MJ092

MJ090

MJ091

MJ096

MJ099

TO MJ103

TO MJ100

TO MJ101

TO MJ101

R 19 E  
 R 20 E

APROXIMATIONS ONLY (TYPICAL)

NETWORK  
 BASELINES  
 (TYPICAL)

# GEODETIC CONTROL SURVEY

FOR THE  
BONNEVILLE POWER ADMINISTRATION

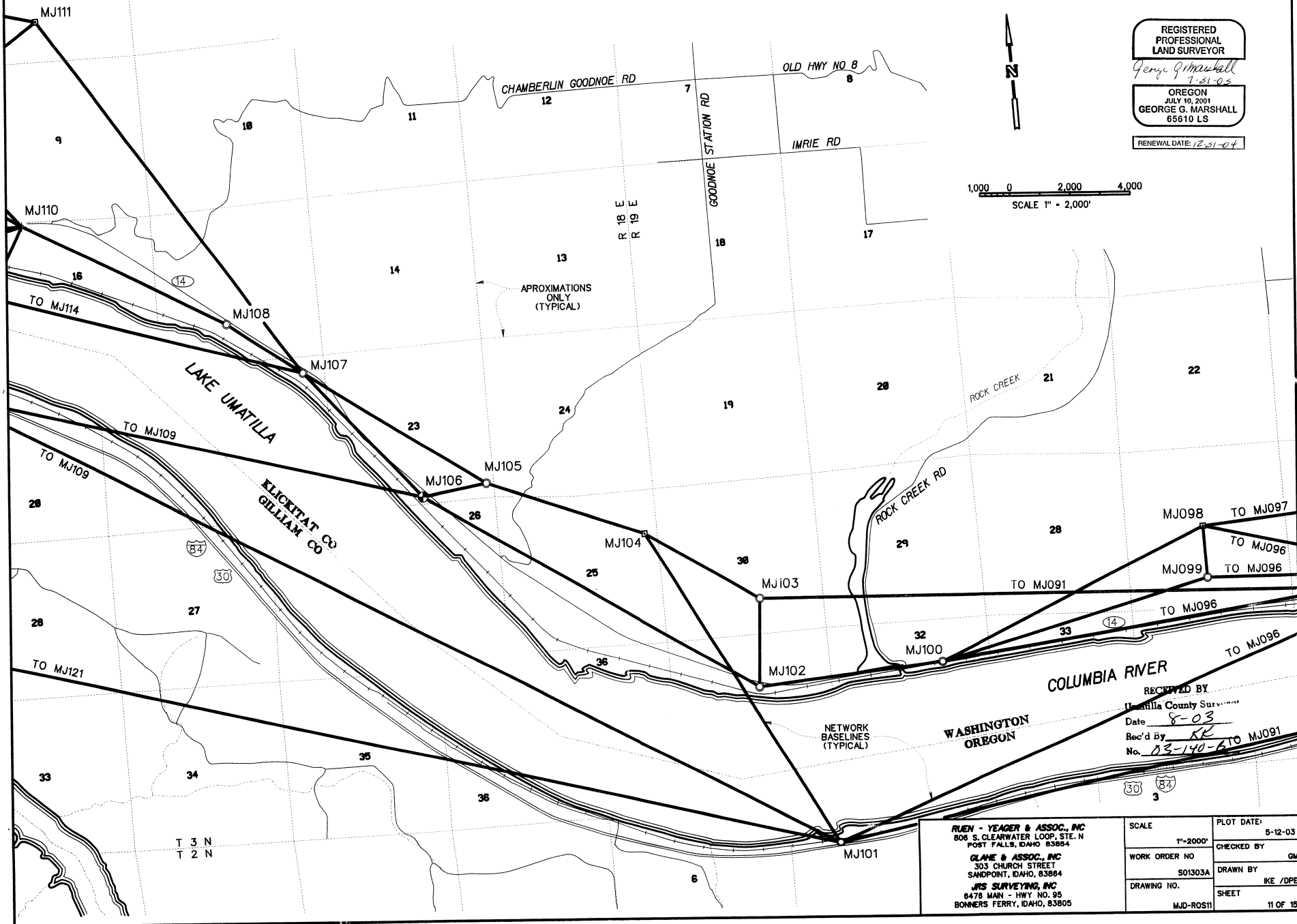

REGISTERED  
PROFESSIONAL  
LAND SURVEYOR  
*George G Marshall*  
7-31-03  
OREGON  
JULY 10, 2001  
GEORGE G. MARSHALL  
65610 LS  
RENEWAL DATE: 12-31-04

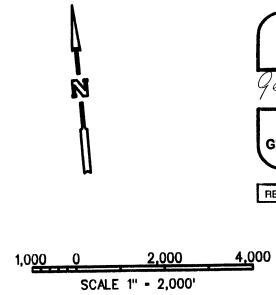

RECEIVED BY  
Umatilla County Surveyor  
Date 8-03  
Rec'd By KR  
No. 03-140-6 TO MJ091

**RUEN - YEAGER & ASSOC., INC**  
806 S. CLEARWATER LOOP, STE. N  
POST FALLS, IDAHO 83884  
**GLAHE & ASSOC., INC**  
303 CHURCH STREET  
SANDPOINT, IDAHO, 83864  
**JRS SURVEYING, INC**  
6478 MAIN - HWY NO. 95  
BONNERS FERRY, IDAHO, 83805

SCALE	1"=2000'	PLOT DATE:	5-12-03
WORK ORDER NO	S01303A	CHECKED BY	GM
DRAWING NO.		DRAWN BY	IKE /DPE
		SHEET	11 OF 15

T 3 N  
T 2 N

**GEODETIC CONTROL SURVEY**  
FOR THE  
**BONNEVILLE POWER ADMINISTRATION**

**REGISTERED PROFESSIONAL LAND SURVEYOR**  
*George G. Marshall*  
7-31-03  
**OREGON**  
JULY 10, 2001  
**GEORGE G. MARSHALL**  
65610 LS  
RENEWAL DATE: 12-31-04

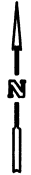

1,000 0 2,000 4,000  
SCALE 1" = 2,000'

APPROXIMATIONS ONLY (TYPICAL)

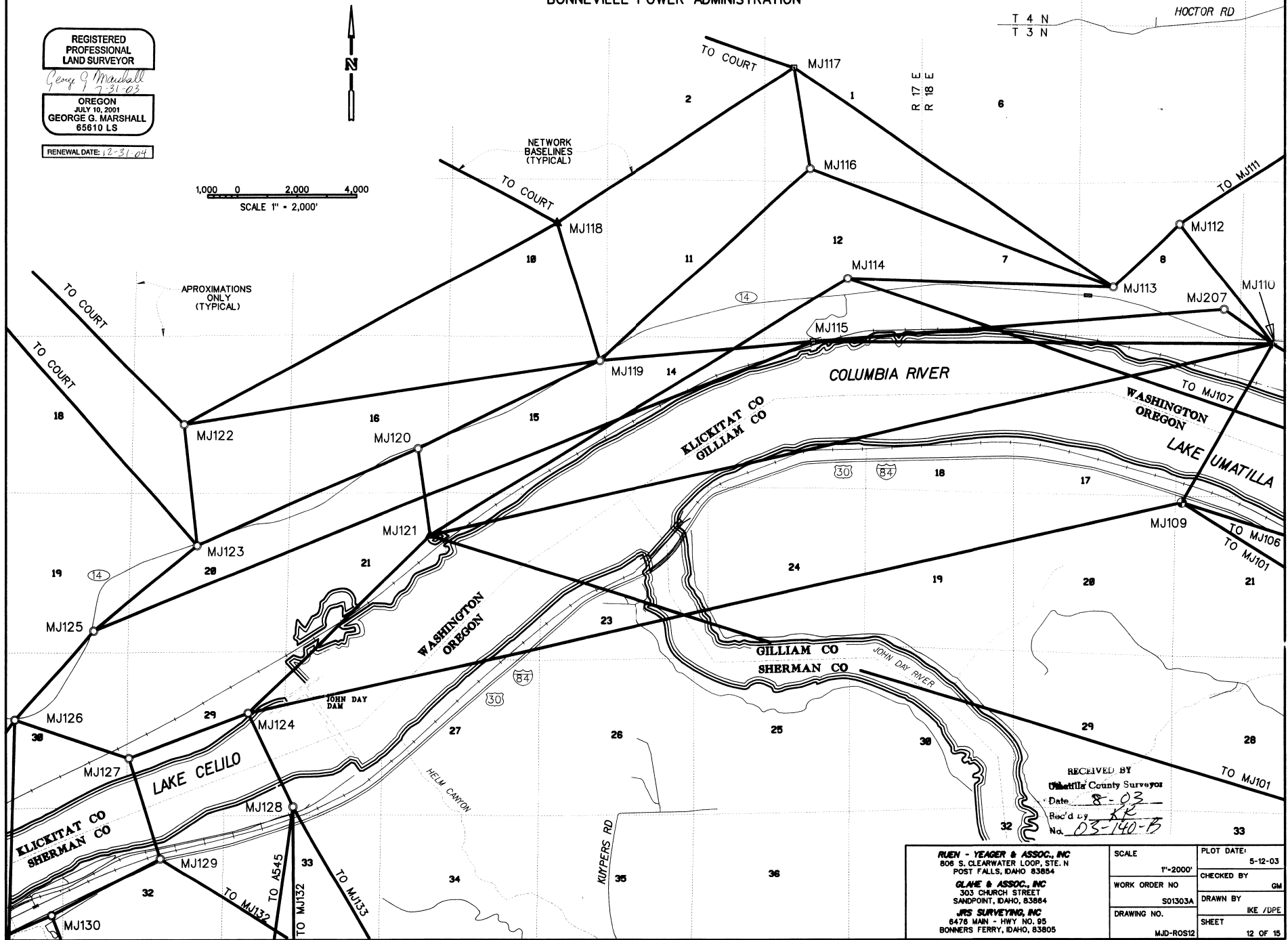

RECEIVED BY  
Umatilla County Surveyor  
Date: 8-03  
Rec'd by: [Signature]  
No. 03-140-B

<b>RUEN - YEAGER &amp; ASSOC., INC</b> 806 S. CLEARWATER LOOP, STE. N POST FALLS, IDAHO 83854  <b>GLAVE &amp; ASSOC., INC</b> 303 CHURCH STREET SANDPOINT, IDAHO, 83864 <b>JPS SURVEYING, INC</b> 6478 HWY - HWY NO. 95 BONNERS FERRY, IDAHO, 83805	SCALE	PLOT DATE:
	1"=2000'	5-12-03
	WORK ORDER NO	CHECKED BY
	S01303A	GM
DRAWING NO.	DRAWN BY	
	IKE /DPE	
	SHEET	
	MJD-R0512	12 OF 15

**GEODETIC CONTROL SURVEY**  
FOR THE  
**BONNEVILLE POWER ADMINISTRATION**

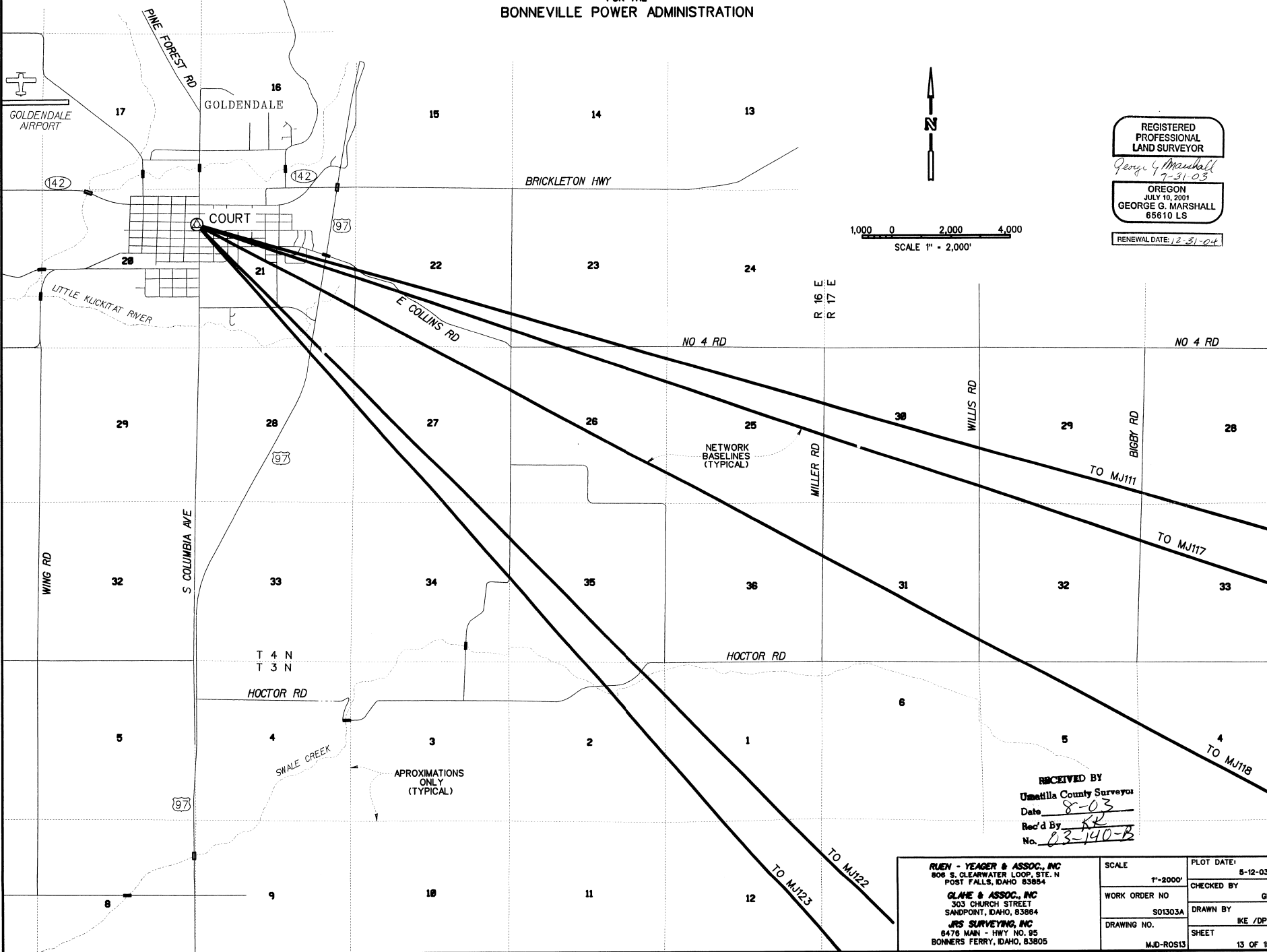

REGISTERED  
PROFESSIONAL  
LAND SURVEYOR

*George G. Marshall*  
7-31-03

OREGON  
JULY 10, 2001  
GEORGE G. MARSHALL  
65610 LS

RENEWAL DATE: 12-31-04

1,000 0 2,000 4,000  
SCALE 1" = 2,000'

RECEIVED BY  
Umatilla County Surveyor  
Date 8-03  
Rec'd By KK  
No. 03-140-B

<b>RUE - YEAGER &amp; ASSOC., INC</b> 808 S. CLEARWATER LOOP, STE. N POST FALLS, IDAHO 83854  <b>GLAVE &amp; ASSOC., INC</b> 303 CHURCH STREET SANDPOINT, IDAHO, 83864  <b>JRS SURVEYING, INC</b> 6476 MAIN - HWY NO. 95 BONNERS FERRY, IDAHO, 83805	SCALE	PLOT DATE:
	1"=2000'	5-12-03
	WORK ORDER NO S01303A	CHECKED BY GM
	DRAWING NO.	DRAWN BY IKE /DPE
	MJD-R0513	SHEET 13 OF 15

**GEODETIC CONTROL SURVEY**  
 FOR THE  
**BONNEVILLE POWER ADMINISTRATION**

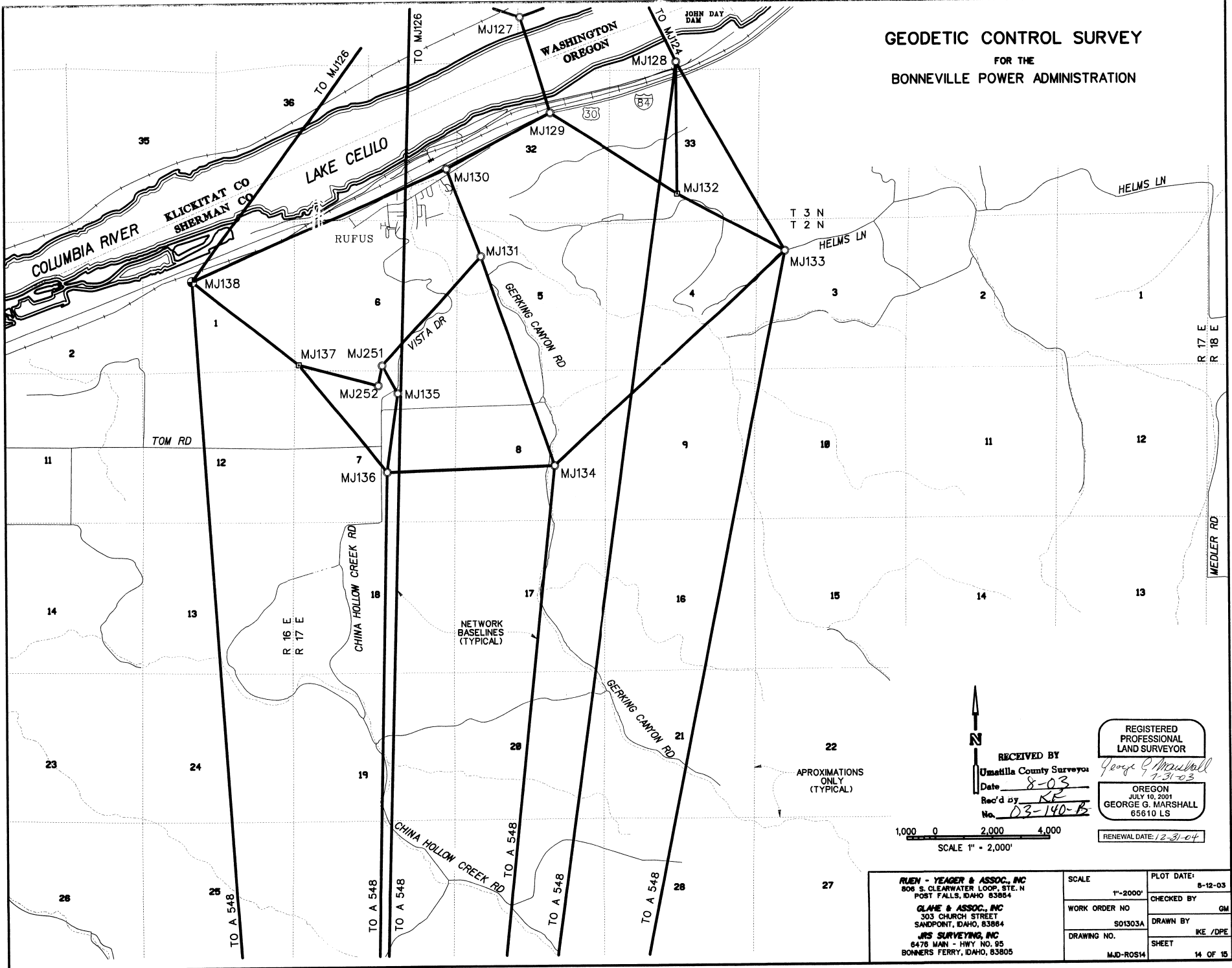

1,000 0 2,000 4,000  
 SCALE 1" = 2,000'

RECEIVED BY  
 Umatilla County Surveyor  
 Date 8-03  
 Rec'd by KE  
 No. 03-140-B

REGISTERED PROFESSIONAL LAND SURVEYOR  
*George G. Marshall*  
 7-31-03  
 OREGON  
 JULY 10, 2001  
 GEORGE G. MARSHALL  
 65610 LS  
 RENEWAL DATE: 12-31-04

APPROXIMATIONS ONLY (TYPICAL)

NETWORK BASELINES (TYPICAL)

RUEN - YEAGER & ASSOC., INC 806 S. CLEARWATER LOOP, STE. N POST FALLS, IDAHO 83864 GLAHE & ASSOC., INC 303 CHURCH STREET SANDPOINT, IDAHO, 83864 JRS SURVEYING, INC 6476 MAIN - HWY NO. 95 BONNERS FERRY, IDAHO, 83805	SCALE	PLOT DATE:
	1"-2000'	8-12-03
	WORK ORDER NO	CHECKED BY
	501303A	GM
DRAWING NO.	DRAWN BY	
MJD-R0514	KE /DPE	
	SHEET	
		14 OF 15

**GEODETC CONTROL SURVEY**  
 FOR THE  
**BONNEVILLE POWER ADMINISTRATION**

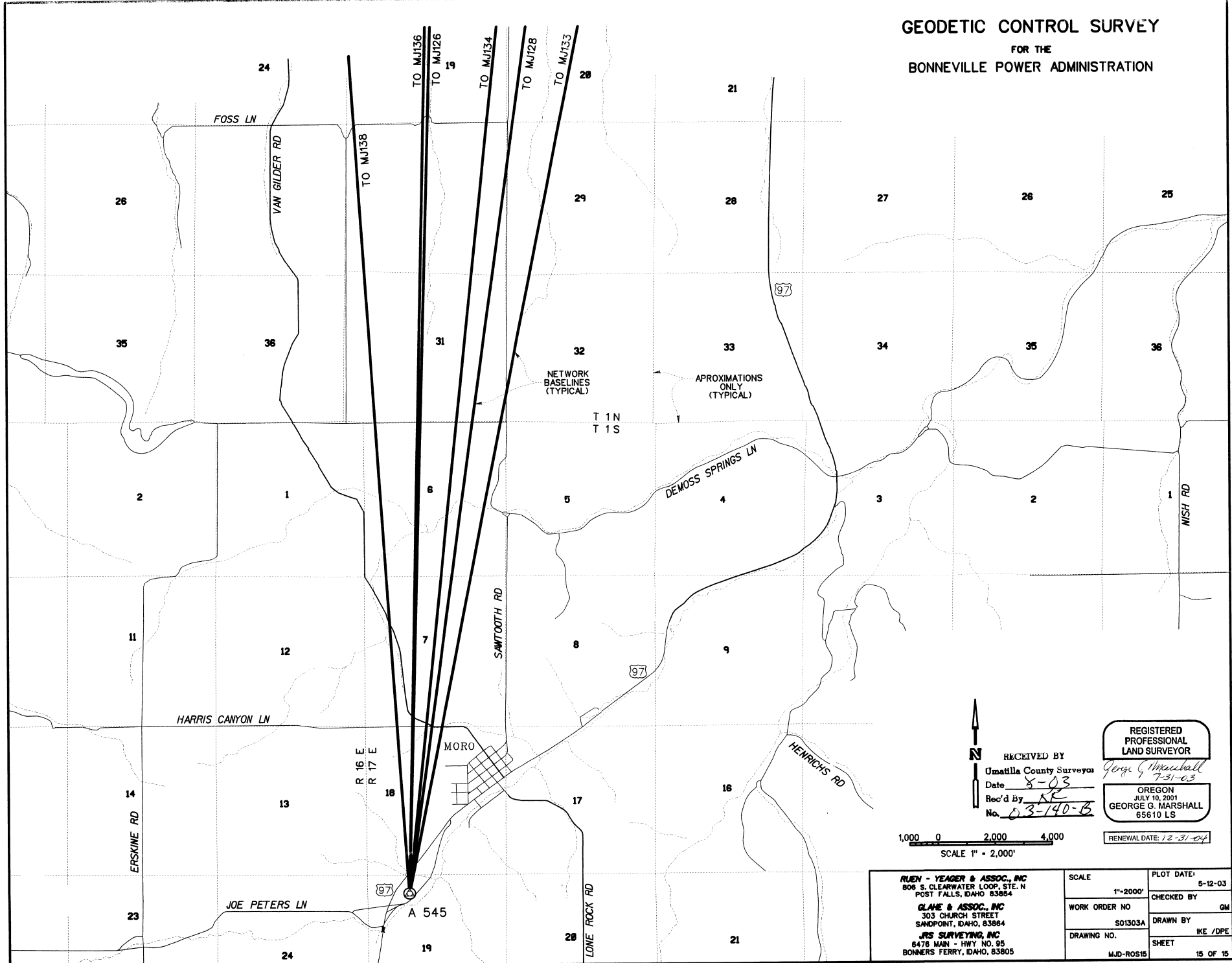

1,000 0 2,000 4,000  
 SCALE 1" = 2,000'

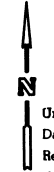

RECEIVED BY  
 Umatilla County Surveyor  
 Date 8-03  
 Rec'd By KE  
 No. 03-140-B

REGISTERED  
 PROFESSIONAL  
 LAND SURVEYOR  
 George G. Marshall  
 7-31-03  
 OREGON  
 JULY 10, 2001  
 GEORGE G. MARSHALL  
 65610 LS

RENEWAL DATE: 12-31-04

**RUE - YEAGER & ASSOC., INC**  
 806 S. CLEARWATER LOOP, STE. N  
 POST FALLS, IDAHO 83854  
**GLANE & ASSOC., INC**  
 303 CHURCH STREET  
 SANDPOINT, IDAHO, 83864  
**JRS SURVEYING, INC**  
 6475 MAIN - HWY NO. 95  
 BONNERS FERRY, IDAHO, 83805

SCALE	1"=2000'	PLOT DATE:	5-12-03
WORK ORDER NO	S01303A	CHECKED BY	GM
DRAWING NO.	MJD-R0515	DRAWN BY	KE /DPE
		SHEET	15 OF 15