

- LEGEND:**
- PLASTIC CAP LS 346 ON 3/4" x 30" PIPE
 - ALUMINUM CAP LS 346 3/4" x 30" PIPE

Narrative:
 The purpose of this survey was to define a 20 acre parcel containing the residence and outbuildings for Donald D. Smith. It was necessary to locate the O.W.R. and N. Company right of way. This line had been abandoned and the rails taken up, however a bridge abutment and 2 cross ties were located. We picked the center of the abutment and the centers of the ties. These bearings came out to be N. 57 12' 08" E. and N 57 11' 50" E; we took an average and called the bearing N 57 12' 01" E.
 The basis for bearings was the line between the Southwest corner of Section 28 and the South one quarter corner of Section 21. This bearing of record was S. 89 34' 00" E. and a distance of 2626.8 feet. The distance we observed between fence corners was 2634.46 feet. In addition there were dead furrows along the fence lines of many years standing, and until recently there had been different ownerships along the line. We accepted these fence corners as being the true corners.

LEGAL DESCRIPTION

A tract of land in the Northeast one quarter of Section 28 and the Southeast one quarter of Section 21, more particularly described as follows:

Commencing at the South one quarter corner of Section 28 and running thence North 20°44'19" East a distance of 4905.16 feet to the true point of beginning for this description; thence North 48°57'16" West a distance of 941.51 feet to a point on the Southerly right of way line of the Oregon Railroad and Navigation Company; thence North 57°12'01" East along said southerly right of way line a distance of 1369.29 feet; thence South 32°47'53" East a distance of 459.08 feet; thence South 35°36'32" West a distance of 677.26 feet; thence South 34°52'58" West a distance of 516.25 feet to the point of beginning and consist of 20.0 acres.

Together with a 20 foot wide access easement, beginning 10.00 feet on either side of the following described center line:

commencing at the South one quarter corner of Section 28 and running thence North 45°04'14" East a distance of 3731.20 feet to the Northern terminus of County Road number 793, which is the true point of beginning for this description; thence North 1°03'16" East, 311.82 feet; thence North 0°33'20" East, 324.39 feet; thence North 0°47'38" East, 358.04 feet; thence North 0°55'29" East, 177.47 feet; thence North 4°34'02" West, thence 101.33 feet; 51°38'36" West, 78.14 feet; thence North 59°18'35", 437.49 feet; thence North 57°20'09" West, 122.27 feet; thence North 54°00'04" West, 92.69 feet; thence North 1°14'29" West, 62.63 feet; thence North 47°42'49" West, thence North 20°46'21" West, 79.84 feet; thence North 1°48'48" West, 40.96 feet.

All being in Township 3 North, Range 33 East of the Willamette Meridian, County of Umatilla, State of Oregon.

TERMINUS OF COUNTY RD #793(498)

R/W DATA

13-14	N 1°08'16" E	311.82'
14-15	N 0°33'20" E	324.39'
15-16	N 0°47'38" E	338.04'
16-17	N 0°55'29" E	177.47'
17-18	N 4°34'02" W	101.33'
18-19	N 29°03'32" W	72.99'
19-20	N 51°38'36" W	78.14'
20-21	N 59°18'35" W	437.49'
21-22	N 57°20'09" W	122.27'
22-23	N 54°00'04" W	92.69'
23-24	N 51°14'29" W	62.63'
24-25	N 47°42'49" W	113.82'
25-26	N 41°10'58" W	91.66'
26-27	N 20°46'21" W	79.84'
27-28	N 1°48'48" W	40.96'

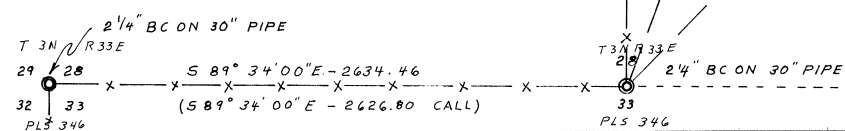

REGISTERED PROFESSIONAL LAND SURVEYOR
 Wayne O. Harris
 Oregon
 1917 & 1933
 WAYNE O. HARRIS
 346

WAYNE HARRIS CO. INC.

BOUNDARY LINE ADJUSTMENT FOR DONALD D. SMITH IN SEC. 21 & 28 T. 3N. R. 33E. W.M.

DATE 2-17-92
 SCALE 1" = 400'
 DRAWN BY WHH

FILE _____
 JOB _____
 DRAWING NO. 92-3C