

60

60

60

N. W. Gilliam Ave.

N. W. 4th St.

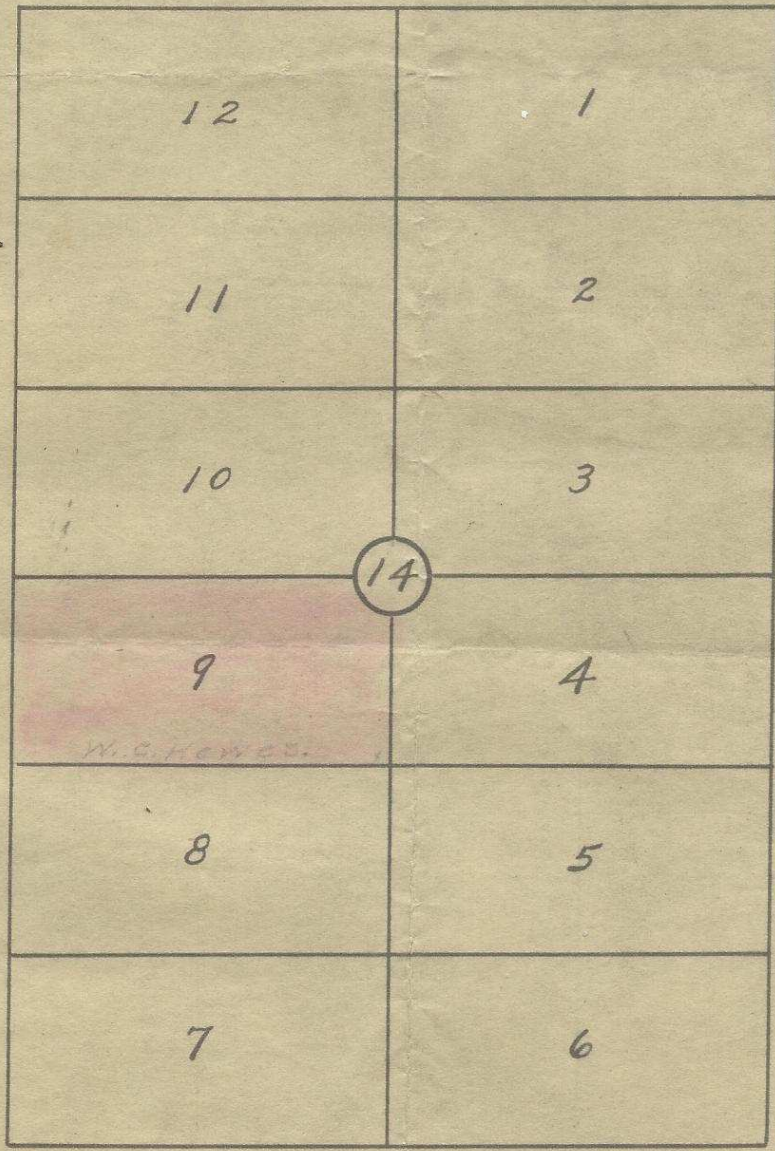

N. W. 3rd St.

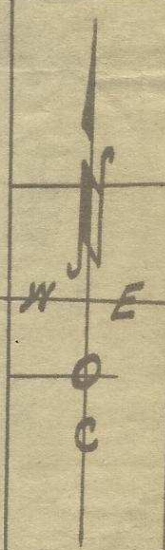

N. W. Furnish Ave.

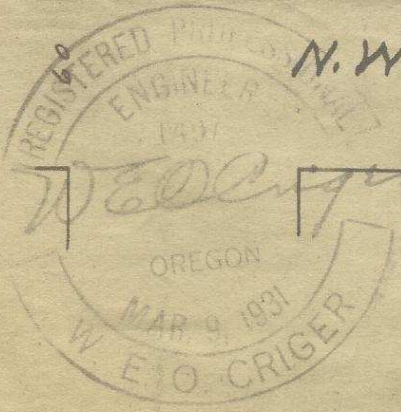

2 N 32 3 DD

Plat showing
 Block 14 of Livermores' Add'n
 To the town, now city of
 Pendleton, Oregon.
 (lot 9) surveyed, staked, and platted
 Feb. 1949 - By W.E.O. Criger.
 Scale: 1 inch = 50 Feet.

06-181-Ax