

RECEIVED BY
 Umatilla County Surveyor
 Date: 2/21/13
 Rec'd By: J. Roberts
 No.: 13-074-A



Map Showing
 Section of Byers Addition in City of
 Pendleton, Oregon, and in the vicinity of
 Washington School. Shaded portions
 indicates streets closed by City Ordinance
 No. 1629.

Scale 1"=100ft.
 Dec. 6.-1934.

2N 32.02.D.

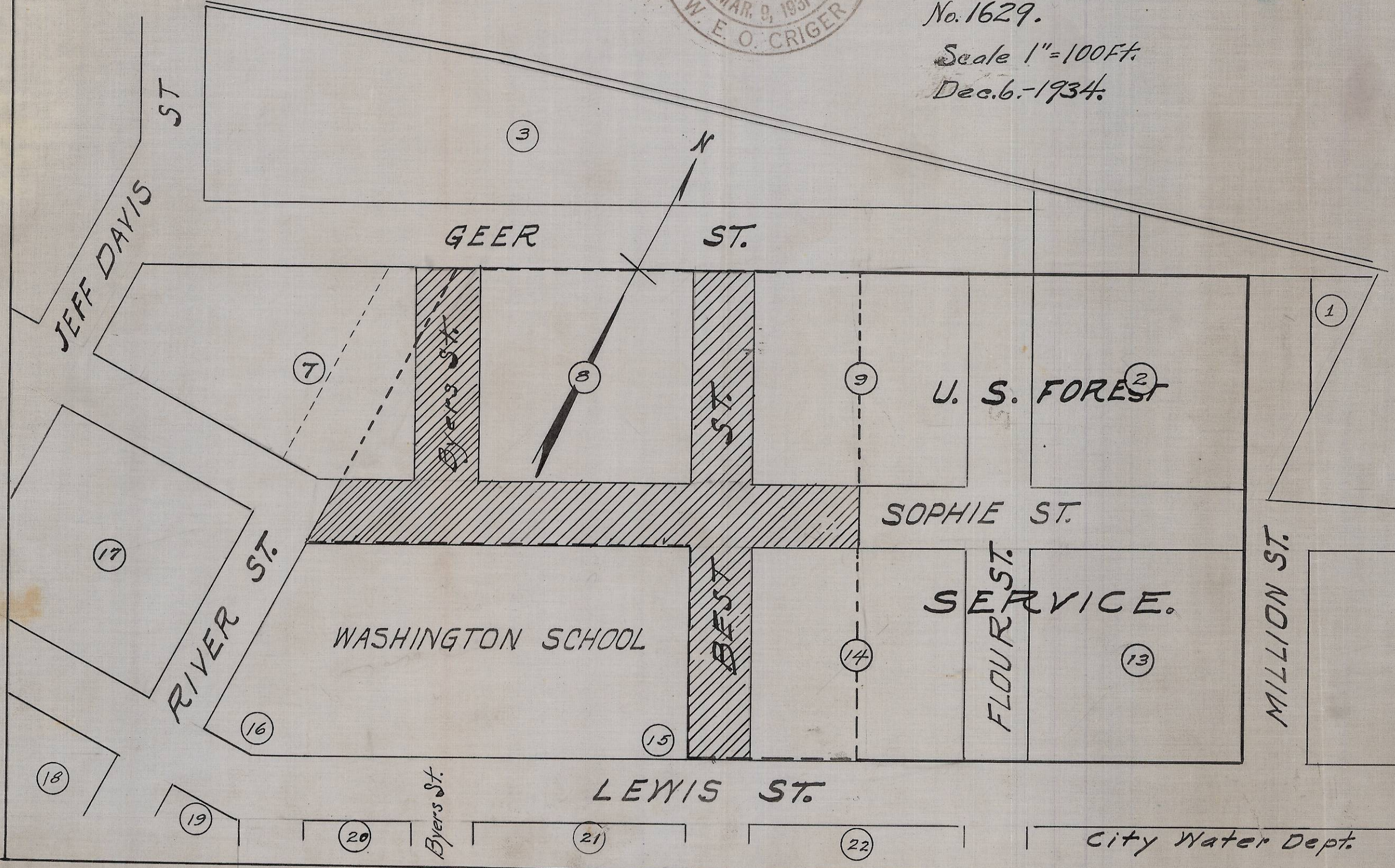

City Water Dept.