

4N3519CA

1700
 29-1

FOURTH ST.

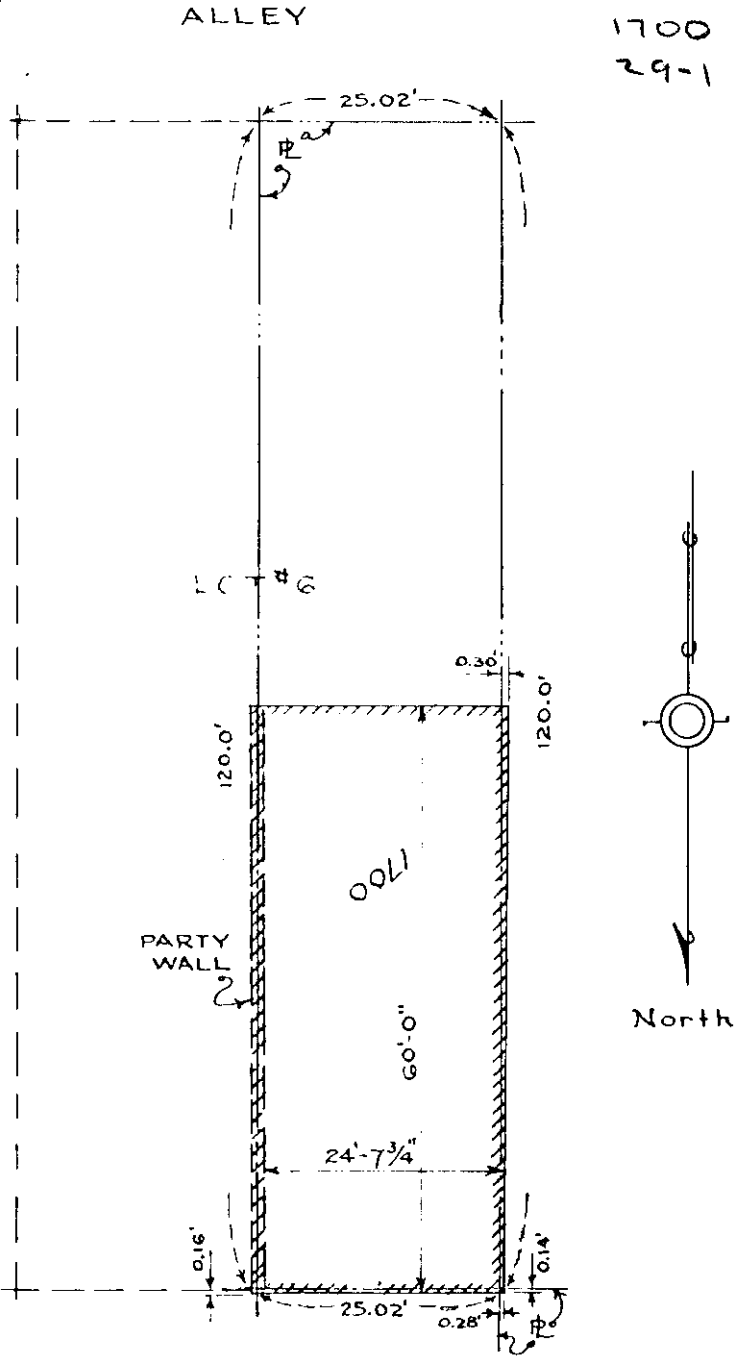

MAIN ST.

UMATILLA COUNTY
 Athena R.E. #021
 (Formerly Athena R.E. #1)

CENTRAL ASSESS.
 1/1/52
 ORDER U52-34.

WEST HALF OF LOT 6, BLOCK 3, CITY OF ATHENA.

R.E. #021

THE PACIFIC TEL. & TEL. CO. OFFICE OF CHIEF ENGINEER PORTLAND		DRAWING	AO-300
		SCALE	1" = 20.0'
MAIN OFFICE ATHENA OREGON	DRAWN BY		<i>[Signature]</i>
	APPROVED		<i>[Signature]</i>
SITE PLAN			

RECEIVED BY RE-021.

Umatilla County Surveyor

Date 1985

Rec'd By *[Signature]*

No. 85-1-A