

Report of Viewers. Field Notes and Plat of Survey of a County Road  
from Alba Cabin to John Day.

Alba Umatilla Co. Or. Oct 1<sup>st</sup> 1883

To the Hon County Court of Umatilla County. Oregon

We the undersigned having been appointed to view and locate a route for a County road, from the old Alba Cabin on Camas Creek, to intersect the road running North from Duffys Spring at the Grant County line, met as ordered by your Honorable body, on the 24<sup>th</sup> day of Sept 1883, after being duly qualified by W. W. Caviness, Surveyor, we called to our assistance R. B. Huston and Charles Vinson, Chaimmen and Daniel Remings, marker, with W. W. Caviness Surveyor, we viewed, located and surveyed the route as follows to-wit:

Beginning at the terminus of the County road on the North bank of Camas Creek and running in a Southerly direction and crossing Bridge Creek about one mile above the old Susanville trail and striking the slopes of the John Day at the head of Terrel Canyon, about nine miles from starting point, thence down Terrel Canyon about one mile to John Day River, thence West one and a half miles, crossing John Day river at the mouth of Desolation Creek, thence turning in a Southwesterly direction up Meadow Creek leaving Meadow Creek at a point about two miles from the crossing of John Day River and turning West about one mile to the dividing ridge between Meadow and Campbell Creeks, thence in a Southwesterly direction following these dividing ridges to the slopes of Fisher Creek, about four miles from the terminus of the route. Thence down Fisher Creek intersecting the Duffys Springs road at the Grant County line near Fisher's house, total distance from Camas Creek to the Grant County line by this proposed route, twenty five miles.

This is without doubt the most practicable route for a County road from Alba Cabin to Canyon City and can considering its importance, be made passable for teams at a small expense to the County. Therefore we earnestly and respectfully recommend that your Hon body take immediate steps to have this route opened up and made a good practicable wagon road.

E. Bristow }  
Jas Ripkey } Viewers.  
Wm Howard }



## Road No. 143.

To the Hon County Court for Umatilla County, Oregon

I hereby certify that on the 24<sup>th</sup> day of Sept. A.D. 1883 after qualifying Messrs W<sup>m</sup> Howard, James Rippey & E. Bristow as Viewers & R. B. Huston & Chas Vinson as Chainmen & Daniel Kemmons as Marker, under direction of Viewers W<sup>m</sup> Howard, James Rippey & E. Bristow, I proceeded the survey of a County road for the above named County & State as described in the accompanying field notes of Survey.

Beginning at the Alba Cabin at stake marked R set stake marked R, run South 46 Rods, thence South 15° East 20 Rods, thence South 234 Rods set post marked one mile, thence South 20° West 46 rods, thence South 30° East 26 rods, thence South 5° West 88 rods, thence South 30° East 160 rods set Rock marked 2 miles, thence South same degree 320 rods marked Tree three miles, thence South 15° West 320 rods marked stake 4 miles, thence South 15° E. 320 rods set Stone marked 5 miles, thence South 30° West 320 marked stake 6 miles, thence South 45° West 70 rods, thence South 30° East 250 rods marked tree 7 miles, thence South 40° West 320 rods marked rock 8 miles, thence South 200 rods to head of Terril Canon, thence South 30° East 120 rods marked rock 9 miles, thence South 160 rods, thence South 45° West 14 rods, thence South 80 rods, thence South 40° West 26 rods to the John Day River, thence West down John Day River 40 rods marked Tree 10 miles, thence West 30° South 60 rods, thence West 100 rods, thence West 30° South 160 rods marked Tree 11 miles, thence West 40° South 80 rods, thence West 10° South 80 rods to the River, thence South 14 rods crossing river, thence West 46 rods, thence South 40° West 34 rods, thence South 30° East 52 rods, thence West 40° South 14 rods to meadow creek set post marked 12 miles, thence West 40° South up meadow creek 38 rods, thence South 20° East 54 rods, thence West 40° South 228 rods marked post 13 miles, left meadow creek thence West 320 rods marked Tree 14 miles, thence South 15° West 320 rods marked Tree 15 miles, thence West 40° South 320 rods marked post 16 miles, thence West 25° South 320 rods marked tree 17 miles, thence West 40° South 140 rods, thence West 18 rods marked Tree 18 miles, thence West 100 rods, thence South 35° West 100 rods, thence West 70 rods, thence West 40° South 50 rods marked Tree 19 miles, thence West 40° South 320 rods marked Tree 20 miles, thence South 40 rods, thence South 40° West 144 rods, thence West 136 rods marked Tree 21 miles, thence West 248 rods, thence South 20° West 72 rods marked post 22 miles, thence South 20° West 26 rods, thence West 126 rods, thence West 30° South 168 rods marked Tree 23 miles, thence West 35° South 26 rods, thence West 60 rods marked post 24 miles, thence West on South side of Fisher Creek 170 rods, thence West 20° South 150 rods to County line between Umatilla



to Grant Counties marked road 25 miles.

Field notes of survey from Alba Cabin to Grant County line by.

W. W. Caviness,

Surveyor

This the 29<sup>th</sup> day of Sept A.D. 1883.

Intersection of Road Survey on line between Umatilla and Grant Counties

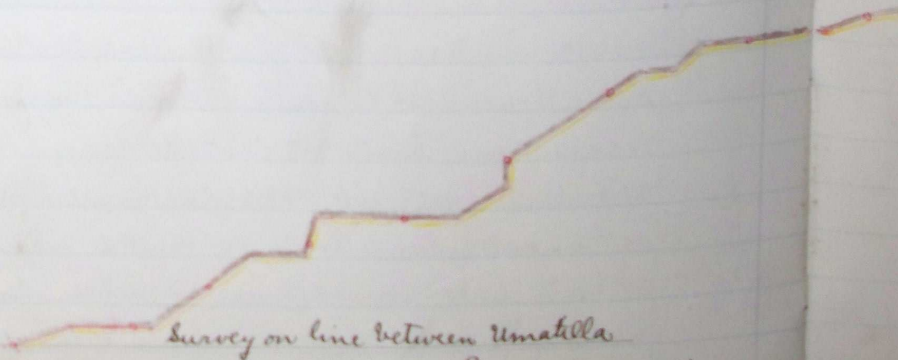



Camas Creek

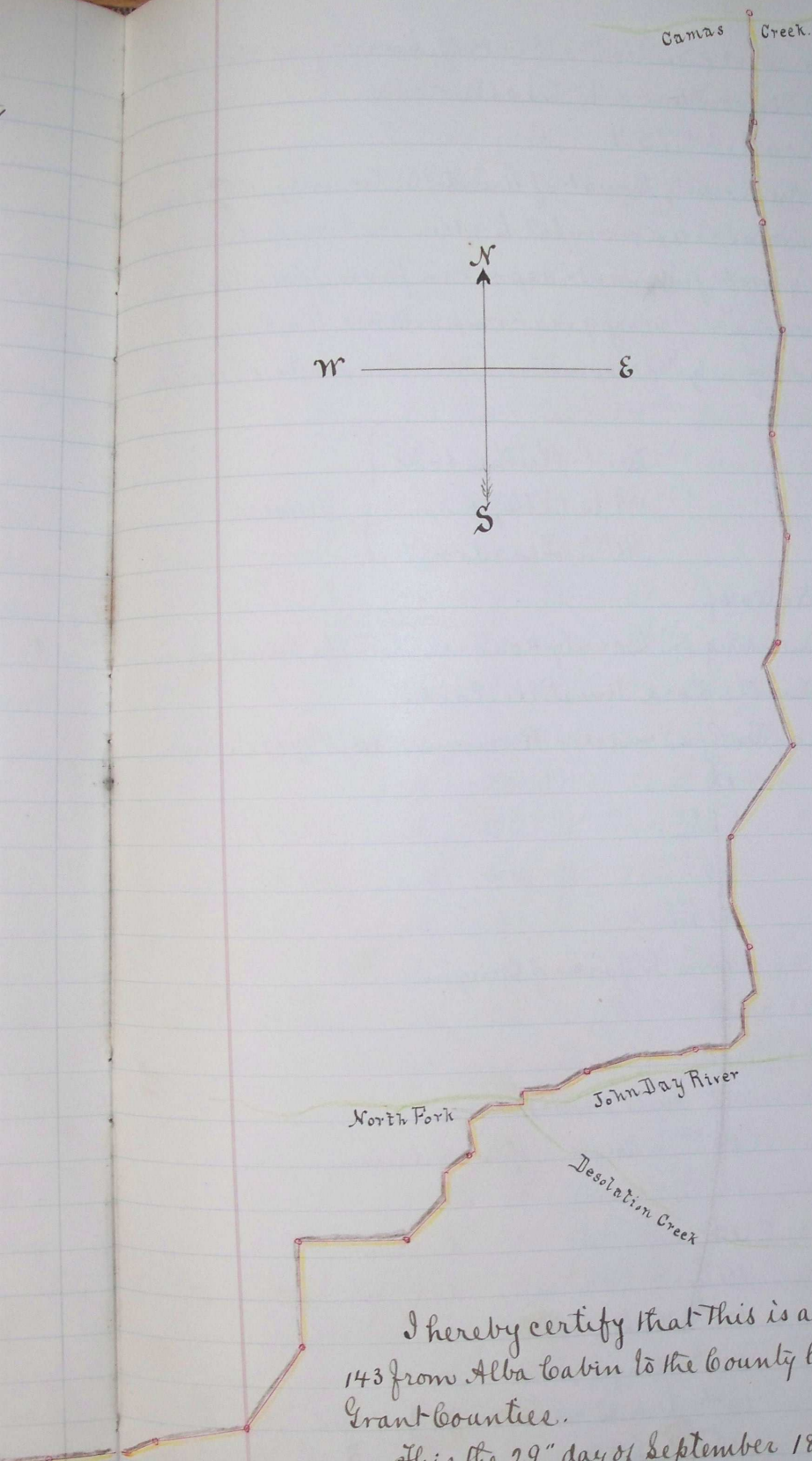
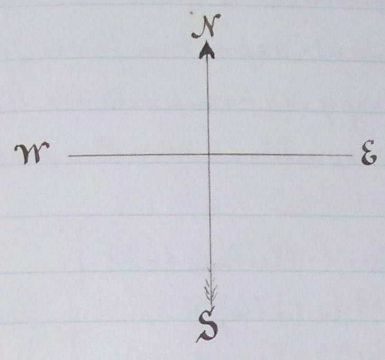

I hereby certify that this is a true Plat of road survey No 143 from Alba cabin to the County line between Umatilla and Grant Counties.

This the 29<sup>th</sup> day of September 1883.

W. W. Caviness  
Surveyor

Journal E. pages 630731  
 " F " 44745  
 " F " 239.

Recorded Feby 12<sup>th</sup> 1884

J. P. Bushee  
Clerk