

Road 338.

ROAD NO
338.

Report of Viewers, field notes and plat of Survey of bounty Road No 338 commencing at the intersection of the present bounty Road and Camas Creek S.W. corner of D.E. 1/4 of Section 4 T.P. 5 S.R. 32 E.W.M. thence following a South Easterly direction by the most practical route to the Section line between Sections 9 & 10 in said Township & Range thence South to the 1/4 mile stone between Sections 15 & 16 in the above named Township & Range thence South East to the North West corner of D.E. Clark's homestead thence South one half mile, thence South West to the 1/4 mile stone between Sections 21 & 22 in the above named Township & Range, thence South one half mile to the S.E. corner of Dec 21 T.P. 5 S.R. 32 E.W.M.

To the Hon County Court
Umatilla County, Oregon

We the undersigned, viewers on Road Survey No 338 would respectfully report that we met Jno C. Arnold Surveyor at the time and place appointed for the same and were each qualified according to law.

We called Edgar Thomson and S. M. McReynolds to chain and mark and D.E. Clark a man who were each duly qualified.

We viewed out and surveyed said Road 338 as specified in our order for the same and find the route to be very practicable and almost an absolute and imperative demand for a road operating as an outlet for the settlers in the vicinity of Road 338. Roads are few and trails have been opened and worked voluntarily so as to make them passable but the land over which they have been laid have subsequently been claimed and fenced and this means of travel practically ended.

We would therefore recommend that said road No 338 be declared a public highway.

Witness our respective hands at Alba this 30th day of July A.D. 1890

W. O. Mettler
Rod M^c Donald
J. H. Clifflord

Filed July 7. 1890 }
J. A. Hartman clerk

Dick
bount
Dm
place
the u
and
nald
law.
grad
of De
south
Dm
315
389
S 46° 13' W
518° 31' E
562
277° 14' E
584
654
841
S 86° 46' E
1678
S 45° 26' E
2046
2320
S 22° 35' E
3000
3758
11220
South
5120
5260
7140
5133
5280
843° 36' E
1766
7169
South
7660
5385
95
S 50° 20' W
744
S 78° 12' W
1195
S 87° 27' W
1561
N 76° 53' W
1974

Field Notes of Road Survey no 338 for Multnomah County Oregon.

I met full board of viewers on R 338 at time and place appointed for the same, and administer to each the usual form of oath. We call Edgar Thomson and D.E. Clark to chain and mark and L.M.M. Reynolds as assessor and qualify each according to law. I commence at a pt on R 241 on foot of steep grade on E side of Lewis Creek in SW 1/4 of D & 1/2 of Dec 4 & 5 O.R. 32 & and on var 200' - initial post 45' South of foot of grade and 110' E of Lewis Creek. I run from said initial post.

S 46° 18' W	315	Center of Lewis Creek course S 57° W 50' wide
	389	Set angle post - cut A on alder in bunch on S side of Creek and turn
S 18° 31' E	562	Set angle post, and turn.
N 76° 14' E	584	Foot of grade ascend,
	650	Head " " less ascent.
	841	Set angle post and turn,
S 86° 46' E	1678	But A on S side of Pine stump 14" high 2" dia and turn
S 45° 26' E	2046	Pine tree 20" dia on line, notched 3 notches in line
	2370	Set angle post about 25' E of Pine grove, and turn.
S 42° 35' E	3000	Summit
	3758	Large pine, 18" dia, notched on opposite sides 3 notches but A on West side
	4120	Intersect line bet Dees 9 & 10 set angle post in mound with pits and turn.
South	5120	1/4 Dec Cor bet Dees 9 & 10 continue on Dec line
	5280	Set 1 M.P. 20' E. of line " " " "
	7440	Cor for Dees 9 & 10 - 15 & 16 " " " "
	8133	" " 1/4 Dec bet Dees 15 & 16 " " " "
	8280	Set 2 M.P. 20' E of line but A on mile post & turn
S 43° 36' E	1266	" Angle post in mound and turn
	7869	Cor fences S & W. on West side of E end of lane 20' wide course N & S. cut A on cor post and turn
South	7660	Rainie 25' wide runs NW rocky.
	8385	Cut 11 M on on a porous basalt rock in place 48 x 30 x 20 ins.
	95	S end of lane cut A on cor post fences N & W. on west side of lane and turn.
S 50° 20' W	7444	Set angle post in traveled road and turn.
S 76° 12' W	1195	" " " " " "
S 87° 27' W	1561	" " " " " "
N 76° 53' W	1924	" " " " " "

S 85° 37' W	2274	
N 70° 48' W	2466	Set angle post on flat E of Pine creek and turn
S 13° 58' E	3024	" " " in traveled road and turn
S 9° 32' W	3065	Pine Creek 50' across course NW ascend,
	3273	Set angle post and turn,
N 81° 43' W	3454	" " " on Summit and turn,
S 65° 02' W	3860	bor for 1/4 Dec bet Decs 21 & 22 log fence N. & S. Cut A on fence at cor and turn on Dec line
South	5280	Set 4 m P. 20' E of line
	1160	" terminus post in mound.

Whereby certify that the foregoing is a true copy of the original notes of the survey of R No 338 for Umatilla County Or

Jno Arnold Surveyor

Filed July 10-1890
W.M. Pierce Clerk

Whereby certify the following to be a correct plat of the survey of Road No 338 Township 5S Range 32 East of Willamette Meridian as made by me July 12-30, 1890

Jno Arnold
Surveyor for Umatilla Co. Or

5 S. 32

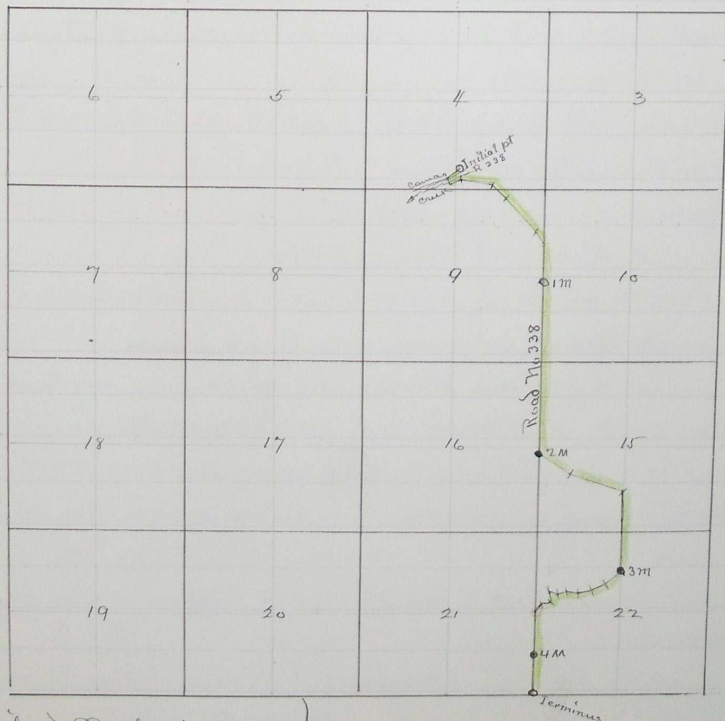

Filed July 10-1890
W.M. Pierce Clerk

July 16 1890 H 573

ROAD No 338
Report
County
County
at the st
ning N
1/2 of Dec
ships 4
East on
of the U
line be
the S & E
on the l
50 m
N & cor
Do the st
Umatilla

viewers
Or wo
Jno C
appor
qualifi
aid Edg
were e
wo view
as prac
find the
outlet
to the f
upon S
lines.
repair.
road roa
Umatilla
day of
Build July
S. Hartman
Field state
D met
Road