

ROAD NO

Road No 297

297

Report of Viewers. Field Notes and Plat of Survey of a County Road beg at a point 80 rods E. of the 1/4 Sec. cor. on the line between Sec's 33 & 34 T<sup>4</sup> S. R. 31 E. terminating at Broad Street in Town of Alba.

Report of Viewers

To the Honorable County Court for Umatilla County, Oregon.

We the undersigned, your viewers appointed to view and report on the advisability of establishing a County road as prayed for by the petition of W. O. Metteer and others. viz, Road No 297, now ask leave to report that we have carefully examined the route as shown by the accompanying plat and find it practical for a road, and we recommend that a county road be established there for the following reasons, 1<sup>st</sup> Alba is the Post Office for this valley, 2<sup>nd</sup> Precinct elections are held there, 3<sup>rd</sup> It is the trading point for the valley, 4<sup>th</sup> A church, a saloon, a prohibition club, a race track and other attractions are located there, and an open highway is needed by everybody to go and come, 6<sup>th</sup> There is at present no county road in that direction. Finally, The increased population and produce require an open road there. For the above reasons we recommend that a county road be established there. All of which is respectfully submitted.

Dated, Alba, Umatilla Co. Oregon. Aug 15<sup>th</sup> 1887.

J. W. Collins  
Wm McKenryolds  
J. Sturdivant } Viewers

Field notes of road survey No 297.

Commencing Eighty rods East of the 1/4 post between Sections 33 & 34 Town 4 South, Range 31 East of W. M.

	Course	chains	Angle	mile
Thence	E	15.20	A	
"	N 44° E	46.92	A	
"	N 17 E	53.24	A	
"	E	63.40	A	
Bearing tree	N 35 W	.39		Pine 8. inches
Thence	N 3 W	75.05	A	
B "	W 17 S	.19		" 20 "
Thence	E 20 N	78.12	A	
B "	W 7 S	35		" 5 "
Thence	N 8 W	80.		Set mile post
B "	E 35 S	.27		Pine 28 inches
B "	W 9 N	64		" 22 "
Thence	N 8 W	.38	A	
B "	N 14 E	.52		" 18 "

is N 24° W  
Tps 3 & 4  
ench  
correct.  
r.

to fore-  
to of County  
Surv.

Thence	E 10 N	2.00 A	
B "	E 35 N	.12	Pine 18 "
Thence	S 35 E	4.42 A	
B "	S 12 W	.7	" 8 "
Thence	E 9 N	5.57 A	
B "	S 19 E	.26	" 8 "
Thence	E 20 S	7.68 A	
"	N 6 E	16.50 A	
"	N 33 E	22.12 A	
"	E 3 S	28.46 A	
B "	W 22 N	.12	" 6 "
Thence	N 40 E	40.5 A	
Bearing tree	W 28 S	.32	Pine 12 inches
Thence	E 35 N	45.94 A	
B "	W 3 N	.23	" 16 "
Thence	N 7 E	80.00	2 Set mile post
"	N 7 E	11.15 A	
B "	N 38 E	.14	Pine 20 in'
Thence	N 1 E	51.50 A	
"	N 29 E	57.2 A	
B "	E 2 S	.37	" 26 in
Thence	N 7 W	62.18 A	
B "	N 30 W	.52	" 10 "
Thence	N 33 E	67.7 A	
B "	E 24 N	.31	" 12 "
Thence	E 22 N	70.67 A	
"	E 9 N	80.	3 Set mile post
Bearing "	N 25 E	.38	Pine 14 in'
"	N 24 W	.57	" 24 "
Thence	E 9 N	.68 A	
B "	N 25 W	.4	" 24 "
"	S 4 W	.9	" 24 "
Thence	E 22 N	4.68 A	
B "	E 20 S	.14	" 16 "
Thence	E 2 N	21.20 A	
B "	E 37 S	.51	" 6 "
Thence	E 20 N	29.62 A	Intersecting the road line from B. W. Bolin's to Hawn's Guyers Sawmill. Road N <sup>o</sup> 301
Thence	N 21 E	35.62 A	
"	N 32 E	41.12 A	
"	E 11 N	57.90 A	
Bearing "	S 13 E	.20	Pine 8 inches
Thence	N	58.50	to the 6 <sup>th</sup> mile post on Road 301. A Pine three 6 inch ends

Thence	N		2.23	A.
"	E	18	9.85	To Pine Street Alba
"	"	"	27.55	" Penoyer " "
"	N	"	30.70	" Wager " "
"	E	"	35.18	To Broad " "

I hereby certify that the foregoing are the field notes of road survey N<sup>o</sup> 297 as made by myself Aug 2<sup>nd</sup> 45<sup>th</sup> 1887  
 La. F. Knight, Surveyor  
 Alba Umatilla Co. Or, Aug 10<sup>th</sup> 1887.

Plat of Road N<sup>o</sup> 297

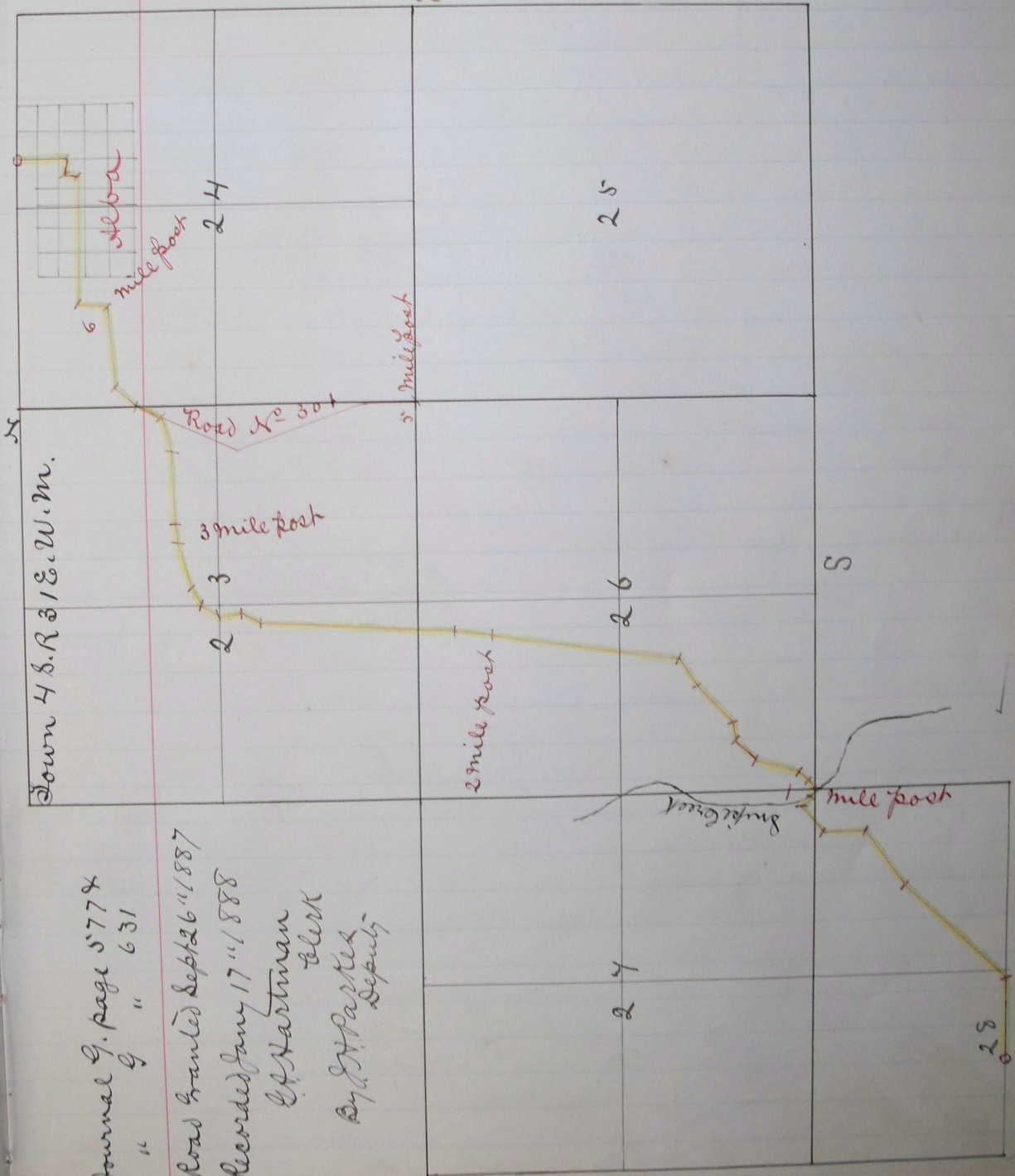

Journal G. page 5774  
 " " 631  
 Road granted Sept 26<sup>th</sup> 1887  
 Recorded Jan 17<sup>th</sup> 1888  
 L. Hartman Clerk  
 By J. H. Partles Deputy

m B. W.  
 Road N<sup>o</sup> 301

three benches