

Report of Viewers. Field Notes and Plat of Survey of a County Road from a point where Co Road from Bendleton to Vinsons ^{and} Intersect Co Road from Lees to Pilot Rock Road No 210.

Report of Viewers.

To the Hon County Court for Umatilla County, Oregon.

We the undersigned, viewers on County Road No 210, would most respectfully report, that we met with Jno C. Arnold, Surveyor, on the 23rd day of August A.D. 1884, and after qualifying and proceeding as far as, at that time, was possible, with the work assigned us by your Hon. body, we adjourned until the 28th day of August, when calling to our aid Lincoln Jay and Cha^s Stover as Chaimen and Lincoln Jay as marker, who were each qualified for their respective duties, we proceeded to view out, survey and locate said road No 210 as prayed for in petition. We find the route to be quite a practical one, surface of the ground, in general, comparatively even, and the road much demanded, the cost of opening and keeping in repair said road will be but nominal, we therefore recommend that said road be granted a public highway.

Witness our hands.

Henry Stover } Viewers
W^m Lee }

Field Notes of the Survey of County Road No 210, Survey adjourned from Aug 22 to Aug 28/1884

I set round fir post 5 1/2 inches in d. marked R on N, in mounds about 30 feet S. E. of the point on line bet. Secs 4 & 9 T 1 S. R. 31 E. Crossed by road leading from Lees crossing on Birch Creek to Heppner, and assuming a var. of 20° E. with a Mason Theodolite I run East 16.16 chains 1/4 S. Cor. bet. Secs 4 & 9 T 1 S. R. 31 E. 55.50 chains Cor. for Secs 3, 4, 9 & 10. 80.00 chains set 1 m. post about 30 feet N. of R.C. (road center) 76.00 chains cross ravine N. of M.E. Folsoms ranch. ascend. 80.00 chains set 2 m. post about 30 ft. N. of R.C. ascend. 10.15 chains 1/4 S. Cor. bet. 2 & 11 ascend. 34.40 chains cross wire fence. ascend. 45.00 chains, summit. 80.00 chains set 3 m. post about 30 feet N. of R.C. 10.40 chains 1/4 S. Cor. bet. 1 & 12. 50.40 chains Gov. Cor. for Secs 1, 6, 7 & 12 on T. line bet ranges 31 & 32 East. 68.30 chains cross ravine. ascend. 80.00 chains set 4 m. post about 30 feet N. of R.C. 15.10 chains 1/4 S. Cor. bet 6 & 7 T 1 S. R 32 E. 50.40 chains Gov. Cor. for 5, 6, 7 & 8 T 1 S. R. 32 E. 80.00 chains set 5 m. post about 30 feet N. of R.C. 10.60 chains 1/4 S. Cor. bet. 5 & 8. 29.50 chains intersect road leading to Pilot Rock, course about South 5° East. set round fir post 5.5 in in d. about 40 feet N.W. of R.C. The road center is distinctly marked by furrows running from one section corner to another, the route is comparatively even and over land free from steep hills and rocks. All the posts used were of the size required by law and were correctly marked and set in mounds. Survey commenced Aug 22nd and adjourned to and completed Aug 28th 1884.

I hereby certify that the foregoing is a correct copy of the field notes of the survey of County Road No 210 for Umatilla Co. Or.

Jno C. Arnold. Surveyor.

Plat of Road N^o 210

I hereby certify that the following is a correct plat of
County Road N^o 210 for Umatilla County, Oregon.

Jno C. Arnold

Surveyor.

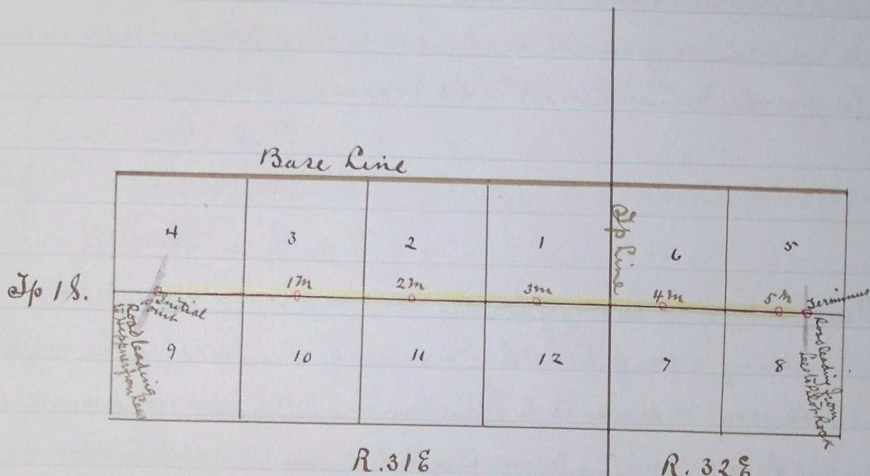

Journal F. page 459

.. F. .. 571

Recorded Sept 16th 1884

J.P. Bushe
Clerk.