

ROAD No.
161

Report of Viewers. Field Notes and Plat of Survey of County Road
from near Wm Lee on Birch Creek to Pilot Rock
Road No 161

To the Hon. County Court for Umatilla County, Oregon.

We the undersigned having been appointed by your Hon. body to view out and survey a County Road in the above named County and State would respectfully report that we met at the time and place appointed, and after being qualified according to law by A. L. Coffey County Surveyor for Umatilla Co Oregon. we called to our aid Hester Green and Masow Green as chainmen and Frank Green as marker.

We proceeded to view out and survey said road, commencing at a point where the Lee Road leaves the Pilot Rock & Pendleton Road, and running thence as set forth in the order of the County Court, to Pilot Rock.

We would further report the Road a good practicable one and much needed and easily opened. We therefore would recommend that the petition for said Road be granted.

This 23rd day of Aug 1883

Abram Miller
J. M. Hemphill

Beginning at a point on the County Road leading from Pendleton to Pilot Rock where the same intersect the County Road known as the Lee Road. By planting a post marked R from which we run,

(Course)	Distance	
S. 6° W.	28.00	Angle thence
S. 47 E.	37.00	" "
S 14 W.	51.00	" "
S 71 W.	58.00	" "
S 80 W	60.00	Bridge across Birch Creek
" " "	61.00	Angle thence
S 51 W	75.00	" "
S 68 W.	80.00	Set post marked 1 M.
" " "	41.00	Angle thence
South	65.00	Section corner to 4.5.879 Sp 1. N. R 32 E.
"	80.00	Set post marked 2 M
"	67.00	to Sec corner to Secs 8-9. 16717

and angle thence

S 30° W. 80.00 Set post marked 3 m
 S 30 W. 63.00 Angle thence
 S 14 W. 80.00 Set post marked 11 m.
 " " " 5.00 Angle ^{and} 1/4 Sec post to Sec 20.
 South 55.00 Van horns House bears
 West 3.00 lks
 South 80.00 Set post marked 5 m.
 " 3.75 Angle thence
 West 44.00 " "
 South 80.00 Set post marked 6 m.
 " 80.00 Set post " 7 m.
 " 40.00 Angle thence
 East 79.00 " "
 S 22 W. 80.00 Set post marked 8 m.
 " " " 5.00 Angle thence
 S 7° W. 80.00 Set post marked 9 m.
 " " " 5.00 Angle thence
 South 45.00 " "
 S 16 E. 72.00 " "
 S 21 W. 80.00 Set post marked 10 m.
 S 8 W. 11.00 Angle thence
 East 12.00 West Birch Creek
 " 21.00 East " "
 " 23.00 Set post marked R.

Sp 1. N. R. 32 E. Initial Point

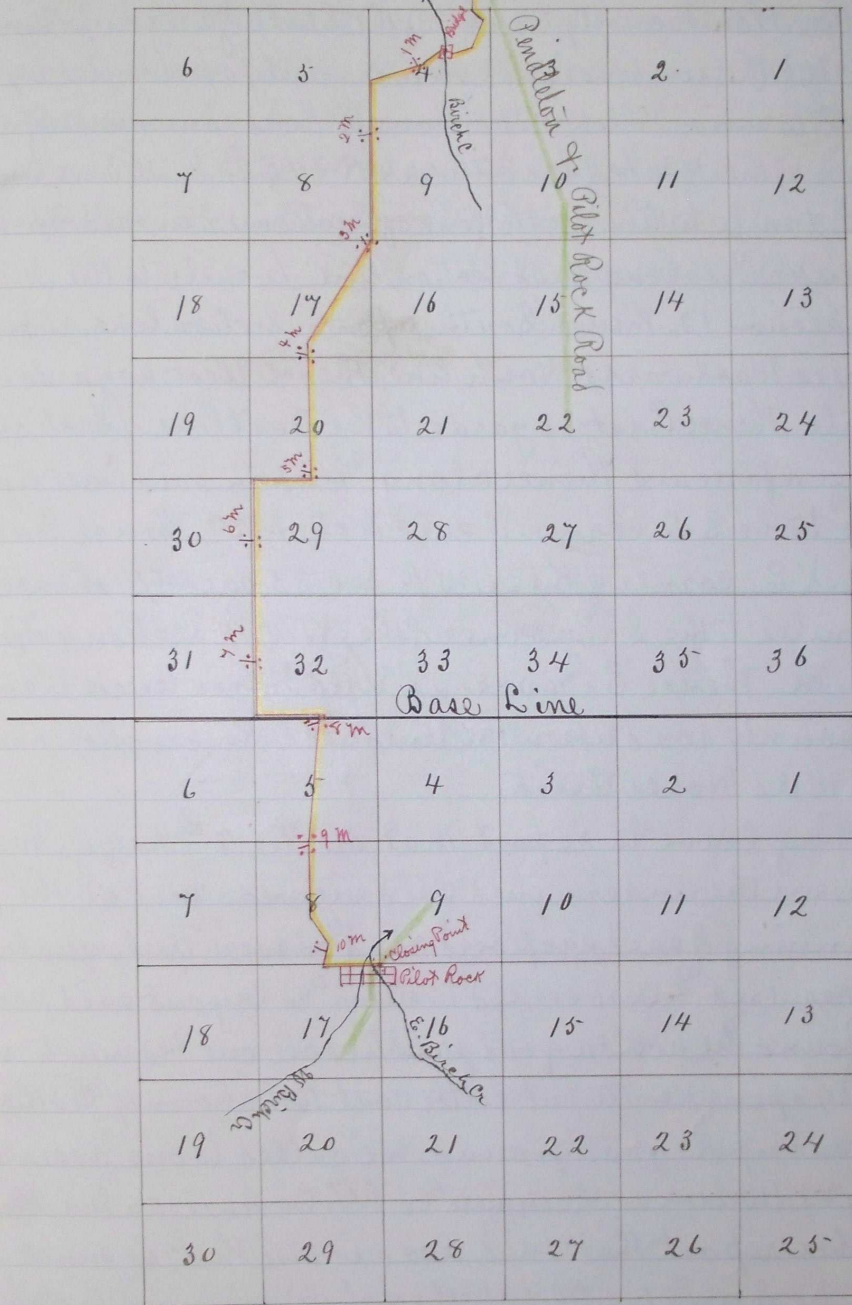

I hereby certify that the within is a true and correct plat and survey of Road No 161. as surveyed by order of the County Court of Umatilla Co. Oregon. This 24th day of August 1883

A. L. Coffey, County Surveyor of Umatilla Co Or

Journal F. Page 74.

" F " 129

Recorded Oct 1st 1883

J. P. Bushee Clerk