

Court met on this day pursuant to adjournment and there were present:

Hon G A Hartman	County Judge.
" T G Hailey	District Attorney.
" T P Gilliland	County Commissioner
" Horace Walker	County Commissioner
W D Chamberlain	Clerk.
T D Taylor	Sheriff.

And after the proclamation of the opening of the Court by the proper officer the journal of the last days proceedings was read and is hereby approved and signed and the following proceedings had to-wit:

G. A. Hartman County Judge.
Horace Walker County Commissioner
T. P. Gilliland County Commissioner

In the matter of the application)
of W S Byers for license to store) Order
grain.)

On this day this matter coming on to be heard upon the application of W S Byers who has duly presented his undertaking herein for license to store grain, and the Court at this time having examined said application and undertaking, and finding the latter to be satisfactory it is now therefore hereby ordered that said undertaking be, and the same is hereby, approved, and the Clerk of this Court is hereby ordered to issue to said applicant a license to store grain for the period of one year from the date hereon.

Rd 1362

In the matter of the Petition)
of S P Gould, W M Slusher, and)
others, to vacate a part of County Road No 326.)

In this matter the Court Finds that the Viewers and Surveyor appointed on May 6, 1903. met at the time and place fixed by the Court, when and where each of them took the oath by law required and they then took two suitable persons to act as chain bearers and then proceeded to perform their duties as the law directs, that a report of the said Viewers, with a correct certified return of the survey of that portion of said road asked to be vacated, and a plat of the same, made and certified by the Surveyor, were filed with the Clerk of this Court on June 25, 1903, prior to the first day of this term of Court, which report of Viewers is in favor of the vacation of the said portion of the road asked to be vacated; and now said report of the Viewers having been duly read in open Court on two different days prior to this day, at this term of Court, and no remonstrance nor any objection of any kind, nor any petition for damages having been filed or made by any person, and the Court having examined into all of the matters connected herewith and all of the papers filed and orders made heretofore, and being now satisfied that the portion of the said road asked to be vacated by the petition of S P Gould, W M Slusher and others, in this matter, should be vacated and that the same can be vacated without injury, damage, or inconvenience to any person, and such vacation thereof will be of public advantage and utility, and the Court being now fully satisfied that the said petition should be granted.

IT IS THEREFORE NOW BY THE COURT CONSIDERED, ORDERED and decreed that the said report, survey and plat be and they are hereby approved, ratified, and confirmed, and they shall be recorded in the proper records of this Court and of Umatilla County, Oregon, and from this time forth that portion of the said County Road No. 326 asked to be vacated, to-wit:

All of that part of said County Road No 326 which lies in Township 2 North and Range 29 East of the Willamette Meridian which part of said County Road is particularly described as follows: Commencing near the Southeast corner of the Northeast quarter of section 1 in Township 2 North and Range 29 East of the Willamette Meridian, in Umatilla County, Oregon, where said County Road No 326 crosses the section line on the East side of said section 1, running thence along said County Road Southwesterly across the Southeast quarter of said Section 1, and the North Half of Section 12, and the East Half of section 11, in said Township and Range, to a point near the center of said section 11; thence running North and still following said County Road about 40 road; thence running Westerly and still following said County Road to the West line of said Section 11; thence running South and still following said County Road on the section line between Sections 10 and 11, 14, and 15, 22, and 23, 26 and 27, all in said township and range, to a point on the West side of said section, 26, near the Southwest corner of the Northwest Quarter thereof, where said County Road No. 326 intersects the section line on the West side of said section 26, thence running Southeasterly and still following said County Road across said section 26, to a point near the Northwest corner of the Southeast quarter of said section 26, thence still following said County Road No 326 in a Southwesterly direction across the South Half of said section 26, and into Section 35, to a point near the center of the Northwest quarter of said section 25 in said township and Range; thence running Southeasterly and still following said County Road across the North Half of said section 35 and the North Half of section 36, in said Township and Range; to a point near the center of section 26 aforesaid, where said County Road No. 326 terminates, shall be and the same is hereby declared and decreed to be vacated and annulled and no longer a highway or public thoroughfare.

Done and dated in open Court this _____ day of July, 1903.

Commencing at a point on Road No. 326 2.85 chains
 south of the 1/4 sec corner bet Secs 1 & 6 Township 2 North
 of Ranges 29 and 30 East of the Willamette Meridian
 Oregon thence I run

				A
				1
	S 28° 30' W	12.00 chains		2
thence	S 41° W	21.00 "	33.00	3
"	S 54° 15' W	7.25 "	40.25	4
"	S 43° 30' W	27.00 "	67.25	5
"	West	12.75 "	80.00 1. Mile	6
"	West	23.75 "		7
"	S 52° 30' W	9.50 "	33.25	8
"	N 88° W	24.50 "	57.75	9
"	S 73° 30' W	4.50 "	62.25	10
"	S 56° W	11.00 "	73.25	11
"	S 66° 15' W	6.75 "	80.00 2 miles	12
"	S 66° 15' W	8.25 "		13
"	N 72° 10' W	16.50 "	24.75	14
"	West	5.00 "	29.75 to 4 mile bet 022 12	15

Said County Road No. 326

thence	South	502.5 chains	8000 3 miles	
"	South	8.000	8000 4 miles	
"	South	8000	8000 5 miles	
"	South	39.75		13
"	East	40.25	8000 6 miles	14
"	South	12.50 chains		15
"	S 50° W	5.00 "	17.50	16
"	S 80° W	5.00 "	22.50	17
"	S 86° 30' W	18.50 "	41.00	18
thence	South	8.25 chains	49.25	19
"	S 33° 45' E	20.00 "	69.25	20
"	S 32° 50' E	7.00 "	76.25	21
"	S 32° E	12.75 "	8000 7 miles	22
"	S 32° 50' E	47.25 "		23
"	S 65° 30' E	2.75 "	5000	24
				25

"	North	39.75			13	
"	East	40.25	8000	6 miles	14	
"	South	12.50	chains		15	
"	S 50° W	5.00	"	17.50	16	
"	S 80° W	5.00	"	22.50	17	
"	S 86° 30' W	18.50	"	41.00	18	
	Thence South	8.25	Chains	49.25	19	
"	S 33° 45' E	20.00	"	69.25	20	
"	S 32° 50' E	7.00	"	76.25	21	
"	S 32° E	12.75	"	8000	7 miles	22
"	S 32° 50' E	47.25	"		23	
"	S 65° 30' E	2.75	"	5000	24	
"	S 53° 30' E	18.75	"	63.75	25	
"	S 63° 15' E	16.25	"	8000	8 miles	
"	S 63° 15' E	23.75	"	B. T. on Road No 326		

I hereby certify that the above field notes of Road No 326 are correct

John W. Kimbell County Surveyor
for Umatilla County Oregon

*Platz of Road No. 326
In Township 2 North of Range 29 East W.M.*

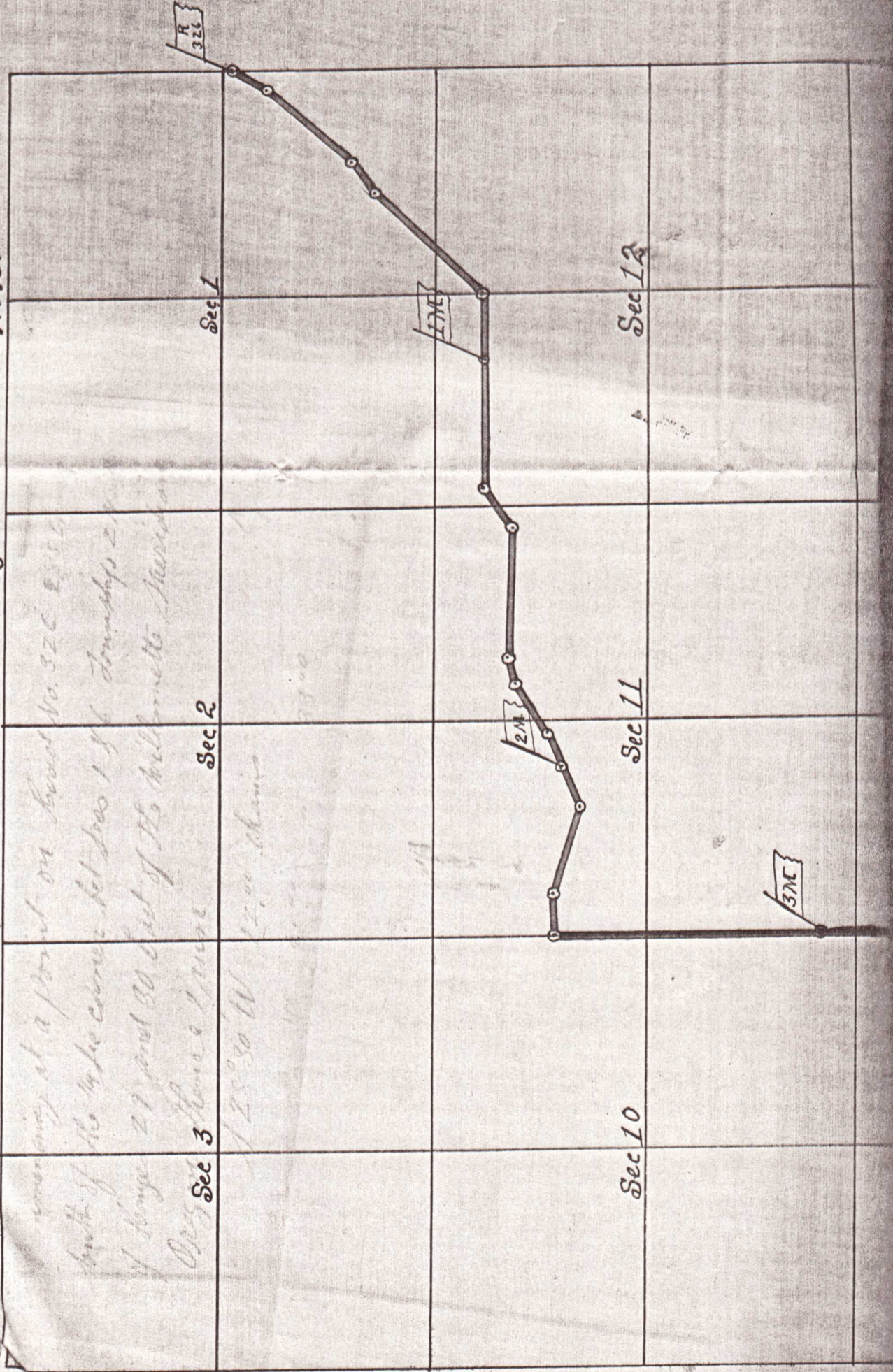

*emerging at a point on Road No. 326
north of the 1/4th corner, Sec 2, Twp 2 N, R 29 E, W.M.
of Range 29 East of the Willmette Meridian
Q. 15 Sec 3 Range 1 Range*

Sec 2

Sec 1

Sec 10

Sec 11

Sec 12

R
326

LME

2NE

3NE



1NE

Sec 12A

Sec 13

Sec 24

2NE

Sec 11

Sec 14

Sec 23

3NE

4NE

Sec 10

Sec 15

Sec 22

Sec. 22

Sec. 23

Sec. 24

Sec. 27

Sec. 26

Sec. 25

Sec. 34

Sec. 35

Sec. 36

5NC

6NC

7NC

8NC

9NC

I hereby certify that the
 above Plat of Road M.326
 is correct as surveyed by
 me on the 9th day of June 1903
 John W. Timbrell
 County Surveyor
 for Comstock County Or.

The Meridian
 Var. 27° 45' East
 SCALE 25 ch. 1"