

ROAD No

419.

In the matter of Viewing Surveying and laying out  
County Road No. 419.

commencing at the center of Section (5) in Town (3) North  
Range 29 East W. M. Thence in a South easterly direction  
and nearly parallel with the U. P. Rail Road to a point near  
the S. W. Corner of the S. E. 14 of said Section (5). Thence East on  
the Section line between Sections 5+8 about 1/4 of a mile to  
the line between Sections 8+9 Thence South on said Section  
line one half mile. Thence East on the center line of sec-  
tion 9 one fourth of a mile. Thence in a southerly direc-  
tion on the most practical Route to the intersection of  
Dupont and main streets in Echo Umatilla County  
Oregon said road to be Eighty feet wide.

Viewers Report

To the Honorable County Court of the State of Oregon for  
Umatilla County.

We the Undersigned the viewers heretofore appointed to view and  
locate Road No 419 submit the following report. Pursuant to  
an order of the Honorable Court we met at Echo Oregon on  
the 22<sup>d</sup> day of Apr 1893 and were each, duly sworn to faithfully  
and impartially discharge the duties of our appointments.  
Edgar Thomson, S. A. Oliver chairmen. Marker.

Who were by the Surveyor, each, duly sworn. We viewed  
surveyed and located said Road No. 419 as specified  
in our order. We find the road located upon comparatively  
good ground, the grades all easy to be brought within  
limits of the 10% Maximum and the road is opened to  
public travel and has been traveled for years; the  
said road 419 is the only road located up and down  
E side of Umatilla River between the towns of Echo + Foster

We would therefore recommend that said road No  
419, as surveyed by us, be declared a public highway.

U. W. Whitworth }  
S. S. Risle } Viewers, Road Survey No. 419  
J. H. Boyce }

Filed May 3. 1893 }  
W. M. Pierce. Clerk }

East of  
East of  
th. 1893

County Oregon



## Field notes of Road Survey No 419 for Umatilla Co. Ogn.

- Meet W. W. Whitworth, viewer on Road Survey No. 419, for Umatilla Co. Oregon, at Echo, Friday Apr. 21<sup>st</sup> 1893, and duly administer oath, as per law. We call S. A. Oliver and Edgar Thomson to chain and mark, each of whom, was likewise, duly sworn. I commence 90 feet East of the point of intersection of the center of the U. P. R. R. track with the line running E + W. through the center of Sec. 5 T. 3 N. R. 19 E. set initial post at Cor. of fences N + E on corresponding sides of lane (Road No 198) and from said point of commencing I run on center line of Road No. 419 said road to be 50 feet wide, the center line of which is 90 ft. left or East <sup>90</sup> feet parallel to the center line of said R. R. track Southward:
- 1100 Cemetery bears about 50 ft. East.
- 1200 Descend
- 1240 Center of gulch S. W. - ascend.
- 1700 Set angle post Mk'd  $\uparrow$  against fence, E of trav. R. Leave line parallel to center of R. R. track.  
Thence S 33° E Va. N 70° E
- 3045 Set up Mk'd  $\uparrow$  against gate post in E + W fence and 10 ft South of line bet Secs 5 + 8 in said Tp.  
I turn thence S 58° 30'  
On line bet. Secs 5 + 8
- 4514 Cor. to Secs. 4-5-8+9 under fence on E side of lane N + S  
Set A.P. Mk'd  $\uparrow$  at Cor. and turn on line bet. Secs. 8+9, R 89° 45'
- 5280 Set 1 M.P. against fence on E. side of lane on sec line  
500 Descend
- 620 Draw Course about S 80° W - Ascend
- 880 Summit, Descend slightly.
- 1054 Ravine course about West. ascend
- 1912 Center of road in lane 60 ft. wide course E at angle N + E. Thence I turn S 90° 50' along road in lane purposing to be on line E. + W. through Sec. 9
- 2800 Descend gently
- 3160 Leave lane.
- 3770 Small ravine, Course about S. 5° W.
- 3826 Set A.P. Mk'd  $\uparrow$ . I turn, thence along W. base of hill R. 89° 40' M. C. S 77° E
- 5280 Set 2 M.P. cut  $\uparrow$  on top of same, Descending.  
Turn thence R 15° 22'
- 150 head of grade in old traveled road to Echo
- 517 Set A.P. Mk'd  $\uparrow$  about 15 ft E. of E bank of old grade  
Turn thence S 41° 04'



a. for  
s duly  
edgar  
wise, duly  
section of  
W. through  
- of fences  
nd from  
oad No. 419  
0 ft. left or  
  
R.  
  
and  
  
N+S  
Secs.  
  
r sec line  
  
angle  
are  
c. 9  
  
is of  
ing.  
no  
old grade

- 918 Set A.P. MKd  $\overline{m}$  about 5 ft. E of E. bank of old grade.  
Turn thence S  $41^{\circ} 45'$
- 1020 Foot of hill
- 1468 Set A.P. MKd  $\overline{s}$  N.W. cor of ware house bears S  $19^{\circ} 25'$   
120 ft dist. Turn thence R  $39^{\circ} 25'$
- 1523 U.P. side track to Humitta Mills at Echo.
- 1703 " Main " Course about S  $30^{\circ} 6'$
- 1782 Set A.P. MKd  $\overline{x}$  on W side of trav road to Echo  
Turn thence S.  $39^{\circ} 52'$
- 1970 Center of Waste Water ditch (A. Mills), about 20 ft.  
wide and 8 ft. deep course N.W. bridged
- 2355 Set A.P. MKd.  $\overline{z}$  at intersection of center line of  
Dupont Street in Echo  
Turn thence R  $27^{\circ} 35'$  or South along center line of  
said Dupont Street
- 3400 Ent. Center line of Main Street in Echo the terminus  
of said Road 419 at 3:40 P.M. and no dinner,  
Turn thence R.  $135^{\circ}$  to Koontz hotel to dinner.

All the stakes and posts are of proper size and are correctly marked and set in mounds as required by law.

I hereby certify that the foregoing field notes of Road Survey No. 419 for Humatta County Ar. are correct.

Jno E. Arnold  
County Surveyor.

Filed May 3. 1893 }  
W.M. Pierce }  
Clerk }



Plat of Road No 419

I hereby certify the following to be a correct plat of the survey of road 419 Township 3. N Range 19 East of Williamette Meridian as made by me, Apr 20 to 23<sup>d</sup> 1893

Jno. C. Arnold  
Surveyor for Umatilla County Oregon

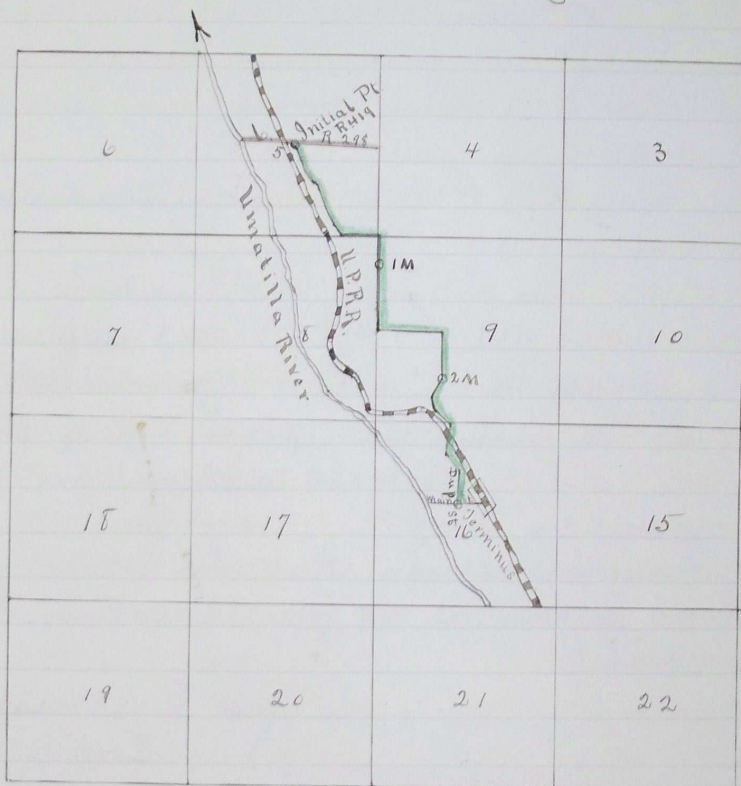

Filed May 3. 1893  
W. M. Pincus  
Clerk

11 489