

ROAD No

147.

Report of Viewers. Field Notes & Plat of Survey of a County Road from Pendleton to intersect the County Road at or near Hemphills on Birch Creek. (Road No 147)

To the Hon. County Court for Umatilla County, Oregon.

We the undersigned having been appointed by your Hon. body to view out and survey a County Road in the above named County and State, would respectfully report that we met at the time and place appointed and after being duly qualified according to law by A. S. Coffey, County Surveyor.

We called to our aid Francis Dugan and W. J. Shelton as chain bearers and J. W. Larkin as marker. We proceeded to view out and survey said County Road to-wit:

Commencing at the S. W. corner of the Court House Block from which we run S 23° E to Webb Street. Thence S 67° W down Webb St. 20.00 chs. thence S 23° E 7.00 chs. thence down the Umatilla bottom to the crossing of Tw Ta Willow. Thence on a southerly course to the lower crossing of Mc Kay Creek. Thence to the summit between Mc Kay Creek and Birch Creek. Thence along said summit along or near the Indian Reservation line to the South boundary of Sec 14, T 1. N. R 32. E. Thence on as near and the most practical ground to intersect the County Road at Hemphills.

We would further report the Road a good practical one and much needed and would recommend that this petition for said Road be granted

This 21<sup>st</sup> day of March 1883

Jacob Frazer  
J. B. Keeney

### Field Notes

Survey of County Road No 147. Commencing at the S. W. Corner of the Court house Block by planting a post marked R from which we run.

S 23° E	6	50	Angles Thence
S 67° W	26	00	" "
S 23° E	33	00	" "
S 70° W	47	00	" "
S 25° E	49	00	Cross the R.R. and angle
S 77° W	80	00	Set post marked 1 m.
S 80° W	25	00	Tw Ta Willow Creek
South	39	00	Angle Thence

	S 25° 30'	63 00	Angles thence
	S 19° W	80 00	Set post marked 2. m
	" " "	2 50	Angles thence
	S 31° W	14 00	" "
	S 55° W	39 50	" "
mt 16	S 74° W	55 50	M <sup>o</sup> . Kay's Creek 1.50 OK
" 31	" " "	57 00	Angles thence
" 9	S 15° W	80 00	Set post marked 3 m
" 41	" " "	17 50	Angle thence
" 11	S 39° W	52 50	" "
" 8	South	56 00	" "
" 30	S 27° E	65 00	" "
" 2	S 16° E	80 00	Set post marked 4 m
" 1	" " "	7 00	Angle
" 2	S 20° E	16 00	Angle thence
" 2	S 33° E	80 00	Set post marked 5 m
"	S 28° E	42 00	Angle
"	S 17° E	80 00	Set post marked 6 m.
"	" " "	18 00	Angle
"	S 46° E	38 00	"
"	S 42° E	54 00	"
"	S 16° E	80 00	Set post marked 7 m.
"	" " "	15 00	Angle
"	S 20° E	38 00	Intersect 1/4 Sec line in T 1. N. R 32 E, 2' 00' Ok. West of 1/4 Sec post
"	" " "	80 00	Set post marked 8 m.
"	" " "	80 00	" " " 9 m.
"	S 10° E	50 00	Angle
"	South	80 00	Set post marked 10 m.
"	"	15 00	Angle
"	S 17° W	80 00	Set post marked 11 m.
"	" " "	45 00	Angle
"	S 27° W	80 00	Set post marked 12 m.
"	S 31° W	70 00	Intersect County Road at Hemphills and set post marked R

I hereby certify that the within is a true and correct survey of Road  
No 147. This 24 day of March 1883

A. L. Coffey  
County Surveyor, Washtenaw Co Oregon

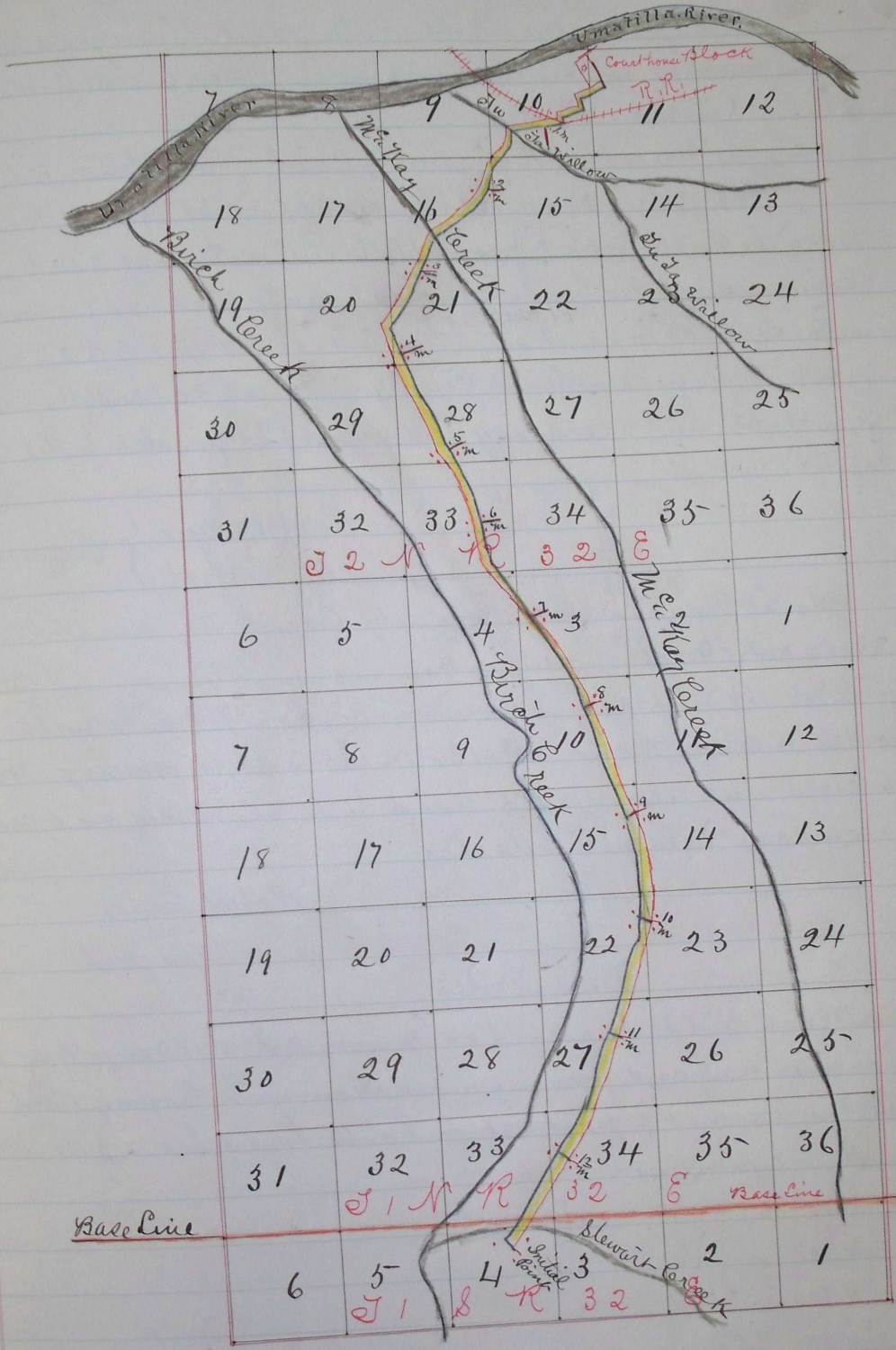

Journal E. page 648  
 " " " 717

Filed April 3<sup>rd</sup> 1883  
 J.P. Bushee Clerk  
 Recorded April 13<sup>th</sup> 1883  
 J.P. Bushee Clerk