

above named grantee its successors and assigns, that the above granted premises are free from all incumbrances and that they will, and their heirs, executors and administrators shall warrant and forever defend the above granted premises, and every part and parcel thereof, against the lawful claims and demands of all persons whomsoever.

IN WITNESS WHEREOF the grantors above named hereto set their hands and seals this 20th day of May A.D. 1919.

Signed, sealed and delivered in presence of J S Johns Sybil Farley

Charles B. Isaac (Seal) Mary E. Isaac (Seal)

STATE OF OREGON) COUNTY OF UMATILLA) SS.

THIS CERTIFIES, That, on this 20th day of May A.D. 1919, before me, the undersigned, a Notary Public in and for the said County and State, personally appeared the within named Charles B. Isaac and Mary E. Isaac, husband and wife who are known to me to be the identical persons described in and who executed the within instrument and acknowledged to me that they executed the same freely and voluntarily for the purposes and uses therein mentioned.

IN TESTIMONY WHEREOF, I have hereunto set my hand and official seal the day and year last above written.

J. S. JOHNS NOTARY PUBLIC STATE OF OREGON

J S Johns Notary Public for Oregon My Commission expires Oct. 3, 1920

Filed for record, September 23rd, 1922, at 1:49 P.M.

B. S. Burroughs Recorder of Conveyances.

ELVIN CRAIG ET UX) TO) WARRANTY DEED. UMATILLA COUNTY)

KNOW ALL MEN BY THESE PRESENTS, That Elvin Craig and Edna Craig, husband and wife of the County of Umatilla, State of Oregon, in consideration of One Hundred (\$100.00) Dollars to them paid by Umatilla County, State of Oregon, a public corporation of the County of Umatilla, State of Oregon, have bargained and sold, and by these presents do grant, bargain and sell and convey unto said Umatilla County, State of Oregon, a public corporation, its successors and assigns, all the following bounded and described real property, situated in the County of Umatilla, and State of Oregon:

A strip of land 20 feet wide on the East side of the center line of the Pendleton-Pilot Rock Highway, Beginning at the intersection of the South line of the present road at Station 3/ 44.0, which station is approximately 278.2 feet North and 101.2 feet East of the Southwest corner of the Northwest quarter of the Southwest quarter of Section Twenty-seven (27), Township Two (2), North, Range Thirty-two (32), E.W.M., thence South 36°01' West 47.9 feet; thence Southwest on a 15° curve to the left 240.1 feet to station 6/32 which is on the section line between Sections Twenty-seven (27) and Twenty-eight (28), Township Two (2), North, Range Thirty-two (32), E.W.M. and approximately 15.0 feet North of the Southwest corner of the Northwest quarter of the Southwest quarter said Section Twenty-seven (27). Also the following property: Beginning at a point 278.2 feet North and 101.2 feet East of the Southwest corner of the Northwest quarter of the Southwest quarter, Section Twenty-seven (27), Township Two (2), North, Range Thirty-two (32), E.W.M., thence South 36°01' West 47.9 feet; thence Southwest on a 15° curve to the left 118.1 feet thence North 144 feet; thence East 81.2 feet to the place of beginning, containing 0.236 acres in all.

Together with all and singular the tenements, hereditaments, appurtenances thereunto belonging or in anyway appertaining, and also all their estate right, title and interest in and to the same, including dower and claim of dower.

To have and to hold the above described and granted premises unto the said Umatilla County, State of Oregon, a public corporation, its successors and assigns forever. And Elvin Craig and Edna Craig, husband and wife grantors above named do covenant to and with the above named grantee its successors and assigns, that the above granted premises are free from all incumbrances, and that they will, and their heirs, executors and administrators shall warrant and forever defend the above granted premises, and every part and parcel thereof, against the lawful claims and demands of all persons whomsoever.

IN WITNESS WHEREOF, the grantors above named, hereto set their hands and seals this 13th day of September A.D. 1919.

Elvin Craig

(Seal)

Signed in presence of

STATE OF OREGON
COUNTY OF UMATILLA
before me to be acknowledged
MARGARITA NOTARY STATE

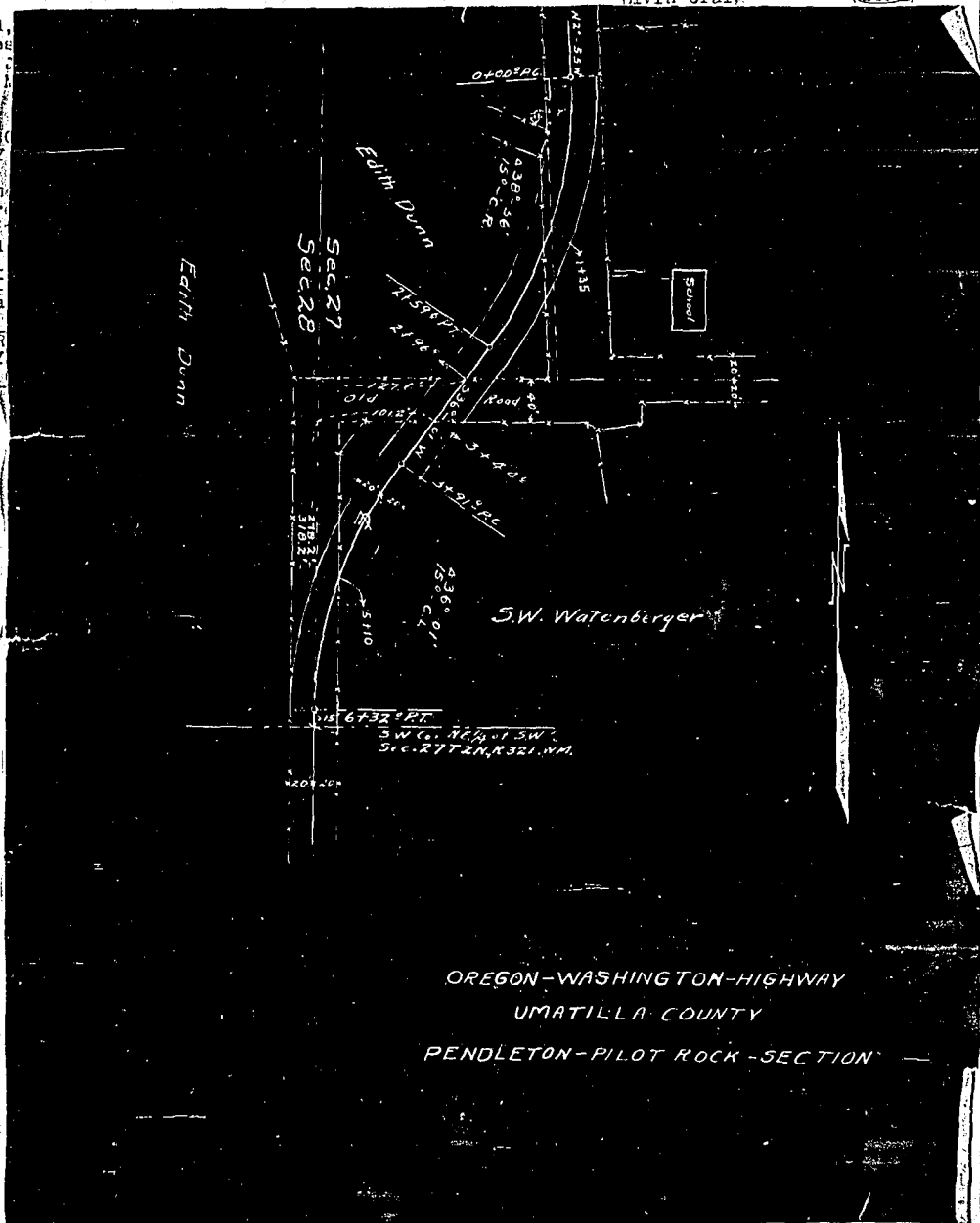

OREGON-WASHINGTON-HIGHWAY
UMATILLA COUNTY
PENDLETON-PILOT ROCK-SECTION

Filed for record, September 23rd, 1922, at 1:50 P.M.

B. S. Burroughs
Recorder of Conveyances.