

692

# Field Notes of Road No. 692

Commencing at the center of section 3 T4N R28E W12E  
I set post 4x4 inches 4 ft long 40 feet NW of United Point  
Marked R. 692 dug pits and raised mound around post  
thence north 2000 chains. A 1

|             |      |      |                     |
|-------------|------|------|---------------------|
| thence West | 2065 | 4065 | ditch 1' wide NWS   |
|             | 2800 | 4865 | ditch 3' wide SW    |
|             | 3050 | 5050 | ditch 3' wide North |
|             | 3235 | 5235 |                     |

A 2

thence N 34° 30' W 1265 6500 R.T. Intersect line bet  
Secs 3 & 4 T4N R28E set post 4x4 inches 4 ft long  
35 feet NE Marked R. No. 692 dug pits and raised  
mound around post

I hereby certify that the foregoing are a correct  
copy of Field Notes of Road No. 692 as surveyed  
by me on the 12<sup>th</sup> day of July 1910  
John W. Kimbrell County Surveyor  
for Umatilla County Oregon

## Plat of Road No. 692

Township 4 North Range 28 East Will. Mer.

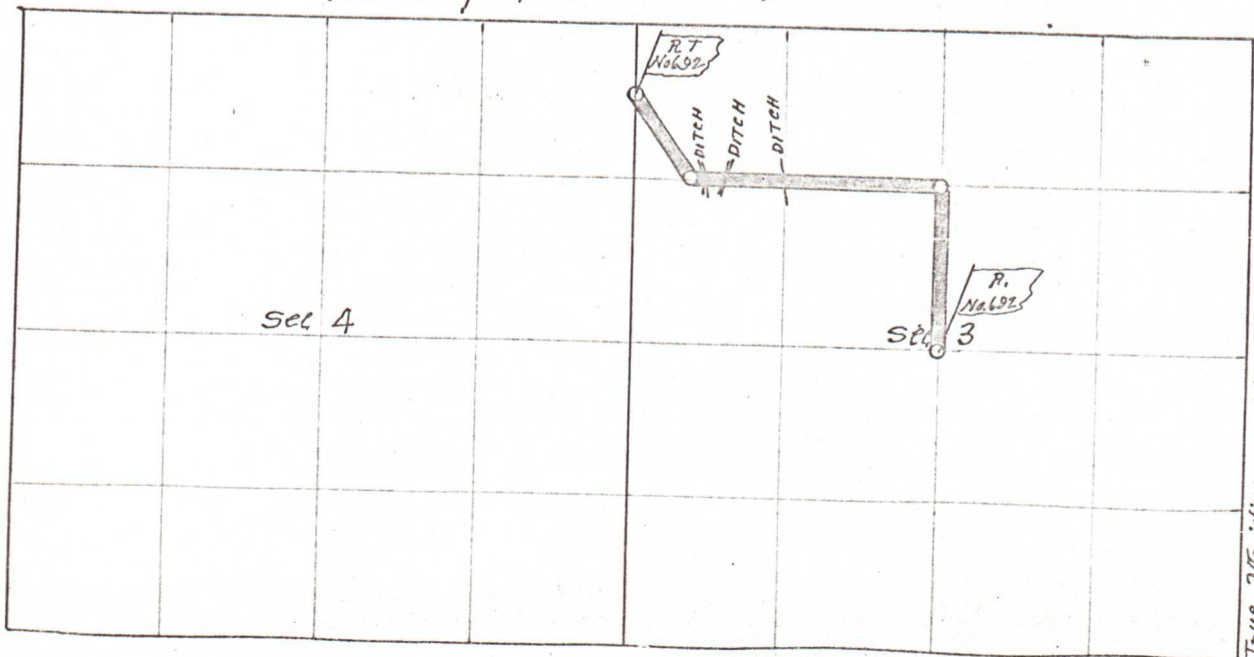

scale 25 ch. 1"