

Plat of Road No 725

T. 3 and 4 N. Ranges 29 and 30. E. W. NE.

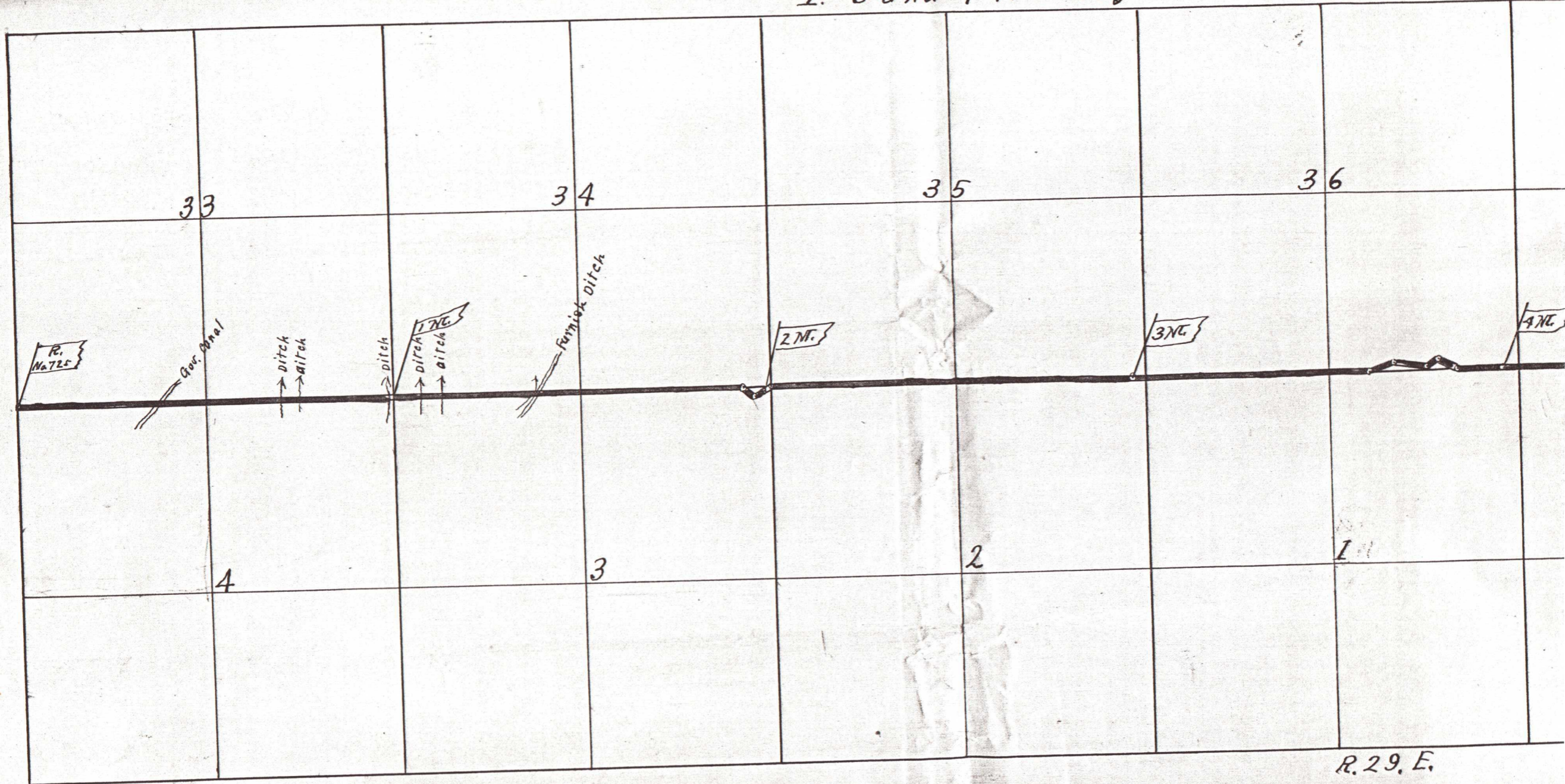

R. 29. E.

Plat of Road No 725

T. 3 and 4 N. Ranges 29 and 30. E. W. N.



T. 4. N.  
T. 3. N.

R. 29. E.

R. 30. E.

True Meridian  
var. 21° 30' E  
Scale 25 chs 1"