

ROAD NO
216.

Report of Viewers. Field Notes and Plat of Survey of a County Road from
the $\frac{1}{4}$ post between Sec 18 & 17 T₆ N. R 32 E. ending at $\frac{1}{4}$ post between Sec 26 & 27.
Road No 216.

To the Hon County Court for Umatilla County, Oregon.

We the undersigned being appointed by your Hon body to view
out County Road No 216. met at the time and place appointed, after being
qualified by W. W. Caviness. we proceeded to view said road as set forth
in the order, we find the proposed road to be a good and practical route
and much needed and one that can be opened with but a small expense
to the County, and we would ask that the petition for the same be granted.

This the 19th day of August 1884.

A. J. Long } Viewers
A. Rumney }

Field Notes

To the Hon County Court for Umatilla County, Oregon.

I hereby certify that on the 19th day of August 1884 after qualifying
A. J. Long and A. Rumney as Viewers and H. M. Broton and G. Cummings as Chainmen
and Walt Caviness as marker, under direction of said viewers I proceeded to
survey a County Road for the above named County and State as described in the
accompanying field notes of survey.

Beginning at $\frac{1}{4}$ mile post bet Sec 17 & 18 T₆ N. R 32 E. W. M. set post marked
R. run South 160 Rods to corner. thence E 160 Rods to $\frac{1}{4}$ Corner. set post Miles 1.
E on line 106 Rods. thence S. on line 160 Rods, thence E. 54 Rods, set post
6 Rods East of $\frac{1}{4}$ corner bet Sec 20 & 21. Miles 2.

East on line 104 Rods. South around gulch 50 Rods. Angle East 15 Deg
South 46 R. thence South on line 80 Rods, thence East 40 Rods, set Post Miles 3.

East 152 Rods, thence South 12 Rods, thence East on line bet Sec 26
& 27. 156 Rods. Set Post Miles 4.

thence South 160 Rods to center of Section 27. thence East on line
160 Rods. set Post Miles 5.

thence East 8 Rods to $\frac{1}{4}$ Sec corner bet Sec 26 & 27 T₆ N. R 32 E.
set post marked R.

W. W. Caviness
Surveyor

Plat of Road No 216.

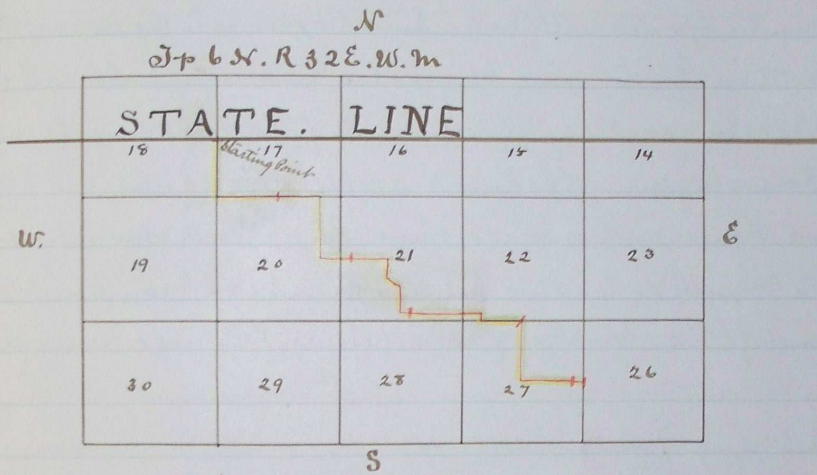

Scale 1 inch to the mile.

Journal F. page 460
 " F. " 575
 Recorded Sept 15th 1884

J.P. Bushee
 Clerk

I hereby certify that this is a
 true Plat of Road Survey No 216.
 Surveyed this 19th day of August 1884
 W. W. Caviness
 Surveyor.