

Survey Report, Field Notes, and Plan of Road running from N.E. Corner of S.E. 1/4 of Sec 25 T5-NR32 E, down Juniper Canyon to Columbia River.

Respan Ranch Columbia River
March 9 '82.

To
The County Court,
Hematella County Or Gentlemen

We the Undersigned Viewers appointed to view and locate a county road from the N.E. cor of the S.E. 1/4 of Sec 25 T5-NR32 E, down Juniper Canyon to Columbia River - by leave to report, as follows:

Met as per order, at place of beginning, and after being duly qualified by J. W. Raley County Surveyor, called to our assistance, as Chairman Wm. Scott and S. G. Hopkins and Wm. Hanson as a jury, and after having viewed and examined said route to recommend it as a practicable and needful one as a county road.

Field April 5 '882.
J. M. Mumfolt

Wm. Scott
M. C. Smith
S. G. Hopkins } Viewers

Field Notes

Notes taken in the Survey of Road running from N.E. Corner of S.E. 1/4 of Sec 25 T5-NR32 E, down Juniper Canyon to Columbia River.

See Post Marked B on above described corner from which

Draw

West	80	Chains	set	I	mile	post	
"	80	"	"	II	mile	post	
"	60	"	25	links	Set	A	
N 60° W	33	"	75	"	"	A	
N 45° W	40	"	"	"	III	mile	post
"	10	"	"	"	"	A	
N 20° W	22	"	"	"	"	A	
" 45° W	40	"	"	"	"	A	
" 25° W	6	"	"	"	"	A	
North	2	"	"	"	IV	mile	post
N. 60° West	22	"	25	"	"	A	

Rd #118

	N 25 1/2	21	chain	25 links	set	A
	N 8 1/2	11	"	50	"	A
	N 33 1/2	10	"	—	"	A
	N 50 1/2	16	"	—	"	V mile Post
	N 50 1/2	20	"	—	"	A Post
mark	N 40 1/2	31	"	"	"	"
"	N 65 1/2	16	"	50	"	A Post
"	N 85 1/2	13	"	—	"	VI mile fork
"	N 85 1/2	11	"	—	"	A Post
"	N 64 1/2	20	"	25	"	A Post
"	N 80 1/2	11	"	25	"	A Post
"	N 70 1/2	37	"	50	"	VII mile Post
"	" " 1/2	16	"	50	"	A Post
"	N 75 1/2	18	"	50	"	A Post
"	N 50 1/2	16	"	50	"	A Post
"	N 25 1/2	13	"	50	"	A Post
"	N 62 1/2	15	"	—	"	VIII mile Post
"	N 20 1/2	62	"	50	"	A Post
"	N 75 1/2	17	"	50	"	IX mile Post
"	" " "	20	"	—	"	A Post
"	S 80 1/2	20	"	50	"	A Post
"	S 50 1/2	21	"	—	"	A Post
"	N 75 1/2	18	"	50	"	X mile Post
"	" " "	26	"	50	"	A Post
"	N 80 1/2	19	"	50	"	A Post
"	N 65 1/2	34	"	—	"	XI mile Post
"	S 75 1/2	15	"	50	"	A Post
"	N 30 1/2	19	"	—	"	A Post
"	S 85 1/2	25	"	—	"	A Post
"	N 62 1/2	10	"	—	"	A Post
"	N 89 1/2	10	"	50	"	XII mile Post
"	N 89 1/2	80	"	—	"	XIII mile Post
"	" " "	34	"	50	"	A Post
"	S 63 1/2	15	"	50	"	A Post
"	S 35 1/2	13	"	50	"	A Post
"	S 85 1/2	17	"	50	"	XIV mile Post
"	S 85 1/2	2	"	50	"	A Post
"	S 80 1/2	46	"	50	"	A Post

Rd.
S 7
S 5
N 6
N 6
N 6
N 7
N 11

40. 418
 S 76 H 20 Chains — links six A Post
 S 54 H 11 " — " " XV M Post
 N 35 H 10 " — " " A Post
 N 65 H 55 " — " " A Post
 S 85 H 12 " 50 " " A Posts
 N 65 H 2 " 50 " " XVI M Post
 N 65 H 80 " — " " XVII M Post
 N 76 H 80 " — " " XVIII M Post
 N 17 H 7 " Elk Post Marked R on bank of Columbia
 River for the terminus of Road

I hereby certify that the above is a true copy
 of the original notes taken by me in the survey of
 the above described Road.

J. R. Raley
 County Surveyor

Pendleton Or.

March 24th 1882.

Fred April 5th 1882.

J. W. Kenny
 Clerk

285
285
285

S.

COLUMBIA RIVER

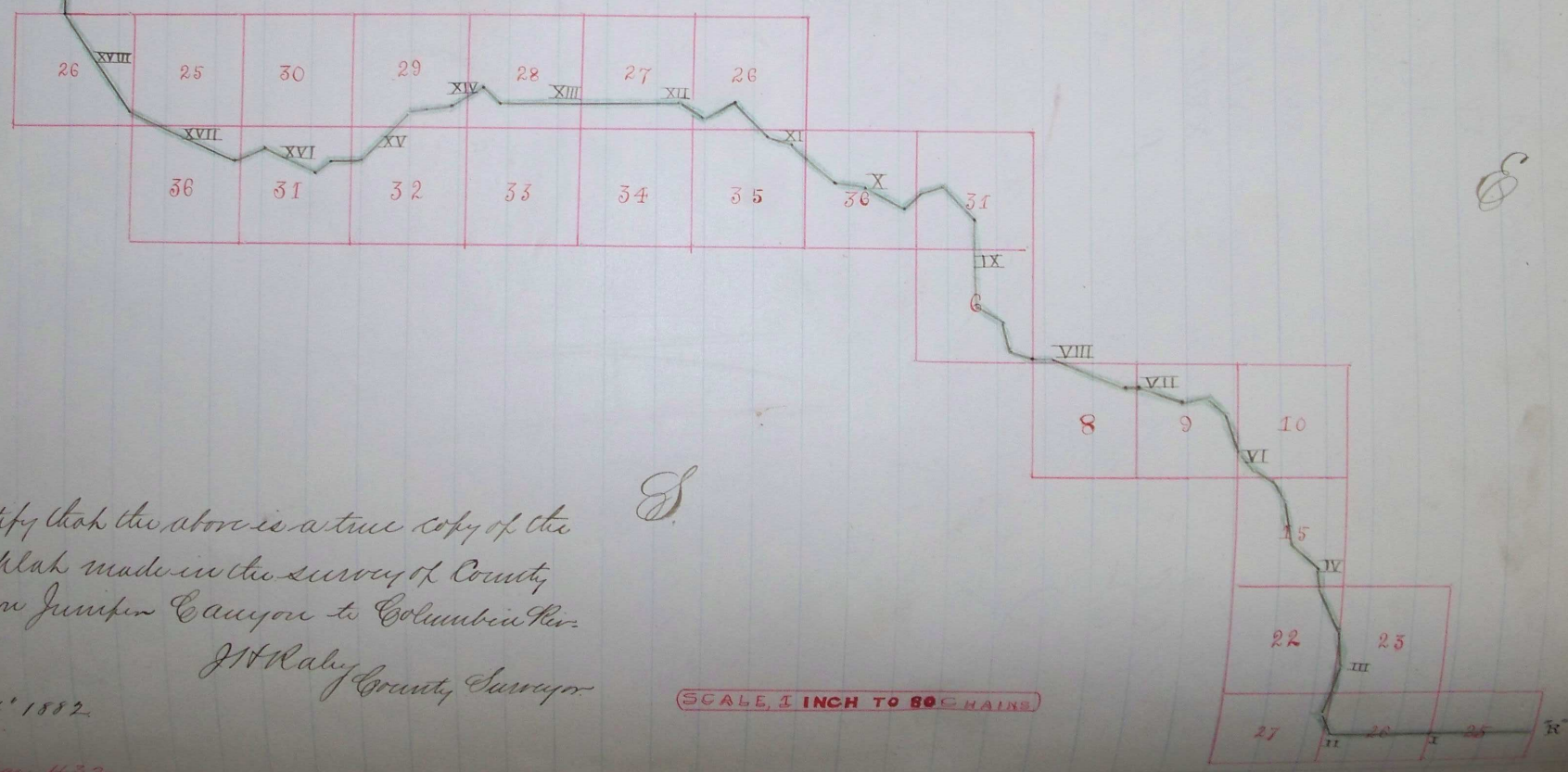

W.

S.

S.

I hereby certify that the above is a true copy of the original plan made in the survey of County road, down Juniper Canyon to Columbia River.
 J. W. Raley County Surveyor

Dated April 4th 1882.

SCALE, 1 INCH TO 80 CHAINS

Journal B Page 432

285

285