

Survey Report, Field Notes, and Plan of Road running from N.E. Corner of S.E. 1/4 of Sec 25 T5-NR32 E, down Juniper Canyon to Columbia River.

Respan Ranch Columbia River
March 9th 82.

To
The County Court,
Hematella County Or Gentlemen

We the Undersigned Viewers appointed to view and locate a county road from the N.E. cor of the S.E. 1/4 of Sec 25 T5-NR32 E, down Juniper Canyon to Columbia River - by leave to report, as follows:

Met as per order, at place of beginning, and after being duly qualified by J. W. Raley County Surveyor, called to our assistance, as Chairman W. M. Scott and S. C. Hopkins and Wm. Hanson as a jury, and after having viewed and examined said route to recommend it as a practicable and needful one as a county road.

Field April 5th 1882.
J. M. Mumfolt

Wm Scott
M C Smith
S C Hopkins } Viewers

Field Notes

Notes taken in the Survey of Road running from N.E. Corner of S.E. 1/4 of Sec 25 T5-NR32 E, down Juniper Canyon to Columbia River.

See Post Marked B on above described corner from which

Draw

West	80	Chains	set	I	mile	post	
"	80	"	"	II	mile	post	
"	60	"	25	links	Set	A	
N 60° W	33	"	75	"	"	A	
N 45° W	40	"	"	"	III	mile	post
"	10	"	"	"	"	A	
N 20° W	22	"	"	"	"	A	
" 45° W	40	"	"	"	"	A	
" 25° W	6	"	"	"	"	A	
North	2	"	"	"	IV	mile	post
N. 60° West	22	"	25	"	"	A	

40. 418
 S 76 H 20 Chains — links six A Post
 S 54 H 11 " — " " XV M Post
 N 35 H 10 " — " " A Post
 N 65 H 55 " — " " A Post
 S 85 H 12 " 50 " " A Posts
 N 65 H 2 " 50 " " XVI M Post
 N 65 H 80 " — " " XVII M Post
 N 76 H 80 " — " " XVIII M Post
 N 17 H 7 " Elk Post Marked R on bank of Columbia
 River for the terminus of Road

I hereby certify that the above is a true copy
 of the original notes taken by me in the survey of
 the above described Road.

Pendleton Or.

Mar 24 " 1882.

J. R. Raley
 County Surveyor

Fred April 5 " 1882.

J. W. Kenny
 Clerk

285
285
RD #118

S.

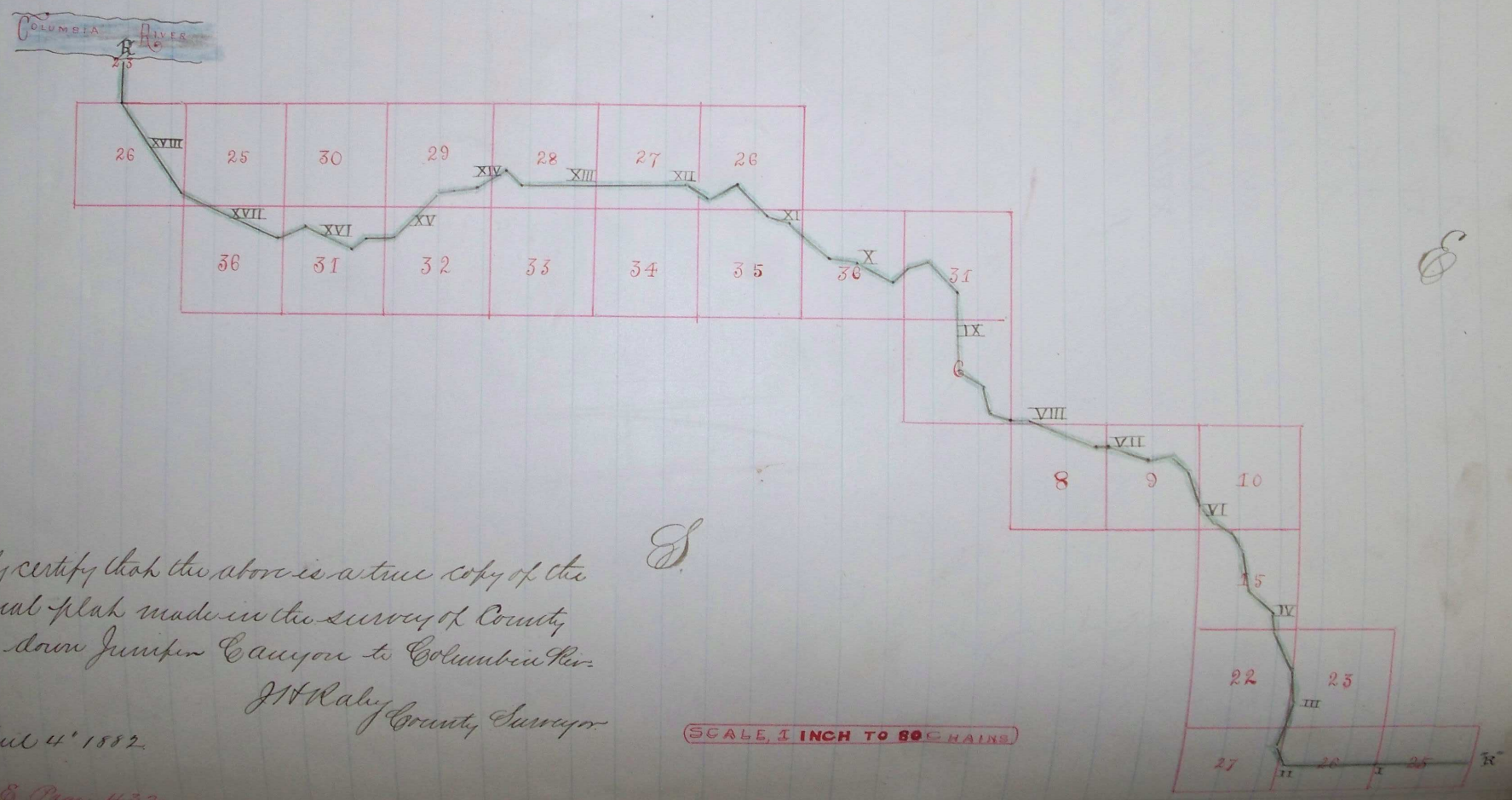

W.

S.

S.

I hereby certify that the above is a true copy of the original plat made in the survey of County road, down Juniper Canyon to Columbia River.

Dated April 4th 1882.

J. W. Raley County Surveyor

SCALE, 1 INCH TO 80 CHAINS

Journal B Page 432

160
285
285
RD #118

RD #118