

ROAD NO

347.

Road No 347

Report, of Viewers, Field Notes and Plat of Survey of
County Road No 347, in Umatilla County Oregon,
commencing on State Line at the $\frac{1}{4}$ Sec Corner
between Secs 17 and 18 T6 NR 32 E. W.M. thence South 80 rods
thence East 160 rods thence South 80 rods to $\frac{1}{4}$ Sec Corner
between Secs 17 and 20, thence East on Sec line about
140 rods, thence follow fence around head of canyon
to Sec line between Secs 20 and 21, thence South on Sec
line to $\frac{1}{4}$ Sec Corner between Secs. 20 and 21 thence East
about 110 rods, thence South and follow wagon road
as now traveled around head of Canyon to the line
between No. Russell's and Alva Pierce R.R. land thence
South to $\frac{1}{4}$ Sec corner between Secs. 21 and 28 thence
east 1 mile on Sec line to $\frac{1}{4}$ Sec. Corner between Secs.
27 and 27 thence South to the center of Sec 27, thence
east to $\frac{1}{4}$ Sec Corner between Secs 26 and 27 T6 NR 32,
E.W.M. Said Road to be 40 feet wide.

Report of Viewers on Road No 347

To the Honorable County Court;
Umatilla County, Oregon,

We the undersigned Viewers ap-
pointed in the matter of Road Survey No 347 would
respectfully report that we met J. H. Fairway, Surveyor
at place appointed on Friday April 3rd 1891, we called
to our aid S. A. Robbins and Ben Marcy to act as
Chamman and Markers and were each and each of
our assistants duly qualified by the Surveyor as di-
rected by law and proceeded forthwith to view out,
survey and locate said road as prayed for in the
petition for the same. We find the route selected to be a
fairly good and practicable one, and as the road is very
much needed we recommend that the petition be granted
and Road No 347 be declared a County Road.

Dated at Quincy this 3rd day of April 1891.

B. M. Marcy
J. J. Gourad
A. F. Gordon

Filed May 5th 1891
W. M. Pierce Clerk.

Field Notes of Road Survey No 347 Umatilla County,
Oregon.

I met full board of Viewers at Ben Marcy's on Friday
April 3rd 1891. We called to our aid G. A. Robbins and
Ben Marcy to act as chainmen and markers, each of
whom was duly qualified as directed by law.

I set initial post 20 feet West of the $\frac{1}{4}$ Sec 20 between
Sections 17 and 18 T₆ N₃₂ E₂₀ and ran South
1320. Set angle stake 20 feet south of line.

2150 Cross run

3960 Set angle stake 20 feet south of line

5280 Set 1 M.P. " " " "

7600 Cross run

7950 Set angle stake and ran $S 35^{\circ} E$,

8250 " " " " South

10560 Set 2 M.P. 20 feet west of line

10647 Set angle stake

13332 " " "

14070 " " "

15450 Cross run

15680 " "

15870 Set 3 M.P. on North side of road

23600 Set angle stake 20 feet north of line.

24720 Cross run

26400 Set terminal post.

I hereby certify that the foregoing field notes of
the No 347 road survey are correct.

J. H. Faurey

Surveyor

Filed May 5th 1891

W. M. Pierce Clerk.

Plat of Road No 247

I hereby certify that the following is a correct plat of the No 247 Road Survey as made by me Friday April 3^d 1891.

J. W. Lawry
Surveyor

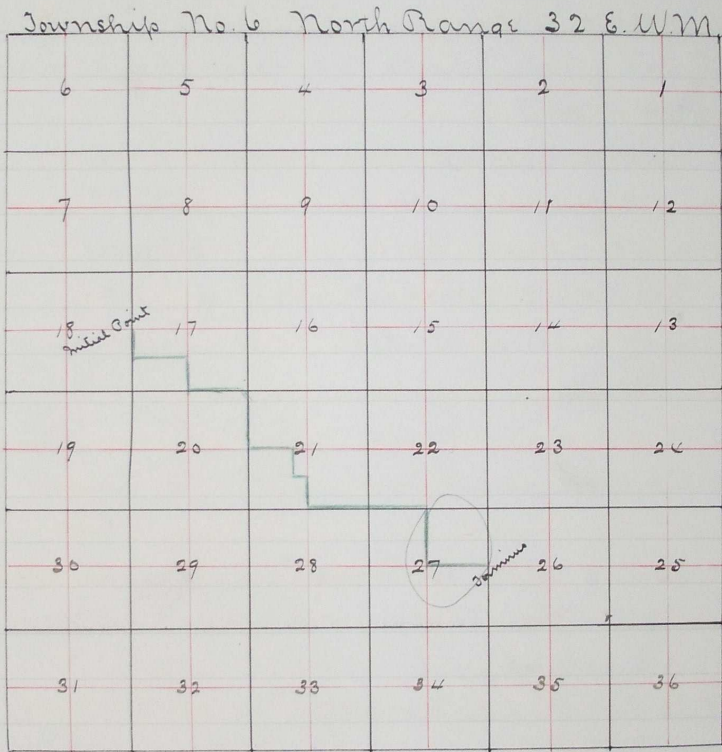

Filed May 5th 1891

W. M. Dine Clerk. Nov. 11 1890 FO 621-647-698-737

ROAD NO
358

Re
of P
com
east
24
was
com
mer

Re
So

mat
wa
Wee
as C
ass
We
said
We
and
that
a C
Sat

File
W.

Fi

In
Holl
uid
and
die
I a
33
250
2350
2640