

ROAD No

313.

Road No. 313.

Report of Viewers, Field Notes and Plat of Survey of a County Road, Beg. at a point 20 rods E. of S.W. cor of N. W/4 Sec 27 Tp 5 N. R 33 E. (which is also the terminus of Road No 249) and ending at intersection with Road from State Line to Geer Spring.

Report of Viewers

To the Hon. County Court, Umatilla County, Oregon:

We, the undersigned, your viewers on County road No. 313 would respectfully report, that we met Jno. C. Arnold, County Surveyor, at the time and place specified in our several notices of appointment as viewers and we viewed out and surveyed said road as directed by your Hon. body;

we find the road located upon comparatively good ground and to follow the natural course for a road in that vicinity; we find that there is no road leading in the direction of said road 313, nor in any approximate N. & S. direction in the vicinity of said road 313;

we find that there is, in that vicinity, no outlet to Helix, nor Killian station; nor a road to or from a grain platform at Stanton's place,

we find that the said road 313, will to a great extent supply the foregoing demands and as such is greatly needed by the general public; we therefore recommend that the prayer of the petitioners of said road 313, be granted.

Viewers of Road No 313  
for Umatilla Co. Oregon. { W. R. Amon  
J. M. Cochran  
John Rush

Field Notes

of the Survey of County Road No. 313, Umatilla Co. Oregon.

I met J. M. Cochran, W. R. Amon and John Rush, viewers on County Road survey No. 313, for Umatilla County, Oregon, at Helix in said County on the 21<sup>st</sup> day of May A.D. 1888, and calling upon Saml. A. Crowell and J. E. M<sup>rs</sup> Coy to assist in chaining and marking. I administered the usual oath of qualification to each. I commence at point purporting to be the center of Sec 27 T. 5 N. R 33 W. m. and run thence East. Var. 21°

chs

Descend to Greasewood

- 4.50 Center of Road 291
- 5.00 Set initial post marked R on N. face 7 links east of Pt. I run thence ascending Greasewood Gulch along traveled road in lane.
- N. 4° 45' W. 45.50 Set angle stake about 20 links E. of Pt. and turn 17° 30' S.
- N. 22° 15' W. 63.25 Set angle stake 10 links W. of Pt. and turn 19° 50' R.
- N. 2° 25' W. 67.60 Divide bet. Greasewood & Vansycle - Take dry lunch - water scarce. I set angle stake 20 lks. E. of Pt. and from 1/4 S. cor. bet. Secs. 21 and 22 said Tp. I run West, along road in narrow lane, purporting to be on line E & W through center Sec. 21. Descending 57.15 chs. mark point by leaving flag; and to intersect this point, I run 4° 30' W. of last

N. 6° 55' 80 68  
80.0  
24.1  
26  
N. 11° 30' W. 24.1  
N. 2° 00' W. 43.1  
N. 6° 20' W. 62.8  
N. 20° 40' E. 63.50  
64.00  
65.10  
69.10  
N. 32° 30' W. 80.00  
2.00  
4.00  
8.00  
N. 18° 00' E. 22.50  
N. 21° 00' W. 43.42  
N. 41° 00' W. 52.00

course, <sup>was</sup> run, descending along traveled road in gulch,  
 N 6° 55' W. 68.00 more abrupt descent to Vansycle,  
 80.00 Set 1 mile post 45 links west of Pt. on W. side of gulch.  
 2.50 Int. Pt. at flag 5.15 chs. W. of 1/45 cor. bet Sees 2 N 22 I set angle stake 45  
 links W. of Pt against ditch fence E. & W. Turn 4° 35' Left  
 N. 11° 30' W. 2.65 Cross ditch fence <sup>and</sup> enter John Weidert's field  
 24.15 A point designated by petitioner Cha<sup>s</sup> Stanton, as being the one  
 corresponding to petition; which point, I find to be 170 links S  
 82° W. of what appears to have been the south end of an old ditch  
 fence, N & S. I set angle stake 45 links west of Pt. <sup>and</sup> find by measuring  
 from cor. Sees 15 & 16, 21 & 22 west along ditch & wire fence, purporting  
 to be on line bet. Sees 16 & 21, a point 7.96 chs. west of said cor.  
<sup>and</sup> leave flag at point. I turn 15° 30' R. to intercept point at flag  
 N 2° 00' W 43.10 Int. reputed line bet. Sees 16 & 21, 796 links W. of See cor. I find,  
 by a series of experiments, a point 19.75 chs. toward the north  
 which will connect with a distance 4.82<sup>2</sup> chs S. W. from  
 from S. W. cor. of Stanton's School House, <sup>and</sup> at the same time  
 be 6.25 chs S. W. of a point 189 links N. W. of the N. W. cor of  
 said School House. These distances were carefully obtained  
 more especially, from the fact that Cha<sup>s</sup> Stanton, petition-  
 er, being present, says the petition was so recommended to  
 be written by the County Judge. I leave a flag at the point last  
 found <sup>and</sup> turn 1° 40' R.  
 N. 0° 20' W. 62.85 to Pt. at flag, from which S. W. cor. of Stanton's School House  
 bears N. 43° E. 482<sup>2</sup> links. Set angle stake, <sup>and</sup> turn 21° R.  
 N. 20° 40' E 63.50 Descend to Vansycle gulch  
 64.50 Center of " " course N. W.; ascend - 10'  
 65.10 Summit of opposite or. N. bank  
 69.10 Point whence N. W. cor. of Stanton's School House bears S. 26° E  
 189 links, <sup>and</sup> center of O & W. T. R. R. track bears about N. 32° E. 75  
 links; I set angle stake 45 links west of Pt. <sup>and</sup> turn along west  
 boundary of O & W. T. Right of Way 53° 15' Left.  
 N. 32° 35' W. 80.00 Set 2 mile post 45 links W. of Point.  
 2.00 Descend to gulch in Vansycle cañon  
 4.50 Center of gulch " " "  
 5.00 Summit on N. side of gulch.  
 21.00 Set angle stake 45 links W. of Pt. <sup>and</sup> turn thence 48° 30' Right  
 N. 15° 55' E 22.50 Cross track of O & W. T. R. R. to Pt. 16 lks. E. of track, set angle stake 45  
 links E. of Pt. <sup>and</sup> turn thence 37° Left.  
 N. 21.05 W. 43.42 Set angle stake 45 links E. of Pt. <sup>and</sup> opposite grain platform  
 Turn thence 20° 35' Left  
 N. 41° 40' W 52.00 Intersect line bet. Sec<sup>s</sup> 9 & 16 T. 5 N. R 33 E. 150 links E. of R. R. track  
 Point in center of ravine, course N 57° 30' E & S 57° 30' W. I set angle

Reg. at  
 so the  
 State  
 would  
 at the  
 viewers  
 body:  
 to  
 that  
 in any  
 3/3;  
 Killian  
 place,  
 fore-  
 e; we  
 13. be  
 n.  
 ntly Road  
 ntly on  
 & M<sup>e</sup>  
 al oath  
 re the  
 . 21°  
 . thence  
 reard.  
 us 22 said  
 to be online  
 rk point  
 of last

- stake N. 35° E. 40 links from point. Road in lane runs by this point course E. 4 W. I turn thence 30° Left
- N. 71° 40' W. 53.74 Pt. 50 links N. W. of Summit N of Ravine - 8'
- Set angle stake 30 links E. of point, <sup>also</sup> Turn thence 55° Right.
- N. 36° 40' W 80.00 Set 3 mile post 45 links East of Pt. I cut A on S. side of post <sup>also</sup> Turn 9° 10' Right, along E. side of R. R. track in Vansycle.
- N. 27° 30' W 11.30 Set angle stake 45 links E. of point <sup>also</sup> Turn 4° Right
- N. 23° 30' W 17.80 Water Channel in Vansycle Cañon, about E 4 W. at crossing. Precipitous earth bank on N. side of channel + 16'
- 19.70 Over point to old ditch fence E. 4 W.
- 21.90 Water Channel of Vansycle Cañon, N. W at crossing Precipitous Alkali bank on N. side of channel + 15'
- 24.50 Intersect County Road running from N. bndy of Cr. to Geer Springs course S. 60° E. <sup>also</sup> N. 60° W. at intersection, I set terminus 45 links N. 44° 30' E. of Pt. against fence on N. side of lane, course as per road intersects

All the posts <sup>also</sup> stakes were of the size <sup>also</sup> were marked <sup>also</sup> mounded as required by law, The road, in general, is well marked; a portion of it, now, already traveled, <sup>also</sup> lanes made in fencing. The road appears to be greatly needed as a connection between the different points on Vansycle <sup>also</sup> the country East, South & West of same in the vicinity of its location.

I hereby certify that the foregoing notes of the Survey of road no. 313 for Umatilla County, Oregon are correct.

Jno E. Arnold, Co. Survr.

See Plat on page 41.

uns by this  
 -8'  
 ght.  
 wet and turn  
 Precipitous  
 +16'  
 low alkali  
 +16'  
 Geer Springs  
 as 45 links  
 use as per  
 rounded  
 portion of  
 appears  
 into on  
 vicinity of  
 road no.

Plat of Road Survey no 313.

Tp 5 N. Range 33 East W. M.

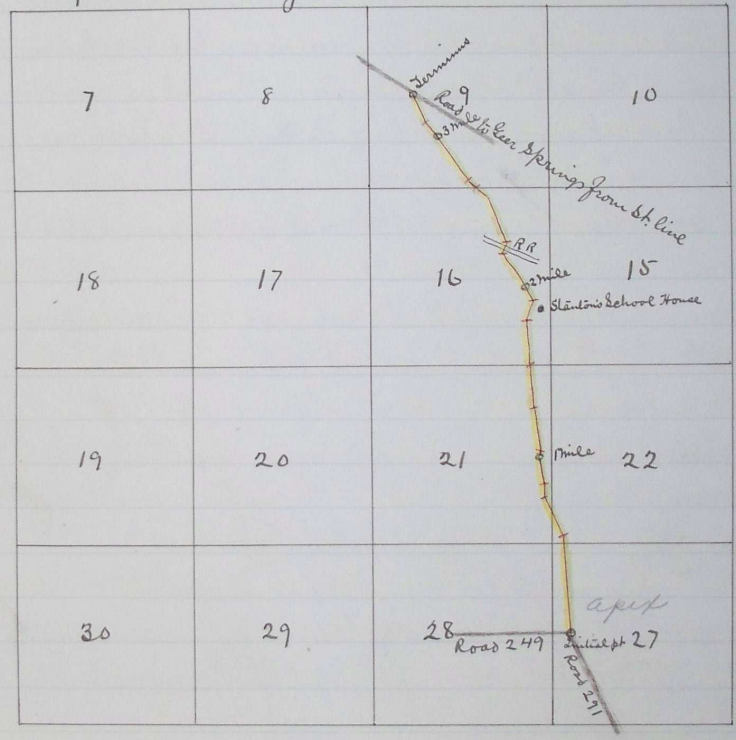

I hereby Certify the following to be a correct plat of survey Road 313. Township 5 N. Range 33 East of Willamette Meridian as made by me, May 7<sup>th</sup> 1888

Journal H. page 17x  
 " H. " 864  
 " H. " 99  
 Road Granted July 12<sup>th</sup> 1888  
 Recorded Oct 12<sup>th</sup> 1888  
 G.A. Hartman  
 County Clerk  
 By J.H. Parkes  
 Deputy

Jno C. Arnold  
 Surveyor for  
 Umatilla County, Oregon