

ROAD NO
169

Report of Viewers. Field Notes and Plat of Survey of a County Road
from Town of Helix to Vansycle Canyon,
Road No 169

Report of Viewers

To the Hon County Court for Umatilla County, Oregon

We the undersigned having been appointed by your Hon. body to view out and survey a County Road in the above named County and State would respectfully report that we met at the time and place appointed and after being qualified according to law by A. L. Coffey, County Surveyor for Umatilla County, Oregon, we called to our aid P. Nyelsing and W. B. Henderson as chainmen and J. L. Stockman as marker. We proceeded to view out and survey said Road commencing at the S. W. corner of the S. E. 1/4 of Sec 254 N. R 33. E. W. M. in the Town of Helix therein to a point where the Geer Spring Road enters Vansycle Canyon Road. We would further report the Road a practical one and much needed, easily opened and kept in repair and we would further recommend that the petition for said Road be granted. this 4th day of August 1883.

James Durran
J. L. Stockman
Wm Westfall

Field Notes

Commencing at the S. W. corner of the S. E. 1/4 of Sec 254 N. R 33 E of W. M. in the Town of Helix.

By planting a post marked R from which we run

Course	Distance	
North	39.40	and angle thence
West	58.00	" " "
N 23° W	80.00	Set post marked 1 m.
" " "	10.00	Angle thence
West	16.50	" "
N 15° W	21.50	" "
N 36° W	61.00	" "
N 30° W	71.00	" "
N 45° W	80.00	Set post marked 2 m
" " "	8.00	Angle thence
N 30° W	39.50	" "
N 5° W	65.00	" "
N 24° E	75.00	" "

Course	Distance	
N 7 W	80.00	Set post marked 3 m
" " "	35.00	Angle thence
N 20 W	61.00	" "
North	75.00	" "
N 7 W	80.00	Set post marked 4 m
" " "	20.00	Angle thence
North	41.00	" "
N 15° E	48.50	" "
N 3 E.	60.00	School House bears East 4.00 chs
" " "	65.00	Angle thence ^{2nd} intersect road
N 37 W	80.00	Set post marked 5 m.
N 26 E	30.50	Angle thence
N 37 W	43.00	" "
N 32 W	80.00	Set post marked 6 m.
" " "	4.00	Angle thence
N 25 W	16.00	Intersect road leading from the State Line to Geer Springs ^{2nd} planted a post marked R.

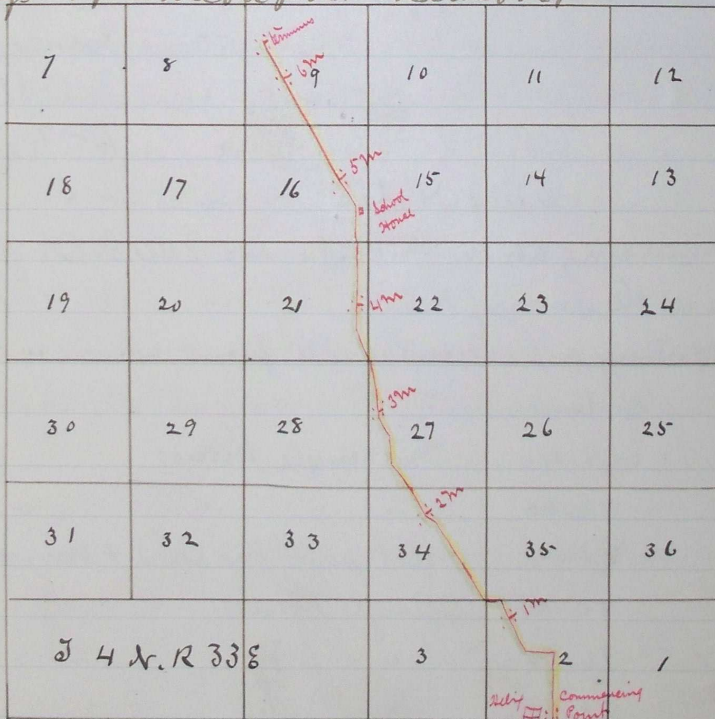

Journal T. Page 133
 " T " 223
 Recorded March 3 / 1883
 J. P. Bushie
 County Clerk

I hereby certify that the within is a true
 and correct plat ^{2nd} survey the above named
 Road this 10 day of August 1883.
 A. L. Coffey
 County Surveyor
 Umatilla Co. Oregon