

ROAD No
157.

Road No 157 Report of Viewers

To the Hon County Court for Umatilla County, Oregon

We the undersigned having been appointed by your Hon Body to view out ^{and} survey a Road No 157. Beginning at the $\frac{1}{2}$ mile post on the West line of Sec 26 Township 5. N. R 32. E. South 36 rods. Thence West 24 rods. Thence East 20° South 28 Rods to line of Sec 26. Thence South $53^{\circ} 35'$ Rods. Thence East 12 Rods. Thence South 25 Rods. Thence South 25° West 34 Rods. Thence South 8° East 30 Rods. Thence South 40° East 22 Rods. Thence South 214 Rods. Thence West 160 Rods. Thence South 580 Rods. Thence West 196 Rods to the County Road leading from Cold Springs to the Town of Pendleton.

We met at the time ^{and} place appointed ^{and} after being qualified according to law by W. W. Carvies. we called to our aid Jack Long as marker ^{and} A. R. Gordon ^{and} Melvin Petree. Chainmen. we proceeded to view ^{and} survey said Road as set forth in the order. we find the proposed road a good ^{and} practicable route ^{and} easily opened without any expense to the County. we would ask that the petition for said road be granted.

This the 1st day of October 1883.

A. R. Gordon } Viewers
Melvan Petree }

Field Notes ^{and} Survey of County Road from Juniper Canyon to Middle Cold Spring.

To the Hon County Court for Umatilla County.

I hereby certify that on the first day of October A. D. 1883 after qualifying A. R. Gordon. Melvin Petree as Chainmen ^{and} Jack Long marker under the directors A. R. Gordon & Melvin Petree. Viewers duly qualified by me. I proceeded the survey of a County Road for the above named County ^{and} State as described in the accompanying field notes of Survey.

Beginning at the $\frac{1}{2}$ mile post on West line of Sec 26 T. 5. N. R 32 E. set post marked R. Thence South 36 Rods. Thence West 24 Rods. Thence East 20° South 28 Rods back to said line. Thence South on said line 232 Rods set post marked 1 mile. Thence South 303 Rods. Thence East 12 Rods. Thence South 5 Rods set post marked 2 miles. same degree 20 Rods. Thence South 25° West 34 Rods. Thence South 30 Rods. Thence South 40° East 22 Rods. Thence South 214 Rods set post marked 3 miles. same degree 10 Rods. Thence West 160 Rods to center of Sec 10 Township 4. North Range 32 East. Thence South 160 Rods set post marked 4 miles. same degree 320 Rods set post marked 5 miles. Thence South 100 Rods to center of Middle Cold Spring County road. Thence West 120 Rods. Thence West 5° North 76 Rods to intersect County Road running from

Pendleton to Gold Spring County Road,
This the first day of Oct A. D. 1883,

W. W. Caviness, Surveyor.

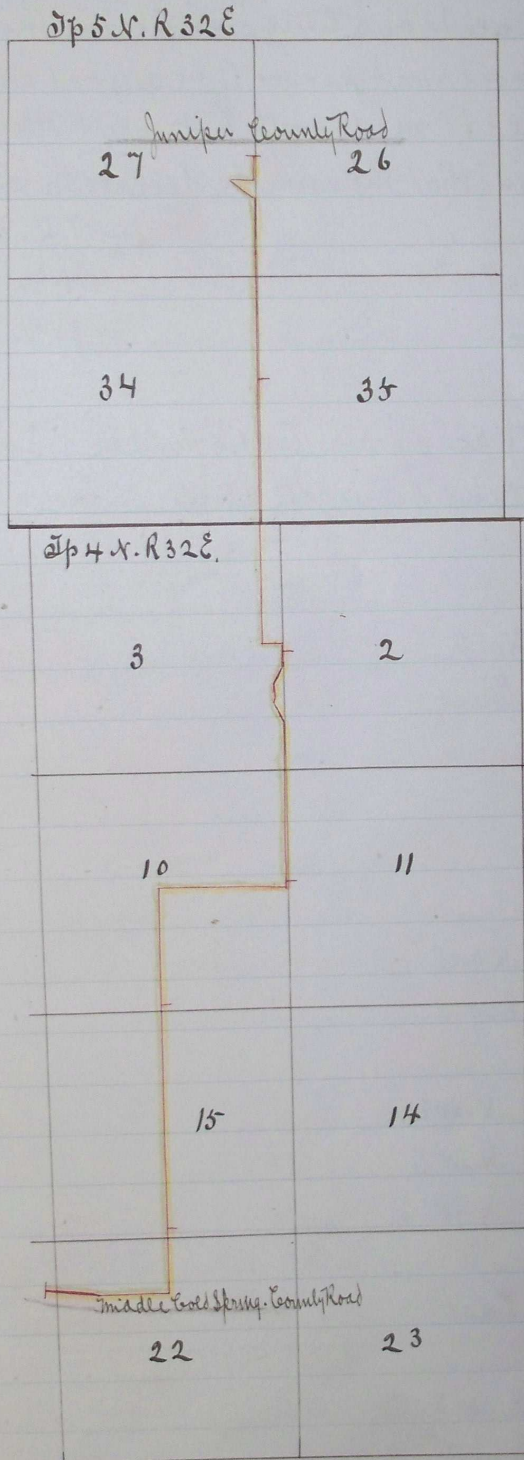

Journal F. pages 67-68

" F. " 238-

Recorded Feby 11th 1884

W. W. Caviness Clerk.