

ROAD NO  
328

in Road No 328m

Report of Viewers, field notes and plat of Survey of County Road No 328 in Multnomah County, Oregon commencing at the North East corner of the North West quarter of Section 26 T5 N R. 33 E Wm. running thence Westward as near the North line of the above mentioned land as practicable for a good road to a point on said line North of the North West corner of the house of Ben Casey thence in a North Westward and Westward direction down Vausyelle cañon along or near the route of the old road which runs along the foot of the North side of the Bluff to a point on the West line of the North East quarter of Sec 22 T5 N R 33 E Wm. intersected by the said old Road, thence North along the above mentioned West line to the Water Course of Vausyelle cañon, thence North Easterly about 20 rods to a stake marked W, at the track of the O. & W. V. R.R. thence across said track, thence Northwesterly parallel with said track to the East line of Section 16 Twp 5 N Range 33 E Wm. thence along the present route across the said track to the intersection of road No 313 near Vausyelle School House.

in Viewers Report Road No 328m

To the Hon. County Court  
for Multnomah County Oregon

We the undersigned viewers on Road No 328 would respectfully report that we met with Jno C. Arnold County Surveyor at Multnomah on June 19<sup>th</sup> at 9 o'clock am. and were qualified each as directed by law. We called A. E. Best and Justice Edward Ballahan and Tarsney Stewart to assist who were each qualified by taking usual oath of assistants. We proceeded to view out survey and mark said Road as specified in the petition for the same. We find the road located on good ground and very much needed from the fact it is the only outlet between upper and lower Vausyelle.

We would, therefore recommend that said road No 328 be declared a public highway.

John Coplin

N 88° 40' W 2  
4  
8  
S 84° 50' W 16  
N 35° 15' W 22  
32  
N 52° 10' W 4  
N 57° 50' W 68  
7  
N 48° 25' W 78  
S 84° 00' W 80  
4  
N 45° 30' W 136  
North  
17  
19  
23

Filed July 1<sup>st</sup> 1889  
J. W. Bartman (clerk)

Wm. Kern  
W. M. Deatt.

Field Notes of Road Survey No 328 Multnomah Co., Or.

Done by Wm. Kern W. M. Deatt and John Caplinger  
viewers on Road Survey No 328 for Multnomah  
County Or, at Multnomah in said County June 19<sup>th</sup>  
A.D. 1889 at 9 o'clock Am.

I administered the usual oath of Road-viewers  
to each after which we called A. S. Rest & Galloway  
to chain and A. S. Rest to mark, who were each  
qualified as required by law

I commence Road No 328 at the 1/4 Sec corner  
Sec 23 & 26 in T 5 N R 33 E 2nd the initial post  
is set 50 links N.E. of said cor so as to be out  
of way of travel on this road. From said  
1/4 Sec cor I run on line bet Secs 23 & 26 as  
above described Var 21°

N 88° 40' W	Chs 2.00	Mouth of Ravine - S. runs NW. Ascend
	4.50	Summit
	8.00	Set angle post at point on line of Road <sup>W</sup> turn
S 84° 50' W	16.74	" " " " " " " " " "
N 35° 15' W	23.50	Ravine - 2 runs NW.
	33.18	Set angle post at point on line of Road <sup>W</sup> turn
N 52° 10' W	45.16	" " " " 10 links South of " " " "
N 57° 50' W	68.92	Thence runs E. & W. - cross corner of field
	71.12	Set angle post on pt on line of Road fence runs N. & S. turn thence
N 43° 45' W	78.31	Intersect line E. & W. through center Sec 22 said Tp Set angle post at pt on line of road in narrow lane E. & W. and turn thence along said center line,
S 89° 00' W	80.00	Set 1 mile post 45 links South of Pt on line of Road
"	4.34	Set angle post at pt on line of Road 6 links N of E. & W. fence and turn thence,
N 45° 30' W	13.65	cut A on N side of post in old fence N. & S. on line through center said Sec 22 and turn thence on said line
North	17.64	Water channel in Vansycle Canon - 20 runs N. & W.
	19.10	Set angle post at pt on Road line 2 links W of N. & S. ditch <sup>W</sup> turn
N 38° 40' E	23.70	W post, position on S side of O. & W. R.R. track Set angle post at this pt and turn across said track

at of Survey  
County, Oregon.  
The  
E. & W.  
line of  
for a  
of The  
they  
direction  
the route  
of The  
line of  
om.  
with  
Water  
terly  
a track  
thence  
the East  
ence along  
intersec-  
course.  
  
red viewers  
at we  
at Multnomah  
qualified  
and Justice  
exist who  
th of as-  
and mark  
the same  
and serve  
by outlet  
aid road  
Caplinger

cr 80° 20' W 25.34 Det angle post at pt on Road line on S hill side and turn  
 cr 51° 00' W 31.00 Int line N.T.S. through center said Sec 22  
 43.44 Det angle post at pt on road line and turn thence  
 cr 31° 10' W. 63.64 Quich - 4' runs West  
 70.75 Det angle post at pt on road line and turn thence  
 cr 43° 00' W 80.00 " 2 mile " 45 links E of pt on road line at Mr  
 Staetens, continue course of last turn,  
 cr 43° 00' W 319 Det angle post at pt on road line N of RR. track & turn  
 cr 50° 10' W 12.75 Int Sec line bet Secs 15, 16. in said Tp  
 16.10 " O. & W. F.R.R. track  
 1832 " County Road cr 313 near School House  
 Det terminus S 51° W 45 links so as to be off the line  
 of travel

Note at 12 m Mr Jarsey Stewart was engaged to  
 mark the road.

I hereby certify that the foregoing field notes  
 of Road survey cr 328 for Luatilla County Or  
 are correct

Filed July 11 1889 }  
 W. A. Bartman Clerk

Jno C. Arnold  
 Surveyor.

S  
 W

24

25

Filed  
 by  
 R. A.

I hereby Certify the following to be a correct plat of the survey of Road 328 Township 5 N. Range 33 East of Willamette Meridian as made by me June 19<sup>th</sup> 1889

Jno C Arnold

Surveyor for Multnomah County Oregon

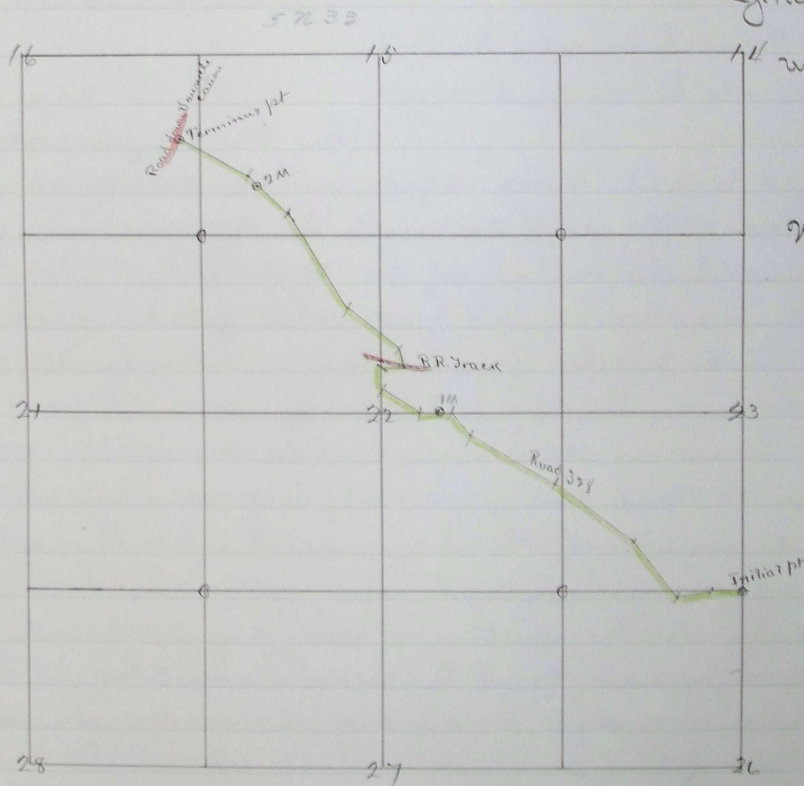

Filed July 3 - 1889 }  
by A. Martinan clerk  
by Geo. P. Rosenberg Deputy

Sept 8 1890 # 576