

Rd #88

Report Field notes & Plat of bounty  
Road from N E cor of NW 1/4 of Sec  
8 T. 4 N R 33 E down N fork to  
intersect middle fork of bold spring

To the Hon County Court

of Multnomah County Oregon

We the undersigned, having been appointed by  
your Hon body to view out and survey a bounty Road  
in the above named county and State would respectfully  
report that we met at the time and place appointed and  
after being qualified according to law by J. B. Arnold  
Deputy bounty surveyor called to our aid. B. F. Raley as  
marker and W. business and G. L. Sanders as chainbearers  
proceeded to view out said road commencing at N E cor of  
NW 1/4 of Sec 8 T. 4, N R. 33 E and running down the N fork  
of to intersect the middle fork of bold spring cañon we  
would further report the route a practical one, the Road  
is much needed and can be easily opened and kept in  
repair. we therefore would recommend that the petition  
for said Road be granted.

J. M. Gallagher  
G. L. Sanders  
J. B. Arnold  
Surveyor

Field Notes of Survey of bounty Road from N E cor  
of NW 1/4 of Sec 8 T. 4 N R 33 E down N fork to intersect  
middle fork of bold spring cañon

Begun Aug 2<sup>nd</sup> 1880

- Set initial post at 1/4 sec cor bet secs 5 & 8, T. 4 N R. 33 E
- N 8<sup>ch</sup> set angle stake in ravine
- N 72° W 30 " " " " flat N of boxes Res
- N 70° W 46 " " " " E of W business fence
- S 85° W 80 " 1 m P in cavines field on N bank of ravine
- S 86° W 31<sup>like</sup> 50 " a S of ravine in flat
- N 71° W 61 " " " " " " "
- N 87° W 80 " 2.5 m P N of Trav Road in flat
- " 35<sup>like</sup> 50 " a S " " " " "
- N 65° W 11 " " " at foot of hill on N side of flat
- N 46° W 24 intersect line passing E. + W. through center of sec 13, T. 4 N R 32 E
- set a S in flat N of above line through center of sec 1 (Business Res)
- W 80 along E + W center line sec 1, post 3 m P on E hill side N of W
- W 80 through center secs 1 + 2 post 4 m P. S of ravine in flat



- N 60° W <sup>ch 114</sup> 114 set a S in flat S of trav Road
- Rd # 88 N 71° W 38 " " " on hill side S of ravine
- N 58° W 45.50 " " " " Knoll S of trav R in gulch
- N 55° W 70 " " " " at foot of bluff S of Sulch
- N 34° W 76 down canon set a S. N. of Ravine
- N 82° W 80 across ravine set 5 m P on Knoll N of bend in ravine
- " 30 set a S on hill side S of trav Road
- S 80° W 57.71 down S side of canon set a S in S side of canon
- N 78° W 80 down flat through Mr Browns field set 6 m P in field N of trav R
- N 79° W 38 set a S on S side of Sulch at Adams sheep corral
- N 34 30' W 44.50 " " " S bank of Ravine
- N 62° W 52 " " " " " " " "
- N 72° W 80 down canon set 7 m P at foot of hill S of trav R
- " 27.50 " " " " " " " " set a S on S bank of Sulch in canon
- N 53° W 53.50 " " " " " " " " foot bluff on S side of "
- N 64° W 59 " " " " " " " " on S side of Ravine
- N 45° W 80 " " " " " " " " set 8 m P in canon
- " 4 " " " " " " " " a S " " " " N of trav R
- N 67° W 28 " " " " " " " " " " opposite canon on N + S
- N 65° W 39 " " " " " " " " " " canon N
- N 80° W 50 " " " " " " " " " " Rock Bluff on N
- N 85° W 61.50 " " " " " " " " " " 2 canons on N
- S 85° W 80 " " " " " " " " " " Bluff " "
- " 3.30 " " " " " " " " " " Rock Bluff
- S 87° W 43 " " " " " " " " " " Rocky gulch on N + S
- S 78° W 80 " " " " " " " " " " on Knoll of S Ravine
- " 11 along S hill side set a S. Rocky crescent on N
- S 65° W 29.50 down canon set a S Rocky Bank S
- N 67° 15' W 39.50 " " " " " " " " " " on S bank of gulch in canon
- S 71° W 75 " " " " " " " " " " S hill side Rocky cliff. N.
- S 75° W 80 " " " " " " " " " " 11.7 m P in canon Rocky gulch N
- " 15.50 " " " " " " " " " " Bluff "
- S 24° W 29 " " " " " " " " " " intersect middle fork set terminal post

whole distance 11 m 116. R. all the stakes and posts marked and numbered according to law. and the road well marked by travel

W. Sanders } chainbearers  
 S. B. Arnold Surveyor  
 B. D. Raley marker

Rd # 88



221 # 58

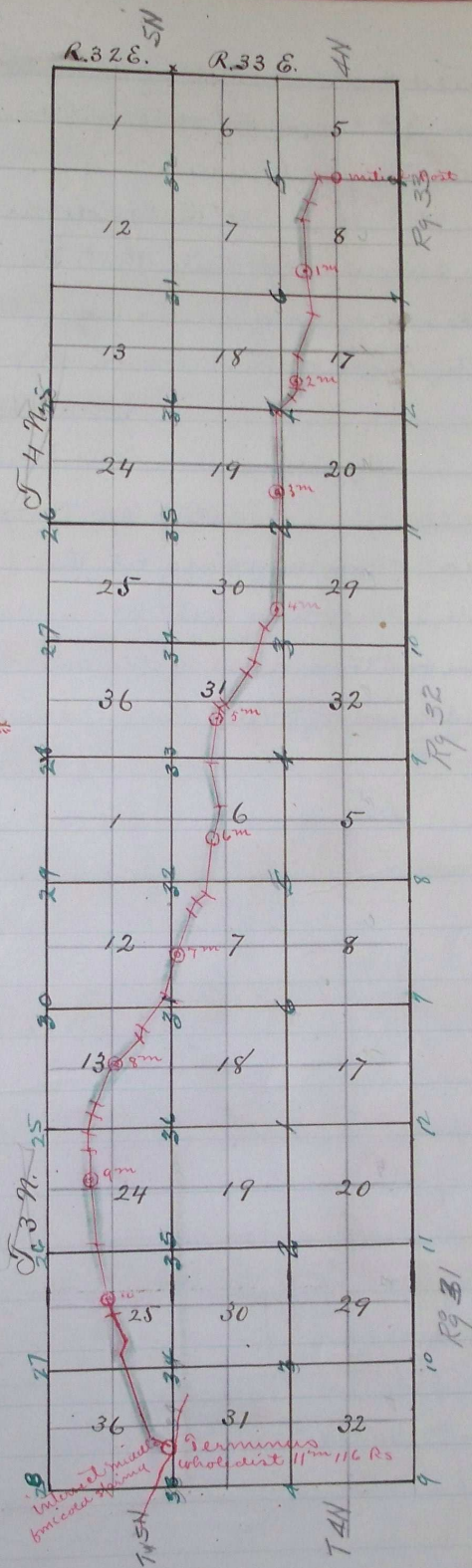

Plat of bounty Road from 1/4 sec ev bet secs 5 & 8  
 T. 4 N. R. 33 E. down r fork to intersect middle fork cold spring  
 canon. Matilla county Oregon scale 80' to 1" in  
 J. B. Arnold  
 Surveyor

Journal 10529  
 " " 603  
 " 8 46