

Road No 284

ROAD NO

284.

Report of Viewers. Field Notes^{and} Plat of Survey of Co Road Come^{at} S. W. cor of Sec 18 Tp 5 N. R 34 E, ^{and} ending at the 1/2 mile line in Sec 18 Tp 6 N. R 34 E

Report of Viewers

Hudson Bay Ranch May 13th 1887

To the Hon. County Court, Umatilla Co. Or.

We the undersigned, viewers appointed on Road Survey No 284 would report that we met Jno C. Arnold, County Surveyor, at the time ^{and} place appointed by your Hon. body, ^{and} proceeded to view out ^{and} survey said road as prayed for in the petition; we find the line of the road to pass over broken ^{and} hilly ground, but not so much so in our judgment as the Geer Spring or Butler road. ^{and} we think the grade will be much easier than either of the latter mentioned roads; we also find that there is no other road answering to the demands of the public in this locality, ^{and} verily believe that road No 284 as petitioned for is much needed as well for the public as for private advantages, ^{and} for these said reasons, we recommend that the road as viewed out ^{and} surveyed be granted the petitioners ^{and} the same declared a public highway.

John Glenn } Viewers
A. B. McEwen }

Field Notes of Road Survey No 284 for Umatilla Co. Or

I arrived at point of beginning May 12th 1887, 2 o'clock P. M. I find Mr. E. Broughton ^{and} learn from him that viewers have not received notices of appointment. I personally notify A. B. McEwen ^{and} send for John Glenn. I call E. Broughton ^{and} S. A. Crowell to carry the chain ^{and} S. A. Crowell to mark; after qualifying each respectively as required by law,

Set initial post in mound 40 links South east of cor. for

Secs 18. 19 ^{and} 13 & 24 on line bet. ranges

33 & 34 E. W. M. in T 5 N. ^{and} run of T p line

North ^{also} 25.00 Descend

41.30 Fence E & W. across cor. claimed to be 1/4 S. cor W. side Sec 18.

80.00 Set 1 mile post 23 links east of point.

At this point, I qualify Jno Glenn to act as Road Viewer in Survey 284, ^{and} as the proposed line for road passes through valley over wire fences impossible, at present, to take a team along, I employ Eno Goodman to drive team around ^{and} assist in getting stakes & posts to the points needed.

Continue Course - Descend

1.15 Cor. for Secs 7. 18 ^{and} 12 & 13 on T p line. Set angle stake

- on west hill side 30 feet east of point; turn
- N 28° 00' E 10.50 Cross gulch
- 15.97 Set angle stake 30' west of pt on E. hill side; turn
- N 52° 40' E 29.20 " " " " " " " " " "
- N 45° 40' E 39.30 " " " " " " " " " "
- N 9° 40' E 41.90 Parinton Springs gulch - 50; course N. W.; ascend
- 52.60 Ravine - 7'; course W.
- 53.50 Summit
- 62.50 Descend
- 72.00 Ravine, course W. ascend
- 78.50 Summit, descend
- 80.00 Set 2 mile post at point on west side of ridge
Angle from 2. m. post. descend along summit of ridge
- N 13° 25' E 32.50 Ascend 8'
- 35.97 Summit
- 36.97 Set angle stake 30' W. of pt. on summit of knoll; turn
- N 5° 15' E 38.00 Descend.
- N 5° 15' E 72.20 Intersect gur. Sec. line N 78 through Sec. 6, T 5 N. R 34 E.
Set angle stake 30' E. of pt. on W. hill side; turn
- N 1° 55' E 75.84 1/4 S. cor. bet. Secs 6 & 31 T 5 N. R. 34 E.
- 78.30 Cross gulch - 100; course N. E. - ascend
- 80.00 Set 3 mile post on line, East hill side.
Continue course, gur. Sec line N 78 through Sec 31
- 7.00 Summit
- 14.18 Cross fence, course E & W.
- 20.50 Ravine - 6', course N. E.
- 27.50 Summit
- 32.27 Dig & wire fence E & W. Enter wheat field about 25 links west of S. E. corner
- 36.00 Descend
- 51.10 Ravine - 10', course N. E. + ascend
- 54.50 Summit - descend
- 58.50 Leave wheat field & enter pasture
- 80.00 Set 4 mile post a few feet east of point on E. bank of Willow
Starling's gulch, in stone mound, angles from mile
post by sun N. 5° W (Var 20° E)
- N 5° 00' W. 20.50 Set angle stake 30' E. of point on W. hill side, turn
- N 6° 00' E 34.70 Ascend 12', from gulch which bears N. E.
- 36.80 Descend
- 38.30 Ravine - 10', course E.

42.50 Out A on post in wire fence N 78. ⁹⁰ turn
 North 43.50 Descend
 54.00 Flat
 72.00 Ascend
 73.72 Summit
 80.00 Set 5 mile post 20' east of wire fence
 Continue Course
 2.50 Descend
 11.70 Ravine Course E.
 12.00 Ascend
 17.00 Summit
 34.00 Fence E & W
 40.00 Set terminus 20' E of pt

I hereby certify the foregoing are the correct field notes of Road Survey 284
 Jno B. Arnold, Survr, Umatilla Co. Or.

Plat of Road Survey No 284.

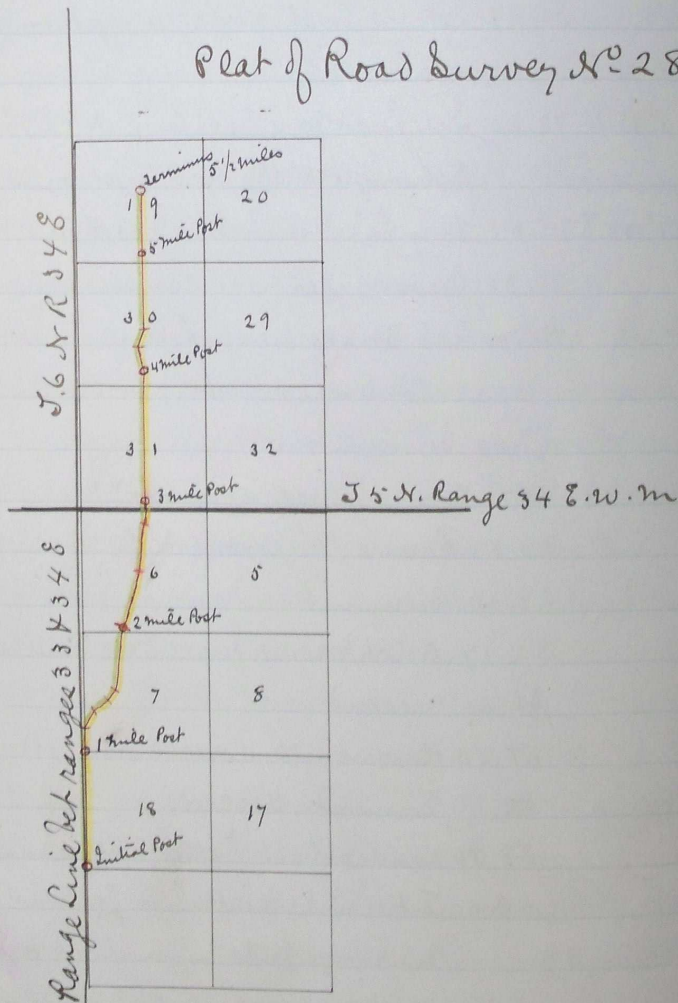

Journal G. page 521.
 " G. " 583

Recorded July 20th 1887

G. A. Hartman
 Clerk

By J. H. Parkes, Deputy

Vault Box No 279.

I hereby certify the foregoing to be a
 correct plat showing Road Survey No 284, for
 Umatilla Co. Oregon.

Jno B. Arnold, County Survr