

Road No. 441.

ROAD NO
441.

In the Matter of Viewing, Surveying and Laying out Road Survey No. 441, for Umatilla County, Oregon.

Commencing at the North East corner of Section 26, Twp 6 North Range 34 E. N. M. Running thence South $\frac{1}{4}$ mile; thence West $\frac{1}{4}$ mile; thence South $\frac{1}{4}$ mile; thence West $\frac{1}{4}$ mile to the center of said section 26; thence South-West-erly about 80 rods to Pine Creek; thence up the East bank of Pine Creek in a South-Westerly direction to the section line between Secs No. 34 + 35; thence North about 50 rods to the North East corner of Section 34; thence West $\frac{1}{2}$ mile; thence South $\frac{1}{2}$ mile to center of Section 34. Said road to be sixty feet wide.

Viewers Report.

In the County Court for Umatilla County, State of Oregon.

In the Matter of the Petition of
J. Dickerson & 21 others for the
Establishment of a County Road

To the Honorable County Court, above named:

We the undersigned Viewers, appointed by the Honorable Court, to view survey and lay out a County road as prayed for in the petition of J. Dickerson and others, beg leave to report:

That pursuant to said order we met at Bartlett's Hotel, in Milton, Oregon, on the 29th day of May, 1894, at the hour of 8 o'clock, a. m., of said day, the same being the time and place fixed by said order for the meeting of the undersigned viewers and Jno. C. Arnold, surveyor, appointed to survey said road, and after first taking an oath faithfully and impartially to discharge the duties of our appointment, we took to our assistance Ed. Hodgson and H. M. Pitner as chain bearers and as marker, and proceeded to view, survey and lay out said road as prayed for in said petition, as near as in our opinion a good road can be made at a reasonable expense, taking into consideration the utility, convenience and inconvenience and expense which will result to individuals as well as the public, if such road shall be established and opened.

The said Jno. C. Arnold, Surveyor, surveyed said road under our directions, and the same was conspicuously marked throughout the corners and distances thereon noted, and all trees on the line of said road were marked on each of the sides thereof corresponding with the direction of said road, with three notches cut through the bark and one inch into the wood, and all trees adjacent to the said line of said road were plainly blazed on the side facing said road. The beginning and termination of said road and the termination of each mile and intermediate points have been marked in the manner provided by law as will more fully appear by the certified return of said Surveyor of said road which is herunto attached and made a part of this report.

South
West
South
West

S. 48° 20' 27"

S. 23° 15' 27"

S. 19° 03' 27"

S. 46° 33' 17"

S. 5° 43' 17"

S. 28° 53' 47"

S. 17° 43' 27"

S. 48° 13' 27"

S. 53° 43' 27"

Survey
 range 34
 Rough
 the West
 it is a
 chance
 1/2 mile
 feet wide.

That in our opinion the said proposed road should be established for the following reasons:

- 1st. The route is quite practicable.
- 2d. The road is much needed for an outlet to residents within its vicinity.

Dated this 29th day of May, 1894.

George DeHaven
 A. M. Elam
 H. L. Frazier
 Viewers

Filed June 30, 1894
 W. M. Purce County Clerk
 By C. M. Purce, Deputy.

Field Notes of Road Survey No. 441.
 For Umatilla County, Oregon.

Pursuant to order, I met A. M. Elam, George DeHaven, and H. L. Frazier, the appointed board of viewers on Road Survey No. 441, for Umatilla County, Oregon, at T. Bartlett's Hotel, in Milton, said County and State, who qualify, each, as required by law. Ed. Hodgens and H. M. Ritner were called and sworn, as per law, to act as chain bearers.

Using a Polar Compass, adjusted to the suns declination for June 29, 1894, the date of meeting the said viewers, I commence at stone cor. to sees 23, 24, 25 and 26, T. 6, N. R. 34 E. - setting the initial post 42 1/2 ft (2. W. from said see cor., I run on line, between sees 25 and 26, said T.

vicin
 Dick
 Uton,
 said
 ing of
 pur-
 tially
 Ed.
 ded
 is near
 xl.
 e and
 such
 our
 mers
 here
 of said
 wood,
 aged
 id road
 ven.
 ppear
 herunto

South	1320 ft	Ret 1, and turn, thence R. 90°	ca. 21°, 30' E.
West	2640 "	" 2 " " " S. 90°	
South	3960 "	" 3 " " " R. 90°	
West	5290 "	" 4 at probable center see 26 - set 1 m pin end of earth 4 ft base x 2 ft high - fir 4" x 4", 4' long, mkd 1M on S. face, and set 30' N of line; turn thence S 41°, 30'.	
S. 48°, 30' W	32 "	Int. fence N ^d S.; E. bank of ditch 18' wide, brs. N.	
	162 "	E. bank of branch of Dry Creek, 33' wide, runs N. W.	
	200 "	Ret 5 in flat, and turn thence S 25°, 15'.	
S. 23°, 15' W	410 "	E. bank of main chan. of Dry Creek 20' wide, course N. W.	
	480 "	Ret 6, and turn thence S 40°, 12'.	
S. 19°, 03' W	1134 "	" 7 " " " R. 27°, 30'.	
S. 46°, 33' W	2164 "	" 8 " " " S. 30°, 50'.	
S. 15°, 43' W	2743 "	" 9 " " " R. 13°, 10'.	
S. 28°, 53' W	3150 "	" 10 " " " S. 11°, 10'.	
S. 17°, 43' W	3492 "	" 11 " " " R. 30°, 30'.	
S. 48°, 13' W	4151 "	" 12 " " " R. 35°, 30'.	
S. 13°, 43' W	4440 "	E. bank of Pine creek, 50' on line, runs nearly N. at this pt.	

- 4741 ft Ret 13 and turn thence R. 83°, 05'.
 N 13°, 12' W 5250 .. " 2 m post, which is a regulation post. fir. 30' W of line in E. Mound
 4 ft base x 2 ft high, continue last course.
 128 .. Ret 14, angle in lane S 92° W, turn thence S 81°, 40'
 S. 85°, 08' W along lane on reputed line bet pccs 27th & 34.
 400 .. Ascend hill.
 515 .. Summit. Descend.
 700 .. Dry Gulch. Course N. E. - ascend.
 1300 .. Summit - Level.
 1400 .. Descend.
 1800 .. Dry Gulch - Ascend.
 2350 .. Summit - Descend. 25'.
 S 85°, 08' W 2616 .. Wire fence, N 92° S. through center - pcc 34.
 Ret 15 and turn thence S. 83°, 05' along lane N 92° S.
 S 2°, 03' W 3200 .. Ascend hill.
 3900 .. Summit.
 4050 .. Descend and at 4200' Dry gulch, Course N. E. - ascend.
 5030 .. S. end of lane, set terminal post on line, a fir 4" x 4" x 4", in md. of E.
 4 base x 2 high, post mtd R 441, on N face.

I hereby certify that the foregoing are the correct field notes for
 Road Survey No. 441, for Umatilla County, Oregon.

Jno. C. Arnold, Co. Surveyor.

Filed June 30, 1894.

W. M. Pierce, Clerk.

By C. M. Peice, Deputy.

Plat of County Road No 441, Umatilla Co Oregon

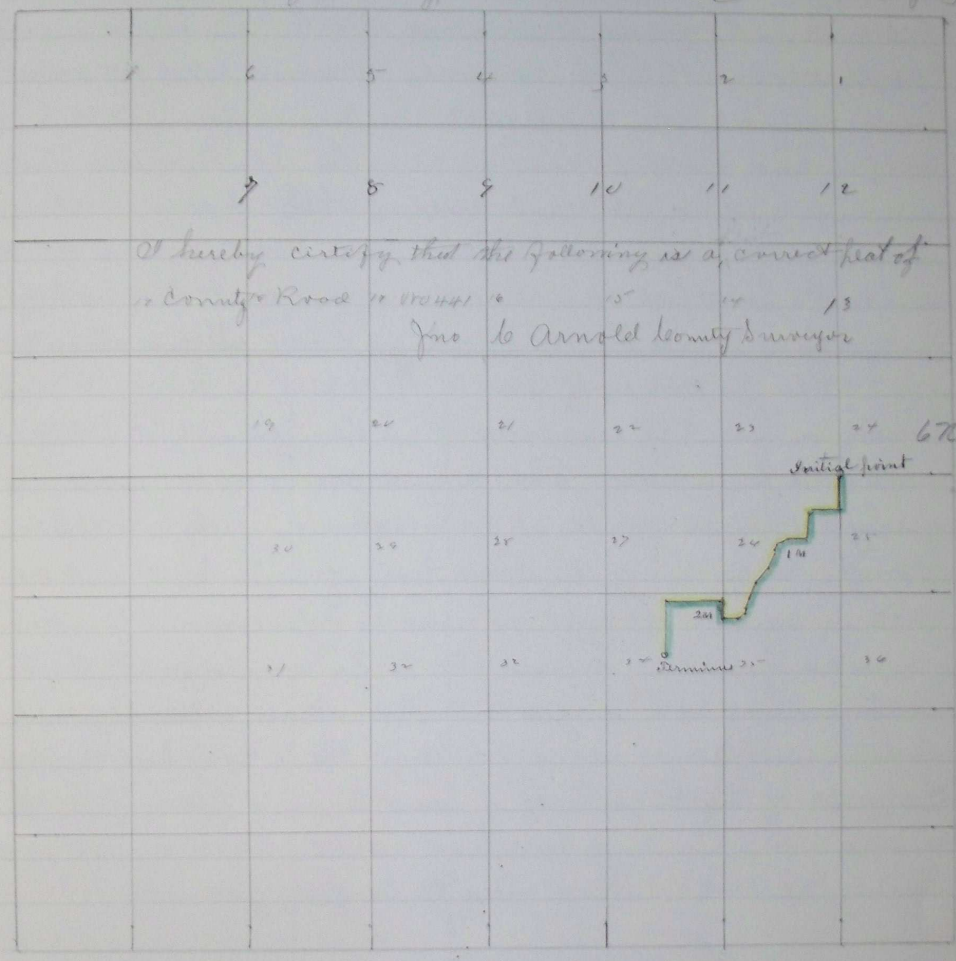

I hereby certify that the following is a correct plat of
County Road No 441
file to Arnold County Surveyor

Filed June 30-1894
W M Pierce ^{clerk}
By C M Pierce
deputy

July 7 1894 J 184