

Report, Survey and Plat of Co. Road from Pine cr. where Crow's road crosses

rd #35

to

Dissection of Co. Road from Weston to Perkins.

Umatilla County July 20 / 1874

To the Honorable County Court

Umatilla County State of Oregon

The undersigned viewers appointed at July term of said court to view out a road commencing at a point on Pine creek where the Crow's road crosses & running up said creek thence up the Samar gulch thence to intersect the County Road leading from Weston to Perkins Beg leave to make the following report & after being sworn we proceeded in company with the County Surveyor to view out survey & mark of said road as the law directs and in accordance with the petition, and recommend the location of the same as a County road it being in our opinion a public necessity.

J. M. Johns

B. J. Wing

Field Notes.

Station	Bearings	Chains	Miles	Remarks	Station	Bearings	Chains	Miles	Remarks
1	S 50 E	14		Commencing at Crow's road &	35	S 7 N	9		
2	S 77 E	6		following up Pine creek	36	S 27 E	5		
3	S 56 E	10			37	South	7		
4	East	5			38	S 4 E	18		
5	S 67 E	22			39	S 27 E	0	0	
6	S 30 E	23	1		40	S 27 E	10		
7	S 30 E	28			41	S 20 N	7		
8	S 18 E	12			42	S 4 E	8		
9	S 9 N	13			43	S 30 E	7		
10	South	23			44	South	16		
11	S 43 E	4	2		45	S 18 E	4		To the main gulch
12	S 48 E	5			46	S 27 E	19		
13	S 75 E	7			47	S 17 N	9	6	
14	S 8 N	10		Follows up creek	48	S 17 N	26		
15	S 43 E	12			49	South	27		To corner of 0, 20 1/2 1/2 1/2 1/2 1/2 1/2
16	S 9 N	10			50	S 10 E	14		Near Bailey's house
17	S 88 E	5			51	S 20 E	11		
18	S 5 N	8			52	S 34 E	2	7	Near Swaggart's
19	S 80 E	5			53	S 34 E	20		To Stampers Ranch
20	S 47 E	4			54	East	60	8	
21	S 9 E	6	3		55	East	3		To 1/2 mile stake between 819
22	S 18 N	21		To Sam Johnson's Sheep Ranch	56	South	20		
23	South	16			57	East	20		
24	S 27 E	7			58	South	20		
25	S 16 E	6		Road follows	59	East	17	9	
26	S 35 E	6		up	60	East	3		
27	S 70 N	4		creek	61	South	27	10	
28	S 29 E	7			62	South	50	11	Crosses Co. Road near Stagg & passing Rogers
29	S 12 E	7			63	South	62		
30	S 67 E	4	4		64	East	20		
31	S 46 E	6		Narrow canyon					(Continued. Page 74)
32	South	5							
33	S 82 N	17							
34	S 12 N	5							

Field Notes. (continued)

Station	Bearings	Chains	Meters
65	South	39	
66	East	12 1/2	
67	East	5	12 1/2

Remarks

Rd #45

to intersection of Perkins Road.

I certify that the within is a true copy of the field notes of the survey made by me of a road commencing at the cross road on Pine Creek thence up Pine Creek & up the mass Gulch thence to intersect the Co Road running from Weston to Perkins as called for in the petition

J. N. Sharon

Co Surveyor

I certify that the annexed is a true plat of the County Road as surveyed by me commencing at the cross Road on Pine Creek & ending at County road running from Weston to Perkins.

J. N. Sharon
Co Surveyor

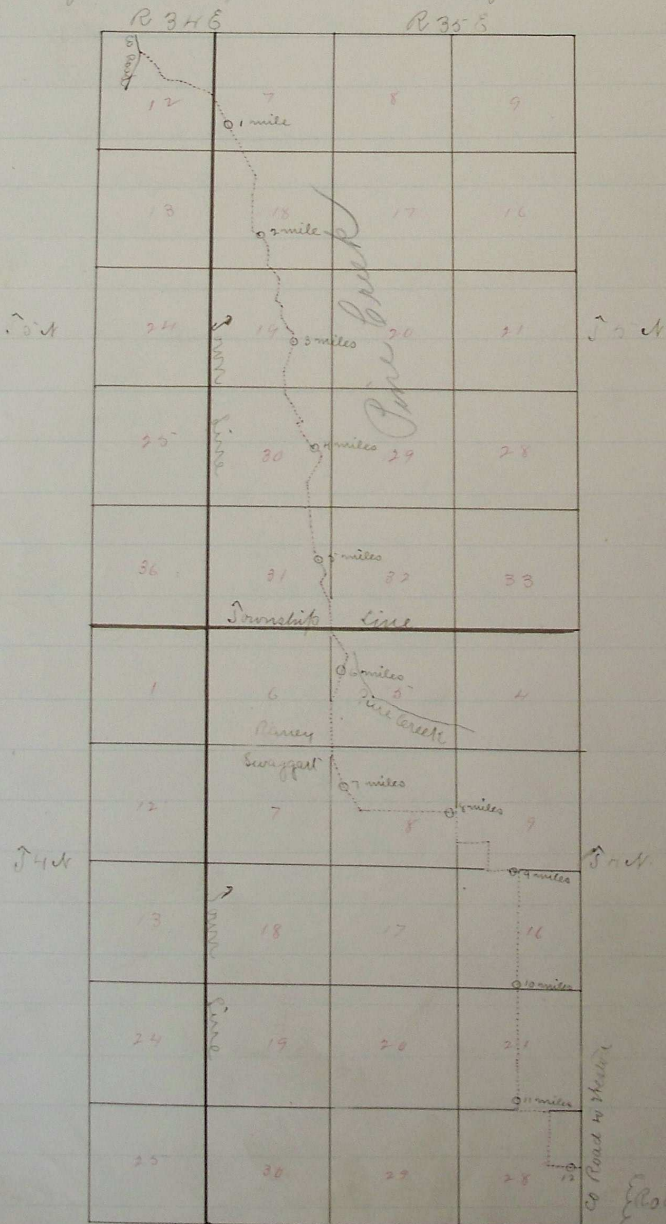

Road granted & located Sept. 10th 1874
See Co. Court Journal p. page 401