

1

BEGINNING OF PROJECT

UMATILLA COUNTY OREGON  
COUNTY ENGINEER'S OFFICE  
**COUNTY ROAD NO. 855**  
SCALE 1 IN. = 400 FT. SEPT. 1925  
T 3 N. R 34 - 35. E. W. M  
T 4 N. R 34 - 35. E. W. M

BEGINNING OF PROJECT

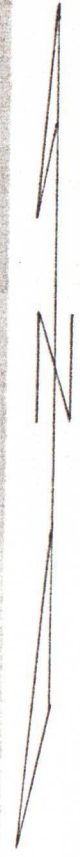

UMATILLA COUNTY OREGON  
COUNTY ENGINEER'S OFFICE

COUNTY ROAD NO 855

3

33

3

30'

TON

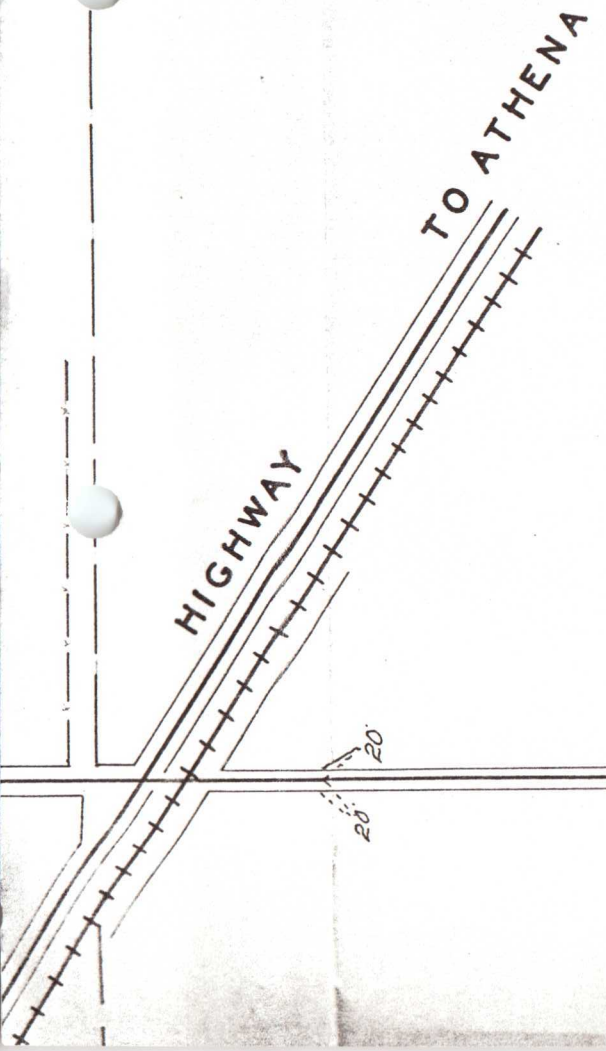

T 4 N. R 34. E. W. M.

T 3 N. R 34. E. W. M.

6

T 4 N. R 3 4. E. W. M.  
T 4 N. R 3 5. E. W. M.

T 4 N. R 35. E. W. M.

T 3 N. R 35. E. W. M.







110

