

Report: Survey and Plat of County Road from Irelands Crossing on the Willa Watta river

Rd #15

Snyder & Reeds Saw mill

State of Oregon County of Wmatta June 19 1871

The the Reviewers appointed by your honorable body to review a County Road from Irelands crossing on the Willa Watta river to Snyder and Reeds mill beg leave to submit the following report that we proceeded according to notice on the 2^d Monday in June to review and locate said road according to the application and our instructions to wit commenced at Irelands crossing and found a good practical way for road to George Sargents on Dry creek locating the same on and along the road as it now runs and from George Sargents to Henry Boyces found a good route for road there being but little work to do to make a good wagon road from thence to the North East corner of Dayer & Greens land claim thence South along said line to Weston thence South to the center of Neffs land claim thence due East to a point intersecting the old road running from Weston to Snyder and Reeds mill thence along said road as it now runs to Snyder & Reeds mill and would represent that we found a splendid way or route the entire distance of said road and that it shortens the distance from Irelands to Weston some two miles and on better ground for a road. But we were very much disappointed by the County Surveyors not meeting us we therefore cannot give the distance on this route nor could we mark it with any accuracy we therefore recommend that this road be reestablished and surveyed.

all of which we most respectfully submit

J. S. White

Jackson Nelson

C. Wardley

Piedmont Oct. 2nd 1871

Rd #15

J. N. Sharon after being duly sworn as Surveyor by the Reviewers of the within road proceeded to survey the same & submit the following as the field notes & plat of same

Chainman sworn were

C. C. Clark & J^m

J. N. S.

J. N. Sharon

Surveyor

Commencing at Ireland's ford on Walla Walla River at a tree 50 rods N & E of Sth corner Sec 1 T⁵ S¹ R³⁰ E & running thence as follows to Sanders mill.

Station	Course	Distance	Remarks
1	South	10	
2	1 st S 27° E	70	
3	S 21° E	13	
4	S 1° E	7	
5	S	16	Leave Walla Walla River Valley
6	2 nd S 12° 21'	14	
7	S 5° 21'	31	ascending ground
8	S 18° 21'	40	do
9	S 12° 21'	30	
10	3 rd S 6° 21'	10	on level ground
11	4 th South	50	do
12	S 43° 21'	40	
13	S 45° 21'	20	
14	S 66° 21'	7	
15	5 th S 10° 21'	13	descending ground approaching dry creek
16	S 20° 21'	13	On dry creek
17	S 30° 21'	5	Gen. Sargents Ranch on right
18	S 27° 21'	22	Road runs along creek
19	S 5° E	30	
20	6 th South	10	1/2 mile stake near corner Waldrons field
21	S 31° E	16	
22	S 14° 21'	4	
23	S 17° 21'	14	
24	S 17° 21'	14	
25	S 12° 21'	12	
26	S 16° 21'	17	Leave dry creek
27	7 th S 62° 21'	3	Judge Waldrons house
28	S 61° 21'	20	
29	S 49° 21'	53	
30	S 28° 21'	22	Do ck. corner J. N. B. Greens farm
31	8 th South	8	
32	South	73	
33	S 60° E	1	
34	9 th S 5° E	6	
35	S 5° E	10	moult Mays Lane
36	S 24° 21'	4	
37	South	39	Do main street Weston
38	S 10° 21'	10	
39	10 th S 9° E	17	Do James Linsaltes House
40	11 th South	80	Near Pinkertons
41	South	74	Corner McKnight's
42	12 th E	6	Passing through McKnight's farm
43	East	34	Do Kimberlands farm
44	S 28° E	16	Climbing the mountain
45	13 S 40° E	36	
46	S 40° E	20	Up the mountain
47	14 S 67° E	60	level ground
48	S 67° E	63	
49	15 S 60° E	27	

(continued p. 23)

Field Notes (continued)

Rd #15	Stations, & mins.	Course	Dist. chains	Remarks
	30	N 73° E	36	
	31 16	N 60° E	24	
	32	N 60° E	30	
	33	N 77° E	40	
	34 7	S 40° E	10	
	35	S 45° E	40	
	36 17 3/4	S 25° E	20	To Snyders mill

I hereby certify that the above is a correct copy of the field notes of the road surveyed by me as per order of the Court to viewers. Said road extending from Irelands ford on Wulla Wulla River to Snyders mill accompanying this is the plat of the same.

J. H. Sharron

Surveyor

Rd #15

Plat of Road from Delaunts ford

JD

Smylers & Reeds mill
Range 35 E

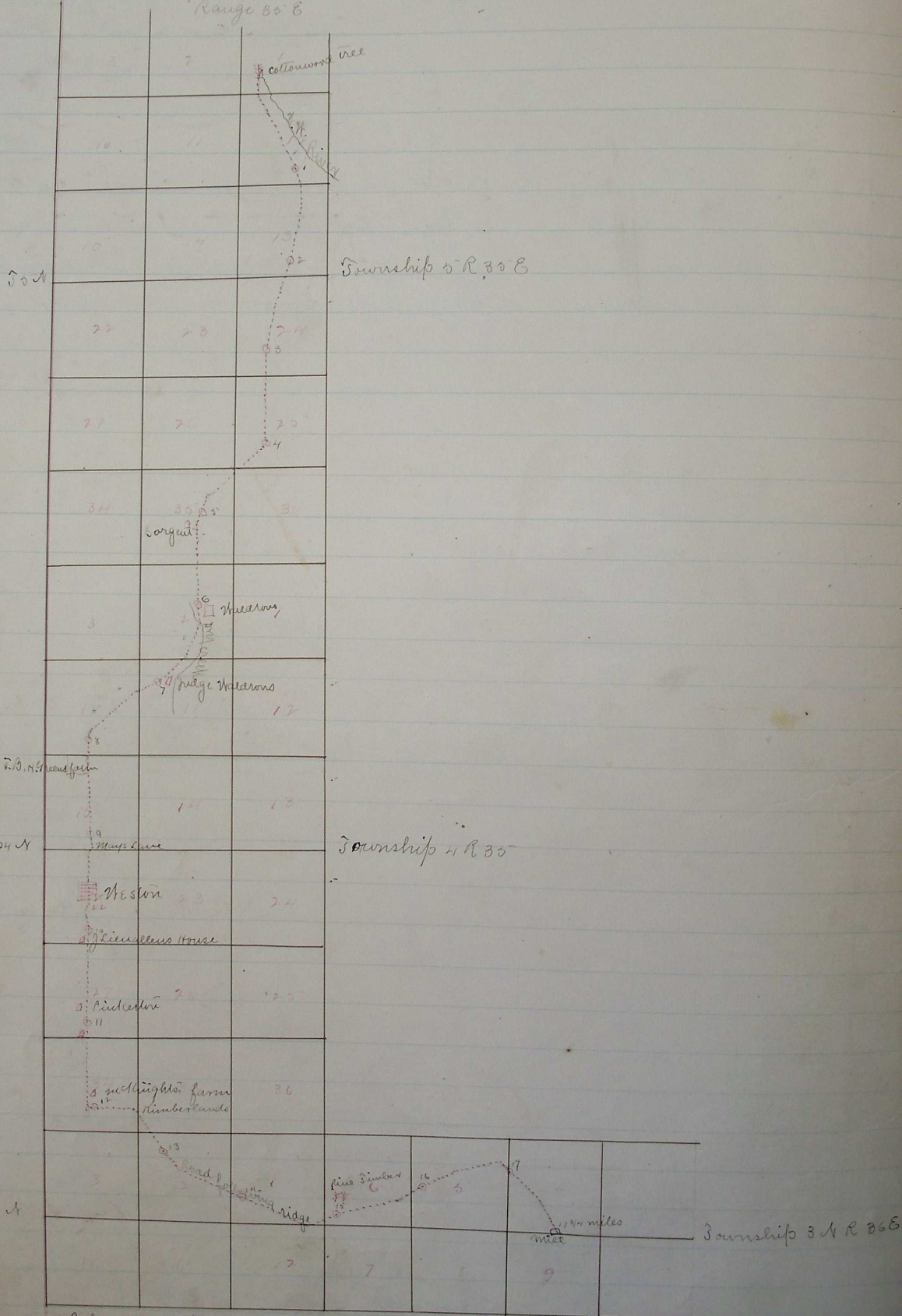

I hereby certify that the above is a correct plat of the road as surveyed by me from Delaunts ford of Walla Walla River to Smylers mill as petition called for, accompanying this is the field notes of the same.

J H Sanner Surveyor

Road granted Oct. 2nd 1871, See Co. Court Journal, 5th page 105