

ROAD NO.

348.

## Road No 348,

Report of Viewers, field notes and plat of survey of County Road No 348 in Umatilla County, Oregon

Commencing at a point of the County Road in Township 3 north of Range 36 East 10<sup>th</sup> M. at or about the center of the North East  $\frac{1}{4}$  of Section 8. Thence running South on said center line to the brakes of Wild Horse Creek Thence East up the brakes along said creek for about 40 rods, thence down said creek for about 20 rods, thence crossing said Creek below a certain watering place in the said creek, thence up the Creek on South side on the most practical route till it strikes a certain Cañon Thence South up said Cañon to Mr R. Soderhunters Residence, Thence South East to section line between Sections 8 & 9, Thence South on said line to the South prong Wild Horse Creek, Thence down the brakes of said Creek for about  $\frac{1}{4}$  mile, Thence West about  $\frac{1}{4}$  mile on center line of Section 8, Thence South West to North line of the South  $\frac{1}{2}$  of South West  $\frac{1}{4}$  of Section 8, Thence a little NW down a certain cañon on South side for about  $\frac{1}{2}$  mile, thence down a certain cañon running a little S, till it strikes the Wild Horse Creek on the Indian Reservation line, Thence from section line running between Sections 8 & 9, to follow up on the North side of the South prong Wild Horse Creek in the most practical course to the stake of the North East corner of Umatilla Indian Reserves. Thence East on section line between Sections 10 & 15 as near as practical to the South East corner of Section 10 Thence on section line running South for about  $\frac{1}{4}$  mile till it intersects the Road on the brakes of the Umatilla River, all in T<sup>3</sup> P<sup>3</sup> North of Range 36 E. 10<sup>th</sup> M. Umatilla Co Oregon total distance of said new road about 6 miles, said road to be 40 feet wide

## Report of Viewers on Road No 348

To the Hon County Court  
of Umatilla County, Oregon

In the matter of Road No 348,

We the undersigned viewers would respectfully report that we met J. N. Lawrey Surveyor



at the place appointed on Thursday Jan 28<sup>th</sup> 1891 and that we called to our aid E.L. Barnett and M. Tushman as chairman, Richard Kilgore marker and L.F. McCabe as man

That we were each and each of our assistants duly qualified by the Surveyor as directed by law, that we proceeded forthwith to view and survey and locate Road No 348. That we find the route selected to be a practical one for a Mountain road, and as the petitioners ask no aid from the County in the construction or opening of said road and from the further fact that in a comparatively short time they will be able to construct a fairly good road of which there is at present great need we recommend that the petition be granted and Road No 348 be declared a County Road

Dated at  
Athena Oregon  
This 25<sup>th</sup> day of Feb 1891

E.L. Barnett }  
J.E. McQuary } Viewers

Field Notes of Road Survey No 348 Umatilla County Oregon.

I met E.L. Barnett and J.E. McQuary, Viewers at Athena on Thursday morning Jan 28<sup>th</sup> 1891. We called to aid E.L. Barnett and Richard Tushman as chairman, Robert Kilgore as marker and L.F. McCabe as man each of whom was qualified as directed by law. I set initial post at or about center of NE 1/4 of Sec 5 T4p 3 NR 36 E 20 W.

S 25° E			
N 62° E	1800	Set angle stake	
S 50° 30' E	2020	" " "	
S 76° 30' E	2512	" " "	
S 55° E	2900	" " "	near Creek
N 76° 30'	3100	" " "	
S 61° 30' E	4000	" " "	
S 30°	11800	" " "	at mouth of Canyon
	5230	" 1 m. S. 30 ft from line	
S 21° 30' E	5401	" Angle Stake	
S 77° E	6100	" " "	in Gulch near Tushman's house
South	7300	" " "	near McCabes house
S 68° 30' W.	8900	" " "	
S 61° W	9900	" " "	
West	10300	" " "	

S 10° W  
West  
S 50° W  
S 77° 30' W  
N 86° 30' W  
S 62° W  
S 55° W  
S 62° W  
S 51° W  
S 46° 30' W  
S 81° W

N 68' 30" E  
S 82° E  
S 56° E  
S 79° E  
East  
S 48° 30' E  
S 61° E  
S 57° 30' E  
N 54° 30' E  
N 85° 30' E  
S 49° 45' E  
S 55° 30' E  
S 19° 30' E



1891	S 100° W	11800.	Set angle stake
and	West	13275	" " " at Barry - Davidson division fence
more	S 80° W	14100	" " "
	S 77° 30' W	121445	" " "
facts	N 86° 30' W	15300	" " "
that	S 62° W	16457	" " "
and	S 85° W	17600	" " "
lected	S 62° W	18536	" " "
as	S 51° W	20304	" " "
the	S 46° 30' W	20820	" " "
	S 81° W	20945	" " "
		21600	Set terminal post in bottom gulch thirty feet from line

Beginning at 8300 Set angle stake and prepared to run out that part of road leading to and intersecting a road on the banks of the Unatella River

	N 68° 30' E		Set angle stake
	S 82° E	1000	" " "
	S 56° E	2090	" " "
	S 79° E	2633	" " "
	East	3600	" " "
Thurs	S 48° 30' E	5010	" " "
and	S 61° E	5280	" " "
mar-	S 57° 30' E	6950	" " "
alified	N 54° 30' E	8846	" " "
of	N 85° 30' E	9236	" " "
	S 49° 45' E	9500	" " "
	S 85° 30' E	12160	" " "
	S 19° 30' E	12363	" " "

*See line change below.*

13500 Set terminal post 30 ft E of line and blazed two trees. Blazed trees along entire line route indicate the line of the road. After the survey had been completed we found that through some misunderstanding between Messrs Johnson and Cregan a change must be made and accordingly on Wednesday Feb 25 1891 I met E. L. Barnett and J. E. McQuary Viewers. We called to our aid E. L. Barnett and J. E. McQuary to act as chainmen and markers and each of them having been duly qualified as directed by law we proceeded to make the change desired. It is as follows Beginning at a point 1520 ft from the initial post I set an angle stake and ran S 230° 30' W for a distance



of 400 ft. then set an angle stake and ran  $\$ 39^{\circ} 30' E$  a distance of 300 ft to the angle stake on the bank of the Creek and marked in notes as being 2900 ft from place of beginning. This makes a difference in the location of mile of 620 ft in the total distance and there is therefore that much difference in the location of mile posts and angle stakes as made by original survey and that brought about by the change in location. As there was from two to four feet of snow on the level we did not deem it advisable to attempt making these changes

J. H. Lawrey  
Surveyor

Filed March 3<sup>rd</sup> 1891  
at 11:15 P.M. Clear



30' E of  
of the Creek  
of begin-  
side of  
before  
mile posts  
and  
As there  
not we  
ing there

I hereby certify the following to be a correct plot of  
the No 348 Road survey as made by me Jan 25<sup>th</sup> 1891  
J. D. Sawrey  
Surveyor

Filed March 3<sup>rd</sup> 1891  
C. W. Pierce Clerk

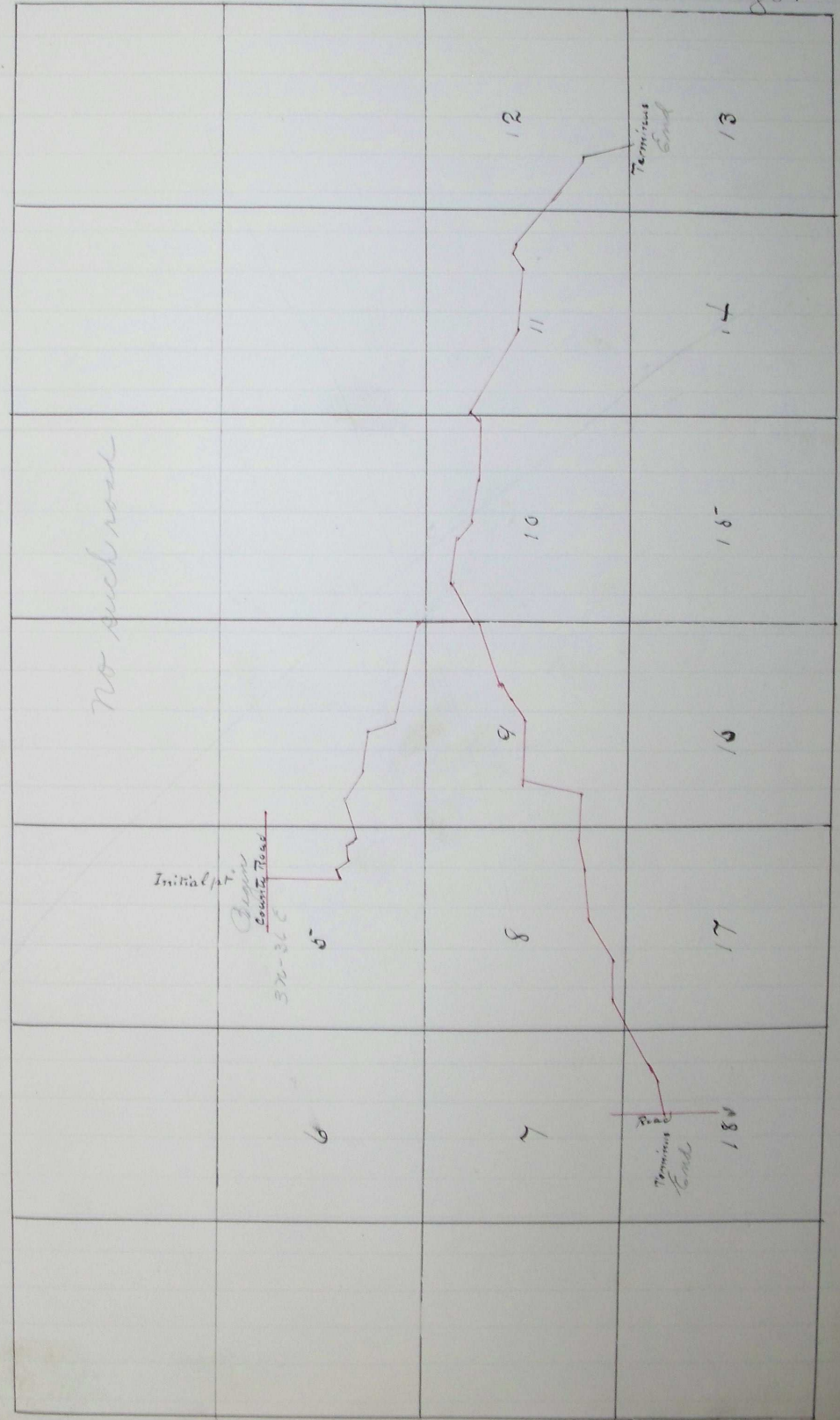

No such road

Initial pt

Begin  
Count Here

370-360

30' E

6

8

12

9

10

11

12

Terminus  
End

AS 1

17

16

15

14

13