

ROAD No  
389.

Road 389

In the matter of Viewing, surveying and laying out county road no. 389. commencing at a point about 24 rods west of the S & corner of the S.E. of Sec 12 Tp 4 NR 36 & Wm said point being what is known as D. Higgins gate on the sec line between sections 12 and 13 in Tp 4 NR 36 & Wm said gate being the first gate on said section line west of the S & corner of said S & Sec 12 thence running south easterly along the present traveled road until it intersects the the sec. line bet. Sec. 13 Tp 4 NR 36 & and Sec 18 Tp 4 NR 37 E. thence south to the SW cor of N<sup>2</sup> of NW<sup>4</sup> sec. 18 Tp 4 NR 37 & Wm thence east about 1/4 mile thence south about 5 rods thence southeasterly about 45 rods to intersect the west side of the S & Sec. 18 Tp 4 NR 37 & Wm thence south to the south side of Sec. 18 in Tp 4 NR 37 & Wm. thence east on said line about 157 rods thence S to a point about 5 rods south of the S & corner of Sec 18 Tp 4 NR 37 & Wm thence south about 1 mile and 30 rods to intersect the main traveled cold spring road thence easterly along the main traveled cold spring road until it intersects the Linnton road

Report of Viewers

To the Honorable County Court. of the state of Oregon, for Wasatch County.  
We the undersigned, the viewers heretofore appointed to view and locate Road no 389 submit the following report: Pursuant to an order of the Honorable Court we met John C. Arnold County Surveyor at St Millikin on May 31. 1892 and were by him, each, duly sworn to faithfully and impartially discharge the duties of our appointments.

We called to our aid  
 J. L. Hill }  
 Hardy Hamm } chainmen  
 W. F. Parks } marker  
 who were by the surveyor each duly sworn we viewed surveyed and located said road no. 389 as specified in our order. We find the road run through a settlement where there are no other roads the route is quite a practicable one. We would therefore recommend that the said road be declared a public highway  
 Witness our respective hands this 4<sup>th</sup> day of June A. D. 1892  
 Filed Jul 6. 1892  
 W. M. Pierce }  
 J. E. Walden } Viewers Road  
 Joseph Hastings } Survey No 389  
 Clerk

Field notes of Road Survey No 389 for Unadilla County Or  
 I met N. B. Davidson, Jno. E. Waldon and Jas. Hastings viewers on road survey No. 389. Unadilla County, Or. at Res. of H. Millikin June 1<sup>st</sup> 1892. We call to our aid Hardy E. Stamm and J. C. Hill to chain, and W. F. Parkes to mark. Each of the Viewers and assistants qualified as directed by law - after which under direction of the said Viewers, I proceed to survey Road No. 389, as described in the following

Field notes of Survey of Road 389. —

From Cor. to secs. 7-12-13-18 on line bet. ranges 36 + 37 East, in Township 4 north I measure along fence.

West.

10.00 <sup>ch</sup> S. Diggins gate Center; initial point in Road Survey 389.  
 10.38 A pine tree, 16 ins. dia. bears S. of fence, 10 lks. dist.  
 I cut R. 389 - O on S.E. for initial post, and from Center said gate, I run, thence S. 52° E.

11.75 Set angle post mkd ↑ at intersection of line bet ranges 36 + 37 E., 45 lks. west of Thos Serrano's fence, on E. side of lane, N + S. Thence, R. 52° on Range line, as represented below:—

Course	Dist.	Sum	Remarks
South	27.16		The 1/4 Sec. on W. body of N.W. 1/4 of Sec. 18, T. 4 S. R. 37 E.
East	50.69		Set angle post marked 2, at Cor.; thence on sub. sec. line, The Center Cor. Stone, to N.W. 1/4 of said Sec. 18. = O. R. 346
South	63.33	R. 61° 45'	Set angle post mkd 3, at Cor.; thence on sub. sec. line,
S 61° 45' E	62.37		" " " " 4
	80.00		Center of Ravine, runs S - Water - needs to culvert.
	56.5		Set 1 mile Post 45 links S. of line, in lane, N.W. + S.E.
South		R. 61° 00'	Int. N + S. Center line through Sec. 18.
S 32° 25' E.	34.00	R. 32° 25'	Set angle post mkd 5; thence along center Sec. 18.
	35.25		" " " " 6
East	41.17		Wire fence on E. side of lane.
	63.45		" " " " 7; Int. line bet. Secs. 18 + 19.
	66.00		along line bet. Secs. 18 + 19; H. Millikin's house bears north 71 lks. dist.
	70.00		First row of trees E. + W. in H. Millikin's orchard bears north 21 lks. dist.
	76.78		a school house bears N. about 150 lks. dist.
	79.70	R. 71° 53'	Set angle post mkd 8, West of Cor. to Secs. 17-18-19+20
S 18° 17' E		R. 18° 30'	75 links, on E. face of hill.
South			Set angle post. mkd. 9; Int. line bet Secs. 19 + 20
South	80.00		on line bet. Secs. 19 + 20
			Set 2 mile post. 45 links E. of line.

Course	Distance
	77.0
	80.
	7.
S 15° 55' E	21.5
	26.
S 6° 15' W	27.
	29.
	33.
S 42° 55' E	43.
S 52° 25' E	5.
S 40° 32' E	5.
S 19° 32' E	6.
S 51° 47' E	6.
S 68° 02' E	7.
S 68° 52' E	9.
S 31° 07' E	
S 58° 52' E	
S 39° 42' E	
N. 88° 18' E	
68° 30' E	
S 97° 14' E	
S 75° 44' E	
S 62° 34' E	
S 21° 43' E	
S 42° 53' E	
S 65° 63' E	
S 47° 41' E	
S 32° 26' E	
S 71° 36' E	
S 54° 46' E	
S 34° 53' E	2
S 21° 53' E	39
S 73° 13' E	53
	6
S 84° 13' E	8
S 45° 23' E	
S 63° 53' E	9
N. 81° 52' E	18
N. 72° 02' E	27
	40

of Om  
 Viewers  
 of St. Mil-  
 umm and  
 of the Viewers  
 rich un-  
 y Road No. 389,  
 East, in  
 Survey 389,  
 dist.  
 d from  
 angles  
 on E. side  
 mounted  
 37 E.  
 sub. sec. line,  
 S. = O. R 346  
 sub. sec. line,  
 culvert,  
 W. & S. E.  
 8.  
 over Sec. 18.  
 side of lane.  
 s. 18 + 19.  
 house  
 orchard  
 dist.  
 to Secs. 17-18-19-20.  
 Secs. 19 + 20

Course	Distance	Sum	Notes
	77.00		Cor. to Secs. 19-20-29-30, Int Road Survey 346
	80.0		Set 3 mile post 45 links E. of line.
S 75° 55' E	7.10	L. 75° 55'	Set angle post mkd. 10.
	21.07		Ravine water runy. course S. - 5' culvert needed.
S. 6° 15' W	26.96	R. 92° 10'	Set a. p. mkd. 11. Descend.
	27.90		Brook 4 lks. wide runs west.
	29.75		" 6 " " " "
S. 42° 55' E	33.10	L. 49° 10'	Set a. p. mkd. 12
S. 52° 25' E	43.90	L. 9° 30'	" " " 13, by fir stump 24 ins. dia.
S. 40° 32' E	57.70	R. 11° 55'	" " " 14
S. 78° 32' E	59.86	L. 38° 00'	" " " 15
S. 51° 47' E	64.08	R. 11° 45'	" " " 16 " " "
S. 68° 02' E	67.11	L. 16° 15'	" " " 17
S. 63° 52' E	71.27	R. 4° 10'	" " " 18
	80.00		A tamarack 4 ins. dia. bears S. 11 lks. dist. mkd. 4 m, for 4 mile post.
S. 37° 07' E	0.94	R. 26° 45'	Set a. p. mkd. 19
S. 53° 52' E	7.16	R. 16° 45'	" " " 20.
S. 39° 42' E	13.48	R. 14° 10'	" " " 21.
N. 83° 18' E	19.69	L. 57° 00'	" " " 22, 10 lks. S. of line.
" 68° 30' E	24.64	L. 14° 40'	" " " 23, Cut on stump, on line.
S. 87° 14' E	29.80	R. 24° 05'	" " " 24
S. 78° 44' E	35.68	R. 11° 30'	" " " 25
S. 62° 34' E	41.12	R. 13° 10'	" " " 26 15 lks. W. of line.
S. 21° 43' E	49.95	R. 40° 51'	" " " 27
S. 42° 53' E	54.10	L. 21° 10'	" " " 28
S. 66° 63' E	70.90	L. 24° 10'	" " " 29
S. 47° 41' E		R. 19° 22'	" " " 30
	80.00		Set 5 mile post 30 lks. North of line.
S. 32° 26' E	22.5	R. 15° 15'	" " " 31
S. 71° 36' E	72.5	L. 39° 10'	" " " 32, also cut 32 on S. side of stump 20 lks. North.
S. 54° 46' E	23.80	R. 16° 50'	" " on line " " 33 on fir tree 10 ins dia 22 " "
S. 34° 53' E	39.42	R. 19° 53'	" " " " " " 34 " stump 5 lks. north of line,
S. 21° 53' E	53.00	R. 13° 00'	" " " " " " 35 " fir 11 lks. East of line
S. 73° 13' E	69.75	L. 51° 20'	" " " " " " 36 " tamarack 26 dia. 1/2 lks. South.
	80.00		A fir tree 6 ins. dia. bears north 35 lks. dist.
S. 84° 13' E		L. 11° 00'	Marked VIM and 37 for 6 mile post.
			Drive a. p. on line.
S. 45° 23' E	9.90	R. 35° 50'	Set a. p. on line and 38 on fir 14" dia. 16 lks. N. of line
S. 63° 53' E	15.77	L. 18° 30'	" " " " " 39 " " 36 " 31 " " "
N. 87° 52' E	23.95	L. 26° 15'	Set a. p. on line and cut 40 on fir 24" dia. 11 lks. S.W. of line
N. 72° 02' E	40.87	L. 15° 50'	" " mkd. 41

Course	Dist	Sum	
S. 67° 05' E.	43.27	R. 40° 50'	" " on line " " 42 " fir 6" dia. 4 lks S. of line
S. 27° 51' E.	47.86	R. 39° 17'	" " mkd 43. Descend.
S. 41° 11' E.	52.60	S. 13° 20'	" " on line and cut 44 on fir 30" dia 4 lks. S. of line
	60.00		Foot of descent. - ascend
	65.00		Summit.
S. 9° 05' E.	71.50	R. 38° 06'	" " mkd 45
S. 12° 50' E.	74.40	S. 4° 45'	" " " " 46
S. 35° 45' E.	78.90	S. 25° 55'	" " on line and 47 on fir 16" dia. 6 lks. S. of line.
	80.38		a fir tree 30 ins. dia. bears S. 3 links distant,
	7.50		mkd 7 M. for 7 mile post
			ascend hill
N. 46° 00' E.	9.40	S. 98° 15'	Set a. p. on line and cut 48 on fir 18" dia. 12 lks. W. of line
S. 87° 00' E.	16.45	R. 47° 00'	" " " " " " 49 " Stump 9 lks. N. " "
S. 36° 55' E.	28.00	R. 48° 05'	" " " " " " 50 " " 24" dia. 9 lks. W. " "
S. 57° 10' E.	37.92	S. 20° 15'	Cut 51 on fir 60" dia. 2 lks S. of line (Snow 4' deep)
	40.00		Summit - Descend.
N. 70° 10' E.	46.92	S. 52° 40'	Set a. p. on line mkd. 52 (Council angle)
S. 82° 35' E.	58.56	R. 27° 15'	" " " " and cut 53 on fir 10" dia. 5 lks. S. of line.
N. 76° 00' E.	63.02	S. 20° 30'	" " " " mkd. 54
N. 59° 40' E.	75.03	S. 17° 15'	" " " " " " 55
	80.50		a. fir 8 ins. dia. bears E. of line 16 lks. distant.
			mkd. 8 M for 8 mile post
N. 77° 00' E.	11.59	R. 17° 20'	Set a. p. on line and cut 56 on fir 14" dia 11 lks. East.
N. 55° 30' E.	16.96	S. 21° 30'	" " " " " " 57 " " 24 " 4 " "
N. 28° 10' E.	31.61	S. 27° 20'	" " " " " " 58 " " 18 " 5 " West.
	36.50		Int. Sinkton mtn, road.
	36.83		a dead fir tree 6 ins. in dia. on line. mkd R 389 for Terminus of Road 389.

All the posts were of legal size, and marked and set in mounds, as required by law -  
 The survey follows, in general, a well defined traveled road throughout, running for the most part through thick timber.

I hereby certify that the foregoing are the correct field notes of Road Survey No. 389 for Umatilla County, Oregon.

Jno. C. Arnold, County Surveyor.  
 Filed July 13, 1892  
 W. M. Pierce  
 Clerk

366 372 4 M.

line  
 . of line  
 second  
 mt.

line  
 front,

W. of line.

N. " " "

W. " " "

4' strip  
 the S. of line.

divident.

Ma. East.

" " West.

2. mtid

mted and

defined

the cor-  
 - Unalilla

Surveyor.

368 372  $\perp$  N.

Initial Point of Road 389.

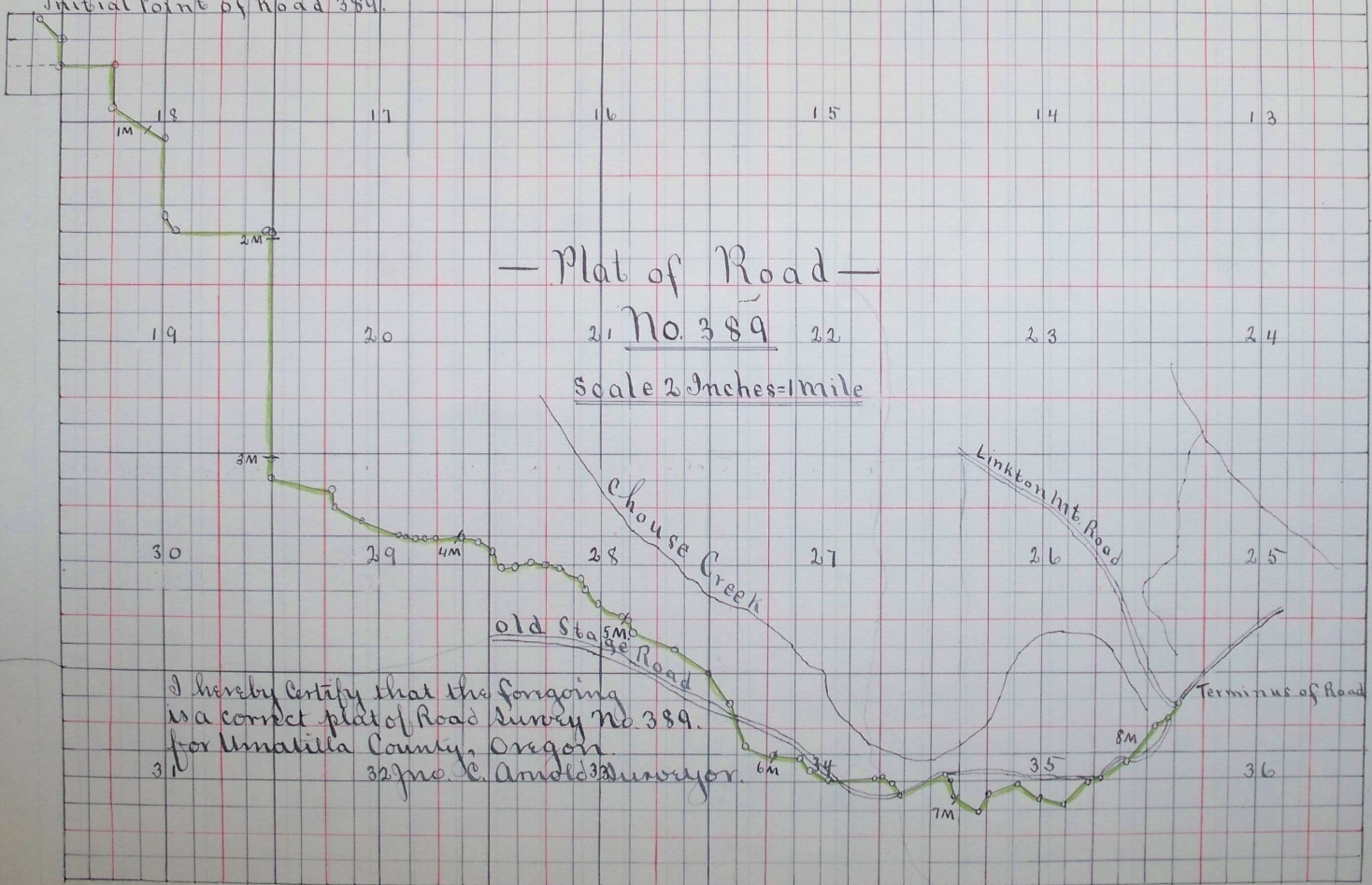

— Plat of Road —

21 No. 389 22

Scale 2 Inches = 1 Mile

Chouse Creek

old Stage Road

Linkton Int. Road

Terminus of Road

I hereby certify that the foregoing  
 is a correct plat of Road Survey No. 389.  
 for Unalilla County, Oregon.  
 32 Jno. C. Arnold Surveyor.

Filed July 13, 1892  
 Wm. Pierce  
 Clerk

221

Plat of Road Survey No 389