

Rd #99

Report of Viewers. Field Notes & Plat
of County Road from N.W. Cor Sec 36
T. 5. N. R. 35 E. to intersect Linkton Road

Rd #99

"Report of Viewers"

To the Honorable County Court of Umatilla County
and State of Oregon

We the undersigned viewers appointed by your honorable
body to view survey and lay out a county Road
as petitioned for by Geo Sutton and others viz

commencing at the N.W. corner of sec 36 T. 5. N. R. 35 E. and
ending at intersection with Linkton Road. met at the
time and place as directed by your honorable body
and having been qualified by J. B. Arnold surveyor
took to our assistance Alonza Bartlett and Larkin Dippo
as chain bearers and C. C. Grammer as marker.

proceeded to the discharge of our duty as directed and
having finished the same we are of opinion that said
proposed Road should be made a county Road for
the reasons that the location of said Road is a good one
and a county Road is greatly needed there as there is
no county Road in a portion of the settlement through
which it passes

this 24th July 1880

Yours Truly
James Royce
Wm. B. Steen
Lewis Bowler

"Field Notes"

- Set initial post at N.W. Cor of Sec 36 T. 5. N. R. 35 E.
- E. 80^{ch sk} along Webb Harris fence. set 1 m in Webb Harris lane
- " 3.50 set angle stake on hill N of Webb Harris Res
- S. 21° E. 20.50^{ch sk} set a s on West bank of house creek
- S. 54° E. 28.50 across house creek. set a s. at turn in lane E side of creek
- S. 73° 30' E. 58^{ch} along lane set a s in lane E of Barns Res
- S. 49° E. 66.50 " " " " " " " " " "
- S. 62° 30' E. 80 " " " 2 m " " " " " "
- " H set a s near school house on creek
- S. 49° 30' E. 40 along N hill side set a s on hill side
- S. 58° E. 49.50 up ravine around hill set a s. E. of trav road
- " 70.50 up first gulch set a s on N of gulch near fence
- N. 27° E. 80 up gulch set 3 m at turn of lane near J. Gordons Res

- Rd #99
- N 27° E ^{ch 21} 1 50 across gulch set a s near fence
- S 76° E 10 up gulch set a s-E of trav Road
- S 51° " 19 50 " " " " near Wemeris Rec. E. of trav Road
- S 87° " 62 " " " " at Summit
- S 89° " 80 set 4 lbs.
- " " 7 " a s. west of ravine
- S 72° 30' E 14.50 " " E of Gulch
- S 55° E 26.50 along trav Road set a s. w. of trav Road
- S 85° 30' E 36 up ravine set a s. on S hill side W of Jos. Suttons Res
- N 78° 30' E 43 set a s at Jos Suttons Res
- N 35° E 53 " " on hill W of Jos Suttons Res
- N 88° 30' " 80 up hill set 5 m on hill side W of fence
- " " 13 set a s W of Barton
- S 57° " 28 " " head of canon W of trav Road
- N 64° 30' " 44.50 " " on W hill side
- S 89° " 80 over hill set 6 m on Koskel Ridge
- " " 11 set a s W of trav Road
- N 70° " 24 along ridge set a s W of trav road
- S 37° " 33.50 up hill set a s W of canon
- S 69° 30' " 66 along fence out set a s. on S side of trav road
- N 78° " 80 over hill set 7 m on summit
- S 86° " 18 across hollow and along S hill side set a s on ridge
- N 35° " 37.50 set terminus Pat intersection with Linton Road
- whole distance 7 m 150 R

The posts and stakes were all marked and mounded according to law. and the road well marked by travel

Jno. B. Arnold Surveyor
 G. B. Brammer marker
 Alongo, Bartlett }
 Larkin Phipps } chainmen

Rd #99

mark

"

"

"

"

"

"

"

"

"

"

"

"

"

"

"

"

"

"

"

"

"

"

"

"

"

"

"

"

"

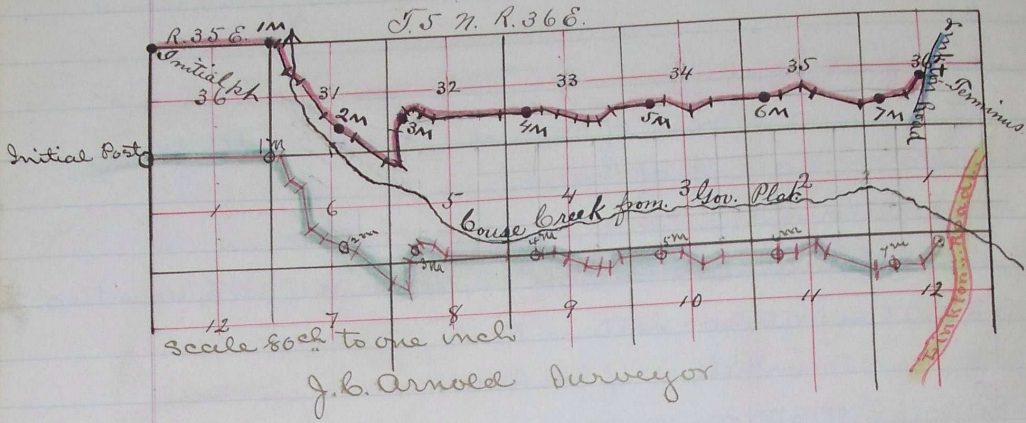

Plat of bounty Road from S W cor of Sec 36
 T. 5 N. R. 35 E. to intersect Linton Road
 Journal 7 547
 " " 600
 " E. 64

Note The correct Plat above is marked in red.