

ROAD No
383.

Report of Viewers, Field notes and Plat of Survey of
Road No 383, in Umatilla County, Oregon.

Commencing at the mouth of Gordon Gulch, about
200 yards south east of the north west corner of Sec 5
Township 4 N. Range 36 E W M. thence running easterly
up Gouse Creek about 2 1/2 miles to James Kitch's place
thence crossing said Gouse Creek and following up the
Berry Gulch in a southeasterly direction about 2 miles
to the head of the gulch, thence southerly along the line
between Berry Reed and John Kerst about 80 rods
intersecting the Basket Mountain road at the South
west corner of the north half of the north east quarter
of Sec 14 Town 4 N. Range 36 E W M.
Said Road to be forty feet wide.

In the matter of viewing, surveying and laying out County Road No 383.
To the Honorable County Court of the State of Oregon, for Umatilla County,

We, the undersigned, the viewers heretofore appointed to
view and locate Road No. 383, submit the following report;
Pursuant to an order of the Honorable Court we met Jno.
C. Arnold, Surveyor, at Milton on Feb. 26, 1892 and were
by him, each duly sworn to faithfully and impartially
discharge the duties of our appointments.

We called to our aid Edgar R. Thomson } Chairman
Jacob C. Keill }
Same parties Marker.

who were by the Surveyor, each duly sworn, We viewed,
surveyed and located said road NO 383 as specified
in our order. We find the route practicable and
very much needed as an outlet for the settlers along
the vicinity we would therefore recommend that said
road become a public highway.

Witness our respective hands 27 day of Feb. 1892.

George Dehaven }
Wm. Frasier } Viewers, Road Survey No 383.
A. M. Elam }

Filed Mar. 11, 1892
W. M. Pierce Clerk.

Field
view
oath
char
9
Cous
cor. of
and
trans
550-45
542-00
556-18
550-13
556-23
572-4
578-5
565-5
576-0
562-5
788-14
773-2
782-39
765-5
761-19
736-00
9
773-4
754-5
733-36
757-4
771-34
755-34
761-19
520-4
55-5
537-0
548-31
548-31
552-1

Field Notes of Road Survey No 383 for Umatilla County, Oregon.

I meet Geo. Dehaven, Henry Frasier and A. M. Elam, viewers on County Road No 383 and duly administered oath to each. We call E. R. Thomson and J. C. Hill to chain and mark, each of whom was duly sworn.

I set initial post below traveled road on N. side of loose creek, at mouth of Gordon Gulch, 5 + 8 lks S.E. of NW cor. of sec. 5 in 2 + NR. 36 E, in mid. of stone 2 ft. h x 4 ft. base, and from initial post I run, on Magnetic course, along traveled road.

550°-45'E	18.42	Set angle post 1-30 lks north of line; thence along traveled road.
542°-08'E	29.53	" " " 2 " " " " " " " " " "
556°-18'E	37.32	" " " 3 " " " " " " " " " "
550°-13'E	44.59	" " " 4 " " " " " " " " " "
556°-23'E	61.50	" " " 5 " " " " " " " " " "
572°-48'E	74.12	Thom bush " " " 6-20 " " " " a thorn bush 2 ins. dia.
578°-56'E	79.75	" " " 7-30 " " " " thence along traveled road.
565°-58'E	80.00	" 1 mile post 30 " " " " " " " " " "
	10.40	Set angle post 8-25 lks N of line - but A on post in fence.
576°-05'E	18.50	" " " 9-5 " " " " " " " " " "
562°-51'E	22.70	" " " 10-30 " " " " " " " " " "
7188°-14'E	28.23	" " " 11-15 " " " " " " " " " "
7173°-29'E	37.93	" " " 12-22 " " " " " " " " " "
7182°-39'E	42.46	" " " 13 on line " " " " " " " " " "
7165°-54'E	48.62	" " " 14-5 lks N of line
7161°-19'E	67.61	" " " 15-8 " " " " moved A on W end of sawd piece of timber 1 1/4 x 1 3/4 long (Mr. Winns).
7136°-02'E	73.96	" 2 mile post 30 " " " " " " " " " "
	2.28	" Angle post 17-30 lks N of line; thence along traveled road.
7173°-47'E	5.16	" " " 18 " " " " " " " " " "
7154°-56'E	9.20	" " " 19 " " " " " " " " " "
7133°-36'E	11.00	" " " 20 " " " " " " " " " "
7157°-44'E	14.85	" " " 21 " " " " " " " " " "
7178°-34'E	25.16	" " " 22 " " " " " " " " " "
7155°-34'E	45.75	" " " 23 " " " " " " " " " "
7181°-19'E	50.90	" " " 24 " " " " " " " " " "
520°-41'E	51.65	Center of loose creek, 30 lks wide, course N 87°-30' W.
	59.80	Set Angle post 25-30 lks E of line; thence along road up Berry Gulch.
55°-54' W	61.70	" " " 26 " " " " " " " " " "
537°-01'E	74.35	" " " 27 " " W " " " " " " " "
548°-31'E	75.90	Branch 5 lks. wide, in gulch.
546°-31'E	80.00	Set 3 mile post E of line 30 lks.
	2.35	Set angle post 28, E of line 30 lks; thence along traveled road.
554°-16'E	8.00	Branch 5 lks wide in gulch; ascend steep hill.

of
 about
 e 5
 easterly
 place
 up the
 2 miles
 the line
 odes
 south-
 arter

 83.
 J.
 to
 post;
 at Jno.
 were
 ly

 rived
 id
 and
 ong
 said

	12.55	Set angle post 29 E of line 30 lks; thence along traveled road,
S 49°-26' E	21.30	" " " 30 " " " " " " " " " "
S 84°-26' E	27.30	" " " 31 " " " " " a steep bluff bears E 5 lks. dist. and John Scotts Well in gulch, bears west 20 lks. dist.
S 12°-56' E	31.70	Set angle post 32 E of line 30 lks. in gulch.
S 24°-09' E	37.62	" " " 33 " " " " " thence along traveled road.
S 22°-32' E	49.00	Center of branch in gulch - thence up the gulch.
	55.00	Leave gulch, and run along hill side E of gulch
	71.25	Set angle post 34 E of line 30 lks
S 21°-19' E	77.50	" " " 35 " " " " " "
S 86°-54' E	80.00	" 4 mile post.
	5.30	Set angle post 36 E of line 30 lks, bet. A.C. Jones barn & house, thence along E side of gulch.
S 32°-04' E	12.55	Set angle post 37 E of line 30 lks; thence across to W side of gulch.
S 18°-54' E	13.55	Stream in gulch, course NW. - Spring bears west about 100 lks.
	18.65	Set angle post 38 E of line 30 lks, by traveled road, thence
S 58°-26' E	28.70	" " " 39 " " " " " " " "
S 43°-45' E	39.00	" " " 40 W " " " " " "
S 36°-15' E	43.66	" " " 41 E " " " " " leave gulch "
S 21°-25' E	53.25	" " " 42 " " " " " thence on line through center Sec.
South	65.00	Summit
	67.00	Int. wagon road on Baskett Mountain. Set terminus on line.

All the posts are of proper size and marked and set in mounds according to law; the road follows the old traveled road from the beginning to Mouth of Berry Gulch, thence up said gulch, intersecting line N+S through Sec 14 at 4 miles 53 1/4 chains; thence south on this center Sec line to its terminus.

The original surveys in this vicinity have been quite carelessly made, and while the courses and distances given in these notes may not intersect subdivisional lines at true points, the road is well marked by angle and mile posts and by its being the only place for a road in the vicinity thereof.

God saved the viewers all work, except locating angles & miles, by laying out Road 383 himself.

I hereby certify that the foregoing are the true field notes to Road Survey 383, for Multnomah County, Oregon.

Jno. C. Arnold
Surveyor.

Filed Mar 12 1892
W.M. Brier Clerk.

The or
poorly
connect
road 383
from it
course to
of course
SE. This
stream
course of
383 that
get out
The
Survey
Filed

Plot of Road Survey No 383,

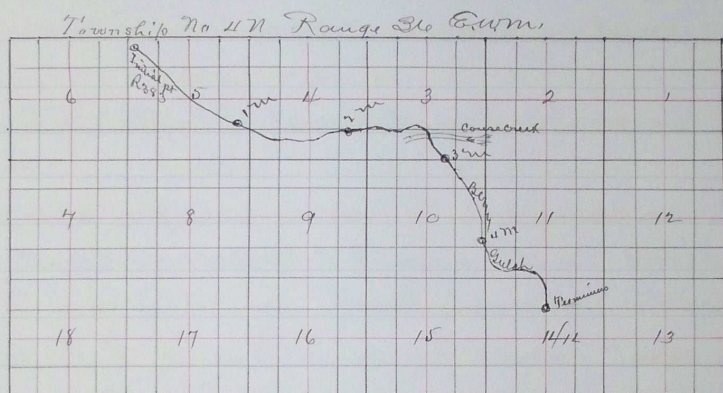

The original surveys in this part of the Township have been poorly made and this may throw the platting out of proper connection with some of the lines of original surveying. The said road 383 however is well marked with angle and mile stakes and from its beginning at the mouth of Gordon Gulch on N side of Course Creek, the road is located upon the old traveled road north of Course Creek until it reaches Berry Gulch coming in from the SE, thence the road crosses Course Creek and up Berry Gulch whence it can not be mistaken even were there no other marks, for the great cause of all things has so build up the ground in the vicinity of Road 383 that, once in it, it would be a very difficult affair indeed to get out of it.

I hereby certify that the foregoing is as correct a plot of Road Survey No 383 as the average of common mortality can make

Jno L. Arnold 1st Suror

Filed March 12, 1892

Wm. Pierce Clerk

1892