

Report Survey and Plat of Road from Linkton road near Lawrence

Rd 431

Deal Road

Report of viewers to the County Court
of Yamhill County Ogn

In accordance with your instructions given at
your July term we proceeded July 19 1873 in company
with C Moorhouse Surveyor and J W Lawrence & - Hartness
chain carriers to locate the road commencing at the Linkton
road near the residence of J W Lawrence thence to the Deal
road leading to the Blue Mountains We believe that the es-
tablishment of such road will be of great public utility as a
great number will be accomodated by the location we therefore
recommend its establishment. This 26th August 1873

Geo Rees }
J W Sargman } viewers

Yamhill County State of Oregon
Aug. 18th 1873

I hereby certify that on the 19th day of July 1873 I
surveyed and caused posts properly marked to be planted
and in conformity with the Statutes of the State of
Oregon, the County road commencing near the res-
idence of James Lawrence on the Linkton road and
intersecting the Deal road heading to Blue Mountains
Seander Moorhouse

Surveyor

Field Notes of the Survey of a County road from
the Linkton road near the residence of J. W. Lawrence to the Deal
Road. Survey commenced July 19th and completed July 19th 1873

James W Lawrence and - Hartness sworn chainmen

Beginning at a post set in the Linkton road near the residence
of J W Lawrence, said post bearing S. 26° W. and 15 chains distant
from the post set at the commencement of the change of County road
made this day. Thence according to the following courses and
distances viz.

chains 5.67° 15' E variation 21° E
22.00 O. W. Hartness house 2.50 chains right of line -

(over)

Field Notes (Continued)

Chains
 RH#31 49.00 Thence South $69^{\circ}45' E$
 7.50 C. Sakeley's house right S $37^{\circ} N$ distant 3 chains, Thence S $37^{\circ}45' E$
 22.50 Set a post marked R. 1 M on the South side of the road and
 near the Section line between Sections 11^{and} 14 T^{is} N R 36 E Thence S $46^{\circ} E$
 13.00 J. M. Willards house 25 links right of line
 2.00 Thence S $41^{\circ}15' E$ - var $21^{\circ} E$
 13.00 " S $56^{\circ}45' E$
 4.00 " S $68^{\circ}10' E$
 2.50 " S $59^{\circ} E$
 26.00 " S $80^{\circ}30' E$
 6.00 " S $68^{\circ}45' E$
 1.50 Set a post marked R 2 M Thence on the above course
 10.00 Thence N $59^{\circ}30' E$
 10.15 " N $57^{\circ} E$ var $21^{\circ} E$
 7.75 " N $37^{\circ}30' E$
 6.50 " N $28^{\circ}30' E$
 7.95 " N $73^{\circ}30' E$ house of J Wood Run S $87^{\circ} E$
 4.35 " S $87^{\circ} E$ house of J Wood Run S $45^{\circ} N$
 7.40 " N $88^{\circ}15' E$
 6.30 " N $66^{\circ} E$
 4.10 Cross Range line between Ranges 36 & 37 and between Sections 13 & 18
 Townships North
 15.70 House of W. Osborn, 50 chains right of line Thence N $71^{\circ} E$
 3.10 Set a post marked R. 3 M Thence on the above course -
 6.00 Thence N $53^{\circ}15' E$
 19.20 " N $16^{\circ}45' E$ var $21^{\circ} E$
 5.60 Intersect a County road to the mountains and having no field notes
 of the same therefore run according to the following courses as
 near the traveled road as practicable S $83^{\circ}30' E$
 3.15 mound and stake (not marked) neither trench or pits - supposed
 quarter section corner between sections 7^{and} 18 S^{is} it Range 37 E
 Thence S $57\frac{1}{2}^{\circ} E$
 17.20 " S $54^{\circ}30' E$
 21.30 " N $83^{\circ} E$
 8.70 Set post marked R. 4 M
 Thence on the above course
 17.00 " N $57^{\circ}30' E$
 22.30 " N $33^{\circ} E$
 19.75 " N $43^{\circ}15' E$
 12.70 " N $87^{\circ} E$
 7.50 Set a post marked R 5 M
 Thence on the above course
 1.05 " S $59^{\circ} E$
 21.50 Intersect the Feil road - set a post marked R 5 M - 25 chs -
 for closing point of survey. Saturday July 19 - 1873

I hereby certify that the foregoing is a correct
 copy of the original field notes of the survey of
 the County Road commencing near the residence of
 James Lawrence on the Clinton road and inter-
 secting the Feil road leading to Blue mountains
 Lawrence's Mill house
 Surveyor

(Plate page 56 & 57)

Report, Survey and Plat
of
Change in Linkton Road

RC #31

Report of Viewers

To the County Court of Yamhill Co Oregon

We proceeded July the 19th 1873 in accordance with your order at the July term and in accordance with the Laws of Oregon to view the proposed change in the Linkton road near the residence of J. W. Lawrence. We believe that such change will be no detriment to the traveling public as the road is some shortened and the grade is but little increased by the change we therefore recommend its adoption This the 26th Aug 1873

Geo Rees
Willes Osborne } viewers

Yamhill County State of Oregon August 18th 1873

I hereby certify that on the 19th day of July 1873, I surveyed and caused posts properly marked to be planted and in conformity with the Statutes of the State of Oregon changed the County road near the residence of J. W. Lawrence.

Charles Moorhouse
Surveyor

Field notes of the Survey to change the County road near the residence of J. W. Lawrence

Beginning at a post set in the center of the Linkton or County road and on the division line between the claims of J. W. Lawrence and O. W. Hartness

Thence according to the following courses and distances viz.

Chains
24.80
13.70
2.00
18.67
21.58

South on the above division line variation 21° E
Thence S 28° 30' E var 21° 15' E
Point from which the corner for Sections 10, 11, 14 & 15 35th NR 36E
Runs N 67° 15' E distant 14⁴⁷ chis Thence South
Sungid divide between the Mulla Mulla and Birch creek - descend
Thence S 19° 45' E
Intersect Linkton road, Bears North to Mulla Mulla and S 22° 35' W
to Grand Round.

Survey commenced and completed Saturday July 19th 1873 James Lawrence and Hartness sworn chainmen.

I hereby certify that the foregoing is a correct copy of the original field notes of the survey to change

Plot of County Road (continued)
from Cuckoo Road to Peel Road
Township 5 S. R. 37 E. 4th m.

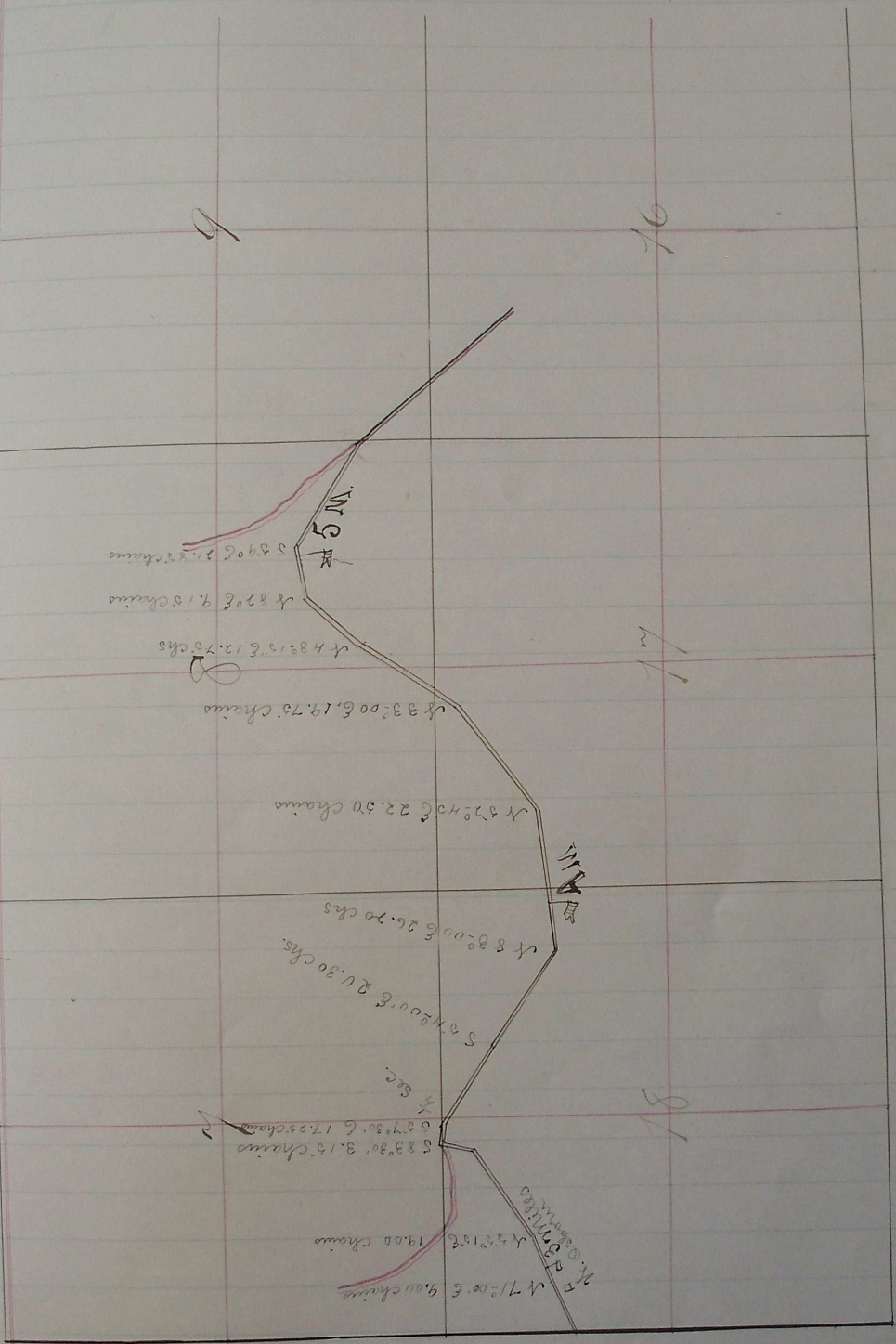

Roads granted and located Sept. 4th 1873
See, Co. Court Journal "B" page 359